

# Electronic Overload Expansion Module Product Installation

Figure 1.

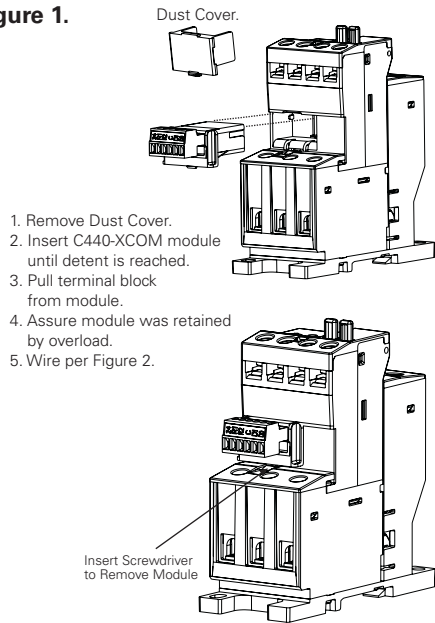
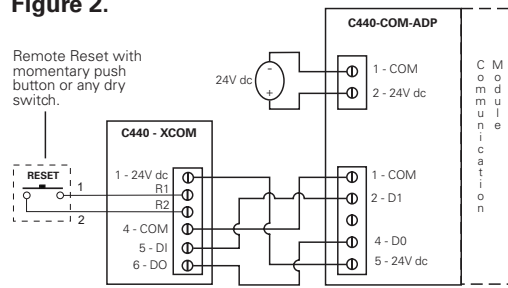

Figure 2.



FOR USE WITH C440-COM-ADP  
Consult IL04210006E

Remote reset wire length is governed by satisfying Type-1 24V dc input requirements per IEC 61131-2.

Table 1. Modbus Settings

Parameter	Value
Mode	Slave Mode Only
Modbus Address/Slave Address	Network Settable, Default = 1 (0 = for broadcast)
Baud Rate	19.2kb
Byte Characteristics	8-bit, Even Parity, 1-Stop Bit
Commands Supported	0x03 – Read Holding Registers 0x04 – Read Input Registers 0x06 – Write Single Register 0x10 – Write Multiple Holding Registers 0x2B/0x0E - Read Device Identification
Protocol Supported	Modbus RTU
Electrical Signaling	RS-485 (ANSI/TIA/EIA-485), Two Wire
Checksum	CRC16bit 0x8005 (or CRC-CCITT 0x1021)
Max. Number of Devices	32 (1 unit load per RS-485) Note: Line polarization will reduce max. # of devices by 4
Max. Cable Length	Dependent on Baud Rate, cable characteristics, number of loads. Reference Modbus-IDA over Serial Line Specification and Implementation Guide and EIA-485 for details

Table 2. Wiring Configuration

Pin #		Description
1	24Vdc	24V dc power supply connection
2	R1	Remote Reset Dry Contact Source. This is a 24VDC signal to be applied to a dry contact (ie pushbutton).
3	R2	Remote Reset Dry Contact Input
4	GND	Common or Ground power supply connection
5	D1	RS485
6	D0	RS485

Figure 3. Modbus Wiring Configuration

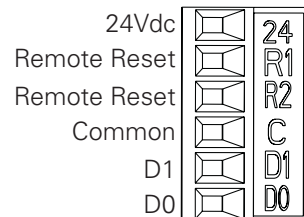

Powering Business Worldwide

**Table 3. Environmental Ratings of the Module**

Transportation and Storage	Temperature	-40°C to 85°C (-40°F to 185°F)
	Humidity	5-95% non-condensing
	Shock IEC 60068-2-27	15G
Operating	Temperature	-25°C to 65°C (-13°F to 149°F)
	Humidity	5-95% non-condensing
	Altitude	Above 2000 meters (6600 feet) Consult FACTORY
	Vibration IEC-60068-2-6	3G
	Polution Degree	3

**Table 4. Approvals/Certifications**

Agency Certifications	UL508 CUL (CSA C22.2 No. 14) CE (Low Voltage Directive)	
-----------------------	---	---

**Table 5. Module Electrical Requirements**

Voltage Range	18 - 30 V dc
Current Draw	Approx. 100 mA

**Notes:**

For use with Eaton UL Listed Power Supply Catalog Numbers, PSS55A, PSS55B, PSS55C, or PS160E.

Any UL Listed isolated power supply with a maximum of 30Vdc out may be used, provided that a UL Listed or Recognized Fuse rated at no more than 3A maximum be installed.

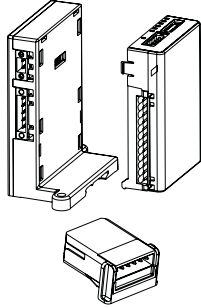
Communication Kits	Catalog No.	
Device Net Com module kit - 120V ac I/O	C440-DN-120	
Device Net Com module kit - 24V dc I/O	C440-DN-24	
Profibus Com module kit - 120V ac I/O	C440-DP-120	
Profibus Com module kit - 24V dc I/O	C440-DP-24	
Modbus Com module kit - 120V ac I/O	C440-MOD-120	
Modbus Com module kit - 24V dc I/O	C440-MOD-24	
Ethernet IP Com module kit - 120V ac I/O	Not Available	

**Eaton Corporation**  
Electrical Sector  
1000 Cherrington Parkway  
Moon Township, PA 15108  
United States  
877-ETN-CARE (877-386-2273)  
Eaton.com

© 2008 Eaton Corporation  
All Rights Reserved  
Publication No. IL04210003E  
July 2010 Rev.002