

BPAK BLANK ADAPTOR PLATE

BUL10042

REV. B

ASSEMBLY INSTRUCTIONS FOR BPAK UNIVERSAL DISCONNECT

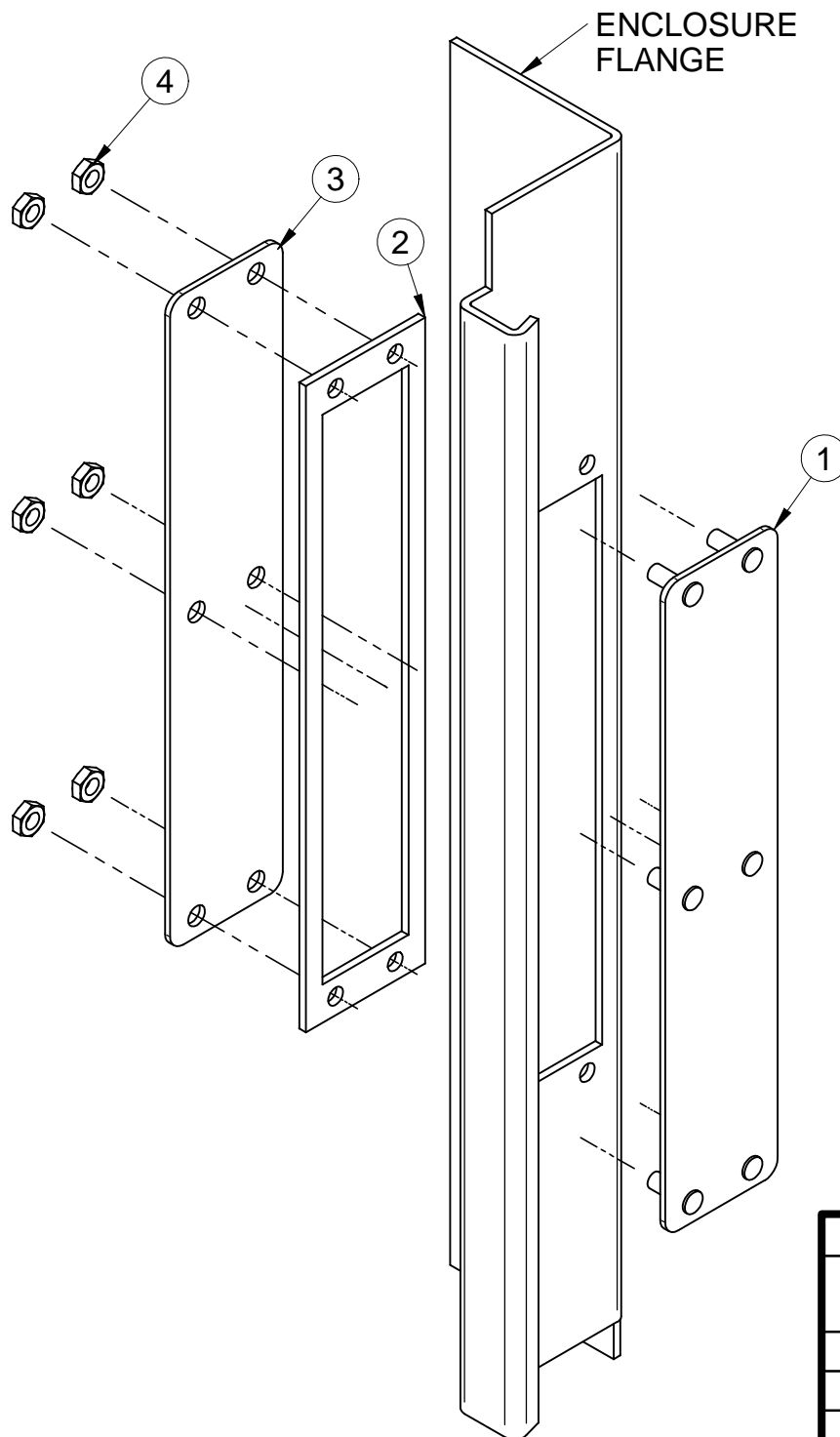

ASSEMBLY SEQUENCE

1. INSERT FRONT PLATE WITH 1/4 - 20 STUDS INTO DISCONNECT OPENING ON OUTSIDE FLANGE.
2. PLACE GASKET PLATE OVER STUDS ON INSIDE OF DISCONNECT OPENING. GASKET MUST PRESS AGAINST ENCLOSURE.
3. PLACE BACK PLATE OVER STUDS INSIDE.
4. TIGHTEN DOWN WITH 1/4 - 20 HEX NUTS ON STUDS.

	PARTS LIST	QTY.
1	FRONT PLATE C/W 1/4 - 20 STUDS (6)	1
2	GASKET PLATE	1
3	BACK PLATE	1
4	1/4 - 20 HEX NUT	6

TOOL BOX



7/16 Open End
Wrench



HAMMOND
MANUFACTURING™
ENCLOSURES