

# UHD AND UHDM SERIES

BUL10107

REV. E

## INSTALLATION PROCEDURE ALLEN BRADLEY 1494F SERIES B DISCONNECTS AND 1494D OPERATORS FOR CIRCUIT BREAKERS USE ADAPTOR AK1494FD

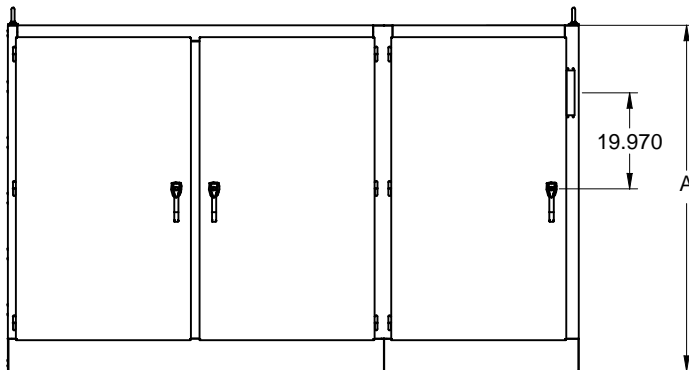

UHD SERIES - 3 OR 4 OR 5 DOOR ENCLOSURES

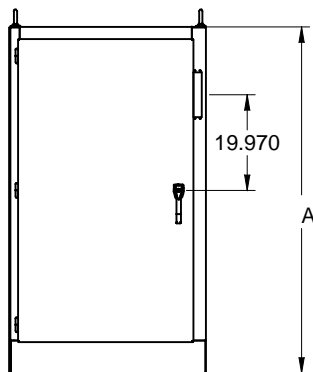

UHD AND UHDM SERIES 1 OR 2 DOOR ENCLOSURES

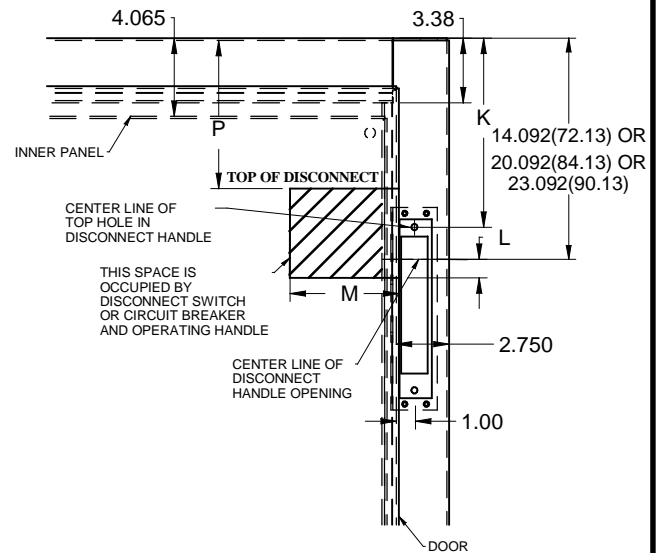

\*HIDDEN FROM VIEW\*  
FLANGE OPERATOR  
SCREW WITH  
NYLON BUSHING  
(BUSHING PROVIDED)

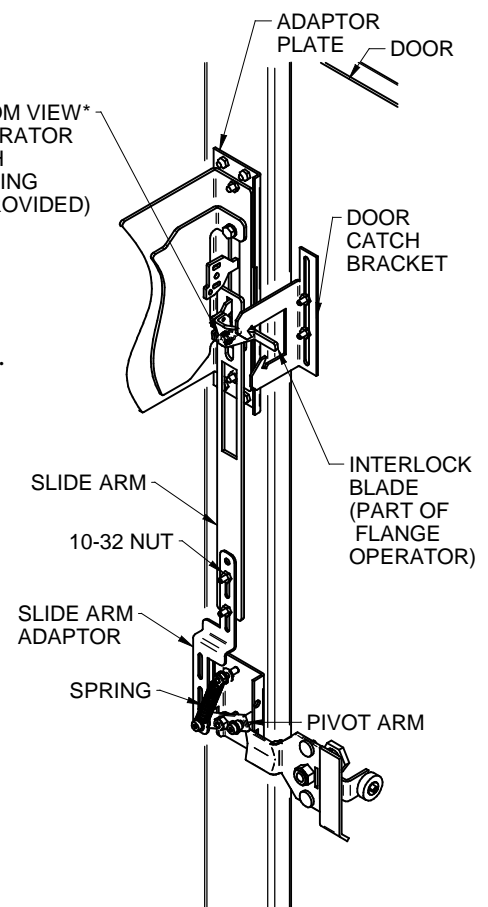

### ASSEMBLY INSTRUCTIONS

- (A) BOLT ADAPTOR PLATE TO INSIDE FLANGE OF ENCLOSURE WITH GASKET AND SCREWS PROVIDED.
- (B) BOLT THE FLANGE OPERATOR TO THE ADAPTOR PLATE USING THE HARDWARE PROVIDED WITH THE OPERATOR.
- (C) REMOVE INTERLOCK BLADE AND BOTTOM SCREW OF THE OPERATOR HANDLE. INSTALL SLIDE ARM OVER THE BOTTOM ACTUATOR BRACKET ON OPERATOR HANDLE USING THE RECTANGULAR CUTOUT, RE-INSTALL BOTTOM SCREW WITH NYLON BUSHING THROUGH THE ROUNDED SLOT. RE-INSTALL THE INTERLOCK BLADE.
- (D) REMOVE SHOULDER SCREW ATTACHED TO THE SPRING ON THE PIVOT ARM. INSTALL SLIDE ARM ADAPTOR ONTO SLIDE ARM STUDS AND LOOSELY INSTALL 10-32 NUTS. ATTACH OTHER END OF SLIDE ARM ADAPTOR TO THE PIVOT ARM USING THE SHOULDER SCREW. MAKE SURE SPRING IS RE-INSTALLED.
- (E) ADJUST THE SLIDE ARM TO THE CORRECT POSITION FOR INTERLOCK TO FUNCTION PROPERLY. WITH THE DOOR OPEN AND THE OPERATOR HANDLE SWITCH OFF, REST THE SLIDE ARM ON THE BOTTOM ACTUATOR BRACKET OF THE OPERATOR HANDLE. TIGHTEN 10-32 NUTS TO LOCK IN PLACE.
- (F) ADJUST INTERLOCK DOOR CATCH BRACKET SO IT CATCHES ON THE INTERLOCK BLADE ONLY WHEN THE FLANGE OPERATOR IS IN THE "ON" POSITION. THIS IS TO PREVENT THE DOOR FROM OPENING WHEN POWER IS ON.
- (G) INSTALL FUSE BLOCK OR DISCONNECT PER MANUFACTURER'S INSTRUCTIONS.

#### TOOL BOX



11/32, 3/8 or 7/16  
Socket Wrench



1/8 ALLEN KEY

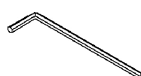

1/4 Slot Head  
Screw Driver



**HAMMOND  
MANUFACTURING™  
ENCLOSURES**

**INSTALLATION PROCEDURE FOR ALLEN BRADLEY 1494F  
DISCONNECTS AND 1494D OPERATORS FOR CIRCUIT BREAKERS USE  
ADAPTOR AK1494FD**

**BUL10107**  
REV. E

ALLEN-BRADLEY BULLETIN 1494F DISCONNECT SWITCHES							WIRE BEND SPACE ABOVE DISCONNECT					
ENCLOSURE HEIGHT	FITS 72.13	FITS 84.13	FITS 90.13	ALLEN- BRADLEY TYPE NO.	AMP RATING	FUSE CLIP	FUSE CLASS	SPACE OCCUPIED		WHEN	WHEN	WHEN
								L	M(1)	A=72.13 P	A=84.13 P	A=90.13 P
*	*	*	*	N30	30A	NO-FUSE	-	4.62	6.50	9.31	15.31	18.31
*	*	*	*	NF30	30A	30A-250V	H,K,R	6.50	6.50	9.31	15.31	18.31
*	*	*	*	NF30	30A	60A-250V	H,K,R	7.25	6.50	9.31	15.31	18.31
*	*	*	*	NF30	30A	30A-600V	H,K,R	9.25	6.50	9.31	15.31	18.31
*	*	*	*	NF30	30A	60A-600V	H,K,R	9.75	6.50	9.31	15.31	18.31
*	*	*	*	NF30	30A	30A-600V	J	6.50	6.50	9.31	15.31	18.31
*	*	*	*	NF30	30A	60A-600V	J	6.62	6.50	9.31	15.31	18.31
*	*	*	*	N60	60A	NO-FUSE	-	4.62	6.50	8.62	14.62	17.62
*	*	*	*	NF60	60A	30A-600V	H,K,R	10.38	6.50	8.62	14.62	17.62
*	*	*	*	NF60	60A	60A-250V	H,K,R	8.38	6.50	8.62	14.62	17.62
*	*	*	*	NF60	60A	100A-250V	H,K,R	10.88	6.50	8.62	14.62	17.62
*	*	*	*	NF60	60A	60A-600V	H,K,R	10.88	6.50	8.62	14.62	17.62
*	*	*	*	NF60	60A	100A-600V	H,K,R	12.88	6.62	8.62	14.62	17.62
*	*	*	*	NF60	60A	60A-600V	J	7.75	6.50	8.62	14.62	17.62
*	*	*	*	NF60	60A	100A-600V	J	9.75	6.50	8.62	14.62	17.62
*	*	*	*	N100	100A	NO-FUSE	-	4.62	7.25	6.75	12.75	15.75
*	*	*	*	NF100	100A	100A-250V	H,K,R	11.38	7.38	6.75	12.75	15.75
*	*	*	*	NF100	100A	200A-250V	H,K,R	12.25	7.62	6.75	12.72	15.75
*	*	*	*	NF100	100A	100A-600V	H,K,R	13.38	7.50	6.75	12.75	15.75
*	*	*	*	NF100	100A	200A-600V	H,K,R	14.75	7.75	6.75	12.75	15.75
*	*	*	*	NF100	100A	100A-600V	J	10.12	7.38	6.75	12.75	15.75
*	*	*	*	NF100	100A	200A-600V	J	10.88	7.50	6.75	12.75	15.75
*	*	*	*	N200	200A	NO-FUSE	-	7.12	10.38	5.12	11.12	14.12
*	*	*	*	NF200	200A	200A-250V	H,K,R	15.00	10.38	5.12	11.12	14.12
*	*	*	*	NF200	200A	400A-250V	H,K,R	16.56	10.75	5.12	11.12	14.12
*	*	*	*	NF200	200A	200A-600V	H,K,R	17.56	10.38	5.12	11.12	14.12
*	*	*	*	NF200	200A	400A-600V	H,K,R	19.56	11.00	5.12	11.12	14.12
*	*	*	*	NF200	200A	200A-600V	J	13.69	10.38	5.12	11.12	14.12
*	*	*	*	NF200	200A	400A-600V	J	15.00	10.62	5.12	11.12	14.12

1. THE "M" DIMENSIONS DO NOT INCLUDE SPACE FOR AUXILIARY SWITCHES. SEE ALLEN-BRADLEY INSTRUCTIONS FOR ADDITIONAL SPACE REQUIRED.

ALLEN-BRADLEY BULLETIN 1494D OPERATORS FOR CIRCUIT BREAKERS							WIRE BEND SPACE ABOVE CIRCUIT BREAKER				
ENCLOSURE HEIGHT	FITS 72.13	FITS 84.13	FITS 90.13	ALLEN BRADLEY TYP NO.	AMP RATING	CIRCUIT BREAKER TYPE FRAME SIZE	SPACE OCCUPIED		WHEN	WHEN	WHEN
							L	M(1)	A=72.13 P	A=84.13 P	A=90.13 P
*	*	*	*	N4/N40	150A	C-H WESTINGHOUSE EHD, FD,FDB,FDC,HFD,HMCP	5.81	4.56	9.25	15.25	18.25
*	*	*	*	N5/N50	250A	C-H WESTINGHOUSE JD, JDB,JDC,HJD,HMCP	8.81	4.75	8.44	14.44	17.44
*	*	*	*	N5/N60	400A	C-H WESTINGHOUSE KD, KDB,DK,HKD,HMCP	8.81	5.88	8.50	14.50	17.50

1. THE "M" DIMENSIONS DO NOT ALLOW FOR AUXILIARY SWITCHES. REFER TO ALLEN-BRADLEY INSTRUCTIONS FOR ADDITIONAL SPACE REQUIRED.

"K" = 9.88 WHEN "A" = 72.13 ( EXCEPT 200A SWITCH )

"K" = 15.88 WHEN "A" = 84.13 ( EXCEPT 200A SWITCH )

"K" = 18.88 WHEN "A" = 90.13 ( EXCEPT 200A SWITCH )

"K" = 8.56 WHEN "A" = 72.13 ( 200A SWITCH )

"K" = 14.56 WHEN "A" = 84.13 ( 200A SWITCH )

"K" = 17.56 WHEN "A" = 90.13 ( 200A SWITCH )

