

HELICAL BEVEL GEARBOX DOUBLE OUTPUT SHAFT KIT					
SIZE	No.	Part No./ Name	BOM#	Specification	QTY
37	①	KEY	PKD1/4033	1/4"*1-5/16"L	1
	②	KEY	PKD1/4040	1/4"*40mm	1
	③	KEY	PKD1/4040	1/4"*40mm	1
	④	KEY	PKD1/4033	1/4"*1-5/16"L	1
	⑤	OUTPUT SHAFT	KEKD03712	S=25.4mm KEY=6.35	1
	⑥	RETAINING RING	JSPC032045003	φ31.75*φ45*2.5mm	1
	⑦	C-CLIP	PCA032	Φ32	1
SIZE	No.	Part No./ Name	BOM#	Specification	QTY
47	①	KEY	PKD1/4043	1/4"*1-11/16"L	1
	②	KEY	PKD5/16050	5/16"*50 mm	1
	③	KEY	PKD5/16050	5/16"*50 mm	1
	④	KEY	PKD1/4043	1/4"*1-11/16"L	1
	⑤	OUTPUT SHAFT	KEKD04712	S=31.75mm KEY=6.35	1
	⑥	RETAINING RING	JSPC0350450031	φ34.925*φ45*2.5mm	1
	⑦	C-CLIP	PCA035	Φ35	1
SIZE	No.	Part No./ Name	BOM#	Specification	QTY
67	①	KEY	PKD3/8057	3/8"*2-1/4"L	1
	②	KEY	PKD3/8060	3/8"*60 mm	1
	③	KEY	PKD3/8060	3/8"*60 mm	1
	④	KEY	PKD3/8057	3/8"*2-1/4"L	1
	⑤	OUTPUT SHAFT	KEKD06712	S=38.1mm KEY=9.525	1
	⑥	RETAINING RING	JSPC038048003	φ38.1*φ48*2.5mm	1
	⑦	C-CLIP	PCA038	Φ38	1
SIZE	No.	Part No./ Name	BOM#	Specification	QTY
77	①	KEY	PKD1/2067	1/2"*2-5/8"L	1
	②	KEY	PKD1/2070	1/2"*70 mm	1
	③	KEY	PKD1/2070	1/2"*70 mm	1
	④	KEY	PKD1/2067	1/2"*2-5/8"L	1
	⑤	OUTPUT SHAFT	KEKD07712	S=50.8mm KEY=12.7	1
	⑥	RETAINING RING	JSPC051063003	φ50.8*φ63*3mm	1
	⑦	C-CLIP	PCA050	Φ50	1
SIZE	No.	Part No./ Name	BOM#	Specification	QTY
87	①	KEY	PKD5/8092	5/8"*3-5/8" L	1
	②	KEY	PKD5/8080	5/8"*80 mm	1
	③	KEY	PKD5/8080	5/8"*80 mm	1
	④	KEY	PKD5/8092	5/8"*3-5/8" L	1
	⑤	OUTPUT SHAFT	KEKD08712	S=60.325mm KEY=15.875	1
	⑥	RETAINING RING	JSPC0600750031	φ60.325*φ75*3mm	1
	⑦	C-CLIP	PCA060	Φ60	1
SIZE	No.	Part No./ Name	BOM#	Specification	QTY
97	①	KEY	PKD5/8105	5/8"*4-1/8"L	1
	②	KEY	PKD5/8100	5/8"*100 mm	1
	③	KEY	PKD5/8100	5/8"*100 mm	1
	④	KEY	PKD5/8105	5/8"*4-1/8"L	1
	⑤	OUTPUT SHAFT	KEKD09712	S=69.85mm KEY=19.05	1
	⑥	RETAINING RING	JSPC070090004	φ70*φ90*3.5L	1
	⑦	C-CLIP	PCA070	Φ70	1

ASSEMBLING DRAWING

- 1.KEY
- 2.KEY
- 3.KEY
- 4.KEY
- 5.OUTPUT SHAFT
- 6.RETAINING RING
- 7.C-CLIP

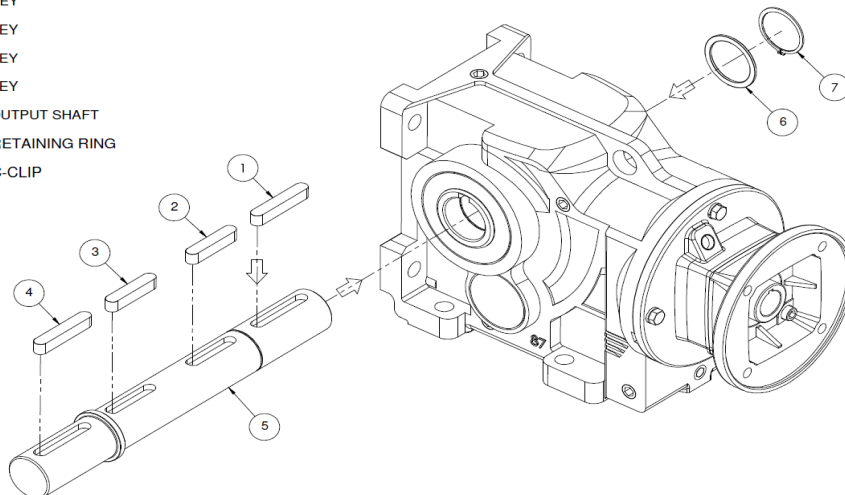

HELICAL BEVEL GEARBOX SINGLE OUTPUT SHAFT KIT					
SIZE	No.	Part No./ Name	BOM#	Specification	QTY
37	①	KEY	PKD1/4040	1/4"*40mm	1
	②	KEY	PKD1/4040	1/4"*40mm	1
	③	KEY	PKD1/4033	1/4"*1-5/16"L	1
	④	OUTPUT SHAFT	KEKS03712	S=25.4 mm KEY=6.35	1
	⑤	ENDPLATE	JSPC012041006	12*41*6L	1
	⑥	WASHER	PWEH7	7/16"	1
	⑦	BOLT	PTBBH3025	7/16"-14 x 1"	1
SIZE	No.	Part No./ Name	BOM#	Specification	QTY
47	①	KEY	PKD5/16050	5/16"*50 mm	1
	②	KEY	PKD5/16050	5/16"*50 mm	1
	③	KEY	PKD1/4043	1/4"*1-11/16"L	1
	④	OUTPUT SHAFT	KEKS04712	S=31.75 mm KEY=6.35	1
	⑤	ENDPLATE	JSPC012044006	12*44*6L	1
	⑥	WASHER	PWEH7	7/16"	1
	⑦	BOLT	PTBBH3025	7/16"-14 x 1"	1
SIZE	No.	Part No./ Name	BOM#	Specification	QTY
67	①	KEY	PKD3/8060	3/8"*60 mm	1
	②	KEY	PKD3/8060	3/8"*60 mm	1
	③	KEY	PKD3/8057	3/8"*2-1/4"L	1
	④	OUTPUT SHAFT	KEKS06712	S=41.275 mm KEY=9.525	1
	⑤	ENDPLATE	JSPC014048007	14*48*7L	1
	⑥	WASHER	PWE04	1/2"	1
	⑦	BOLT	PTBB04032	1/2"-13 x 1.25"	1
SIZE	No.	Part No./ Name	BOM#	Specification	QTY
77	①	KEY	PKD1/2070	1/2"*70 mm	1
	②	KEY	PKD1/2070	1/2"*70 mm	1
	③	KEY	PKD1/2067	1/2"*2-5/8"L	1
	④	OUTPUT SHAFT	KEKS07712	S=50.8 mm KEY=12.7	1
	⑤	ENDPLATE	JSPC014061008	14*61*8L	1
	⑥	WASHER	PWE04	1/2"	1
	⑦	BOLT	PTBB04032	1/2"-13 x 1.25"	1
SIZE	No.	Part No./ Name	BOM#	Specification	QTY
87	①	KEY	PKD5/8080	5/8"*80 mm	1
	②	KEY	PKD5/8080	5/8"*80 mm	1
	③	KEY	PKD5/8092	5/8"*3-5/8"	1
	④	OUTPUT SHAFT	KEKS08712	S=60.325 mm KEY=15.875	1
	⑤	ENDPLATE	JSPC014071008	14*71*8L	1
	⑥	WASHER	PWE04	1/2"	1
	⑦	BOLT	PTBB04032	1/2"-13 x 1.25"	1
SIZE	No.	Part No./ Name	BOM#	Specification	QTY
97	①	KEY	PKD5/8100	5/8"*100 mm	1
	②	KEY	PKD5/8100	5/8"*100 mm	1
	③	KEY	PKD5/8105	5/8"*4-1/8"	1
	④	OUTPUT SHAFT	KEKS09712	S=73.025 mm KEY=19.05	1
	⑤	ENDPLATE	JSPC015080009	15*80*9L	1
	⑥	WASHER	PWE05	5/8"	1
	⑦	BOLT	PTBB05038	5/8"*38 mm	1

ASSEMBLING DRAWING

- 1.KEY
- 2.KEY
- 3.KEY
- 4.OUTPUT SHAFT
- 5.ENDPLATE
- 6.WASHER
- 7.BOLT

