

[Table 1. Dimensions]

Model	Dimension A	Dimension B
	Full Length	Mounting Pitch
CLK2S-24AG-□	306	280
CLK3S/C/CL-24AG-□	406	380
CLK6S/C/CL-24AG-□	706	680

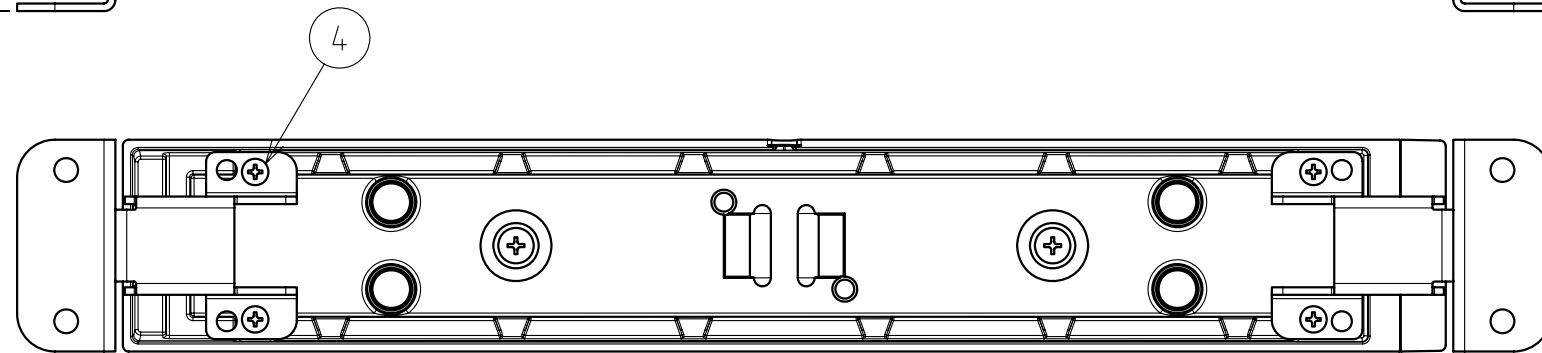

Installation Example Figure
(CLK3S-24AG-CD/CN)

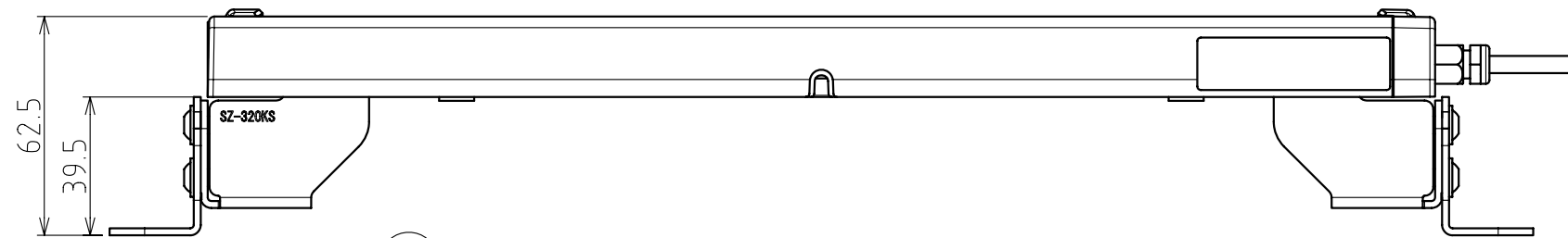
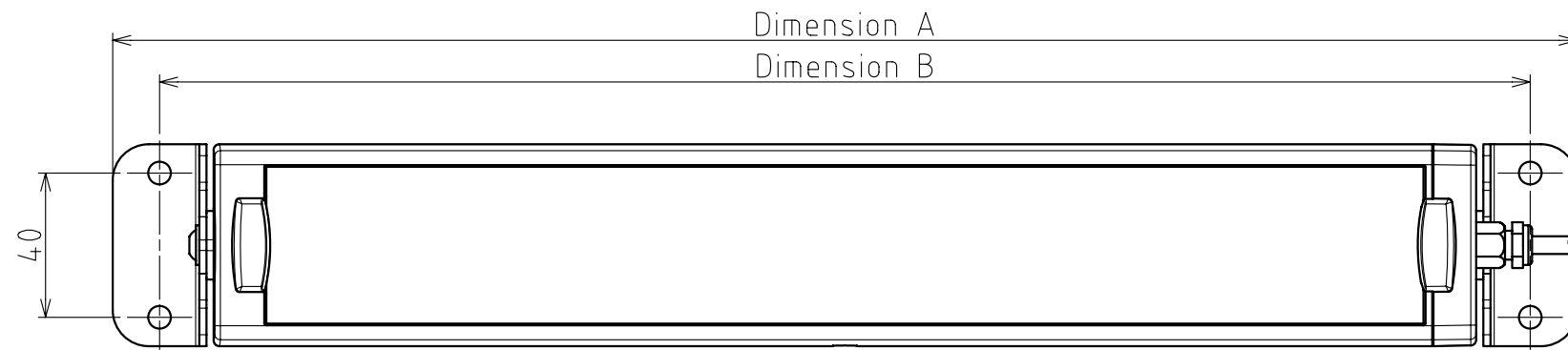
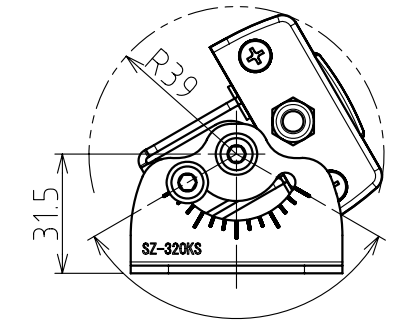

Adjustable Angle 120°
Movement Range

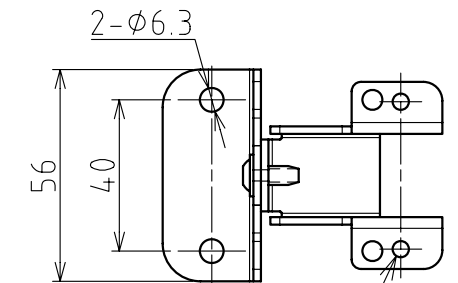
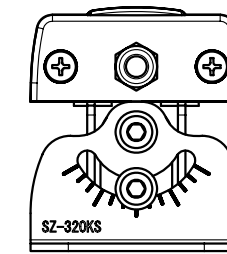

Model CLK-24AG
mounting hole

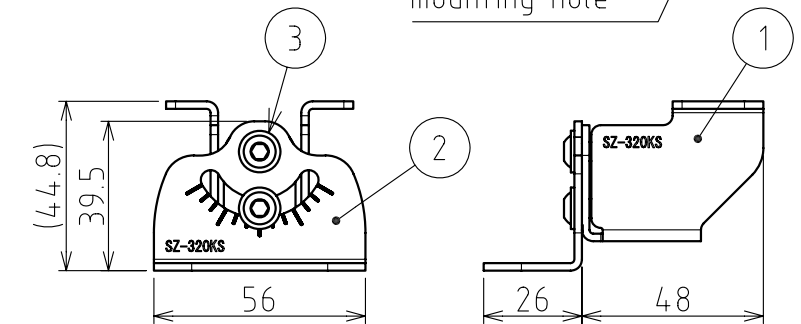

Individual Part Drawing

[Specifications]

Model	SZ-320KS
Mass	110g (1 set)
Mounting Direction Mounting Location	Any Direction Unskewed Surface, Indoor Only
Vibration Resistance	19.6 m/s ²
Operating Temperature Range	-40°C~+60°C (90%RH or less, no condensation)
Corresponding Model	CLK-24 AG (Body: Alluminium Alloy, Lens: Tempered Glass) Series, Exclusive Use
Conformity Standards	RoHS Directive (DIRECTIVE 2002/95/EC)

4	Binding head screw		4	SUSXM7, M4×8	
3	Socket Button Head Cap Screw with Flange		4	SUSXM7, M5×12	
2	Bracket B		2	SUS304, t2.0	
1	Bracket A		2	SUS304, t2.0	
番号 No.	部品名 Part Name	品目コード Part No.	数量 Qty.	材料 & 寸法 & 処理 Material & Size & Finish	記事 Remarks

SZ-320KS Dimensions

株式会社 パトライト
PATLITE Corporation

SZ-320KS-PDFA-EN