

22 mm Plastic Switch Enclosures

Switch enclosures

Specification Standard	Enclosure Material	Gasket Material	Degree of Protection
CEI EN 60947-5-1	Thermoplastic ABS, conforms to UL94/HB	Caoutchouc (rubber) foam	IP65 according to CEI EN 60529



SA107-40SL SA105-40SL SA100SL

Enclosures have molded knock-outs for 1/2" conduit fittings.

Also check out our **metal** pushbutton enclosures in the Enclosures section.

Important notes about enclosure depth and Over-tightening

Switches with two-deep contact blocks require enclosures that are 74 mm deep: 51 mm-deep enclosures are too shallow and the switch contact block will not fit.

For switches with one-deep contact blocks, either 51 mm-deep or 74 mm-deep enclosures can be used.

Also, **do not over-tighten** when securing switch in the enclosure body. Over-tightening will crack the plastic body of the enclosure.

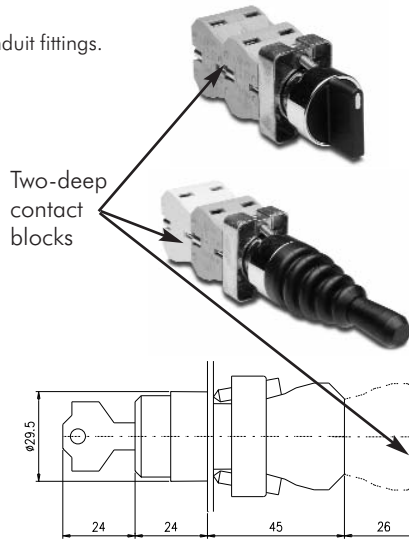

For example: If using a switch having a two-deep contact block with a two-hole enclosure, order a 74 mm-deep SA106-40SL, **not** a 51 mm-deep SA105-40SL.

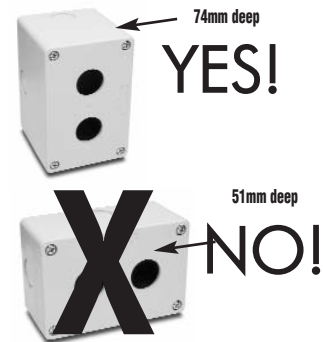

† Note

No-hole model



74 mm deep:
SA111-00

Part Number	Dimensions (HxWxD)	Hole Size/Depth	Mounting Instructions	Color	Price
SA111-00	225x70x74	No Holes	Tighten 22 mm devices only as needed to provide proper sealing. Over-tightening will crack plastic body.	Gray	<--->

Note: This enclosure works with most 22 mm pushbuttons but may not work with Cutler-Hammer E22 series pushbuttons. Check your pushbutton dimensions before ordering.

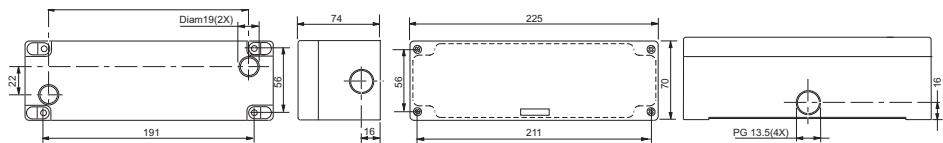

Sa111_00

† Note

Single-hole models



51 mm deep: SA100SL
74 mm deep: SA101SL
SA103SL
SA104SL

Part Number	Dimensions (HxWxD)	Hole Size/Depth	Mounting Instructions	Color	Price
SA100SL	70x70x51	Hole size fits 22 mm devices, 51 mm depth accommodates single-deep contact block switches	Tighten 22 mm devices only as needed to provide proper sealing. Over-tightening will crack plastic body.	Gray	<--->
SA101SL	70x70x51	Hole size fits 22 mm devices, 51 mm depth accommodates single-deep contact block switches		Gray body/yellow top	<--->
SA103SL	70x70x74	Hole size fits 22 mm devices, 74 mm depth accommodates two-deep contact block switches		Gray	<--->
SA104SL	70x70x74	Hole size fits 22 mm devices, 74 mm depth accommodates two-deep contact block switches		Gray body/yellow top	<--->

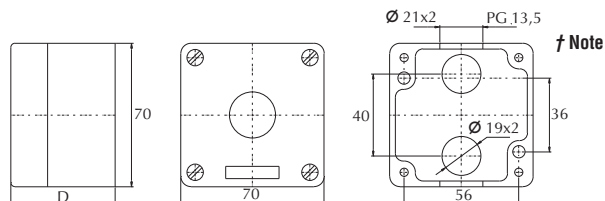

† Note

† Note: All dimensions are in millimeters. 25.4mm = 1 inch.
For example, 30 mm in inches = 30/25.4 = 1.181 inches.

22 mm Plastic Switch Enclosures

Two-hole models



51 mm deep:
SA105-40SL

Part Number	Dimensions (HxWxD)	Hole Size/Depth	Mounting Instructions	Color	Price
SA105-40SL	105x70x51 (40 mm between hole centers)	Hole size fits 22 mm devices, 51 mm depth accommodates single-deep contact block switches	Tighten 22 mm devices only as needed to provide proper sealing. Over-tightening will crack plastic body.	Gray	<--->
SA106-40SL	105x70x74 (40 mm between hole centers)	Hole size fits 22 mm devices, 74 mm depth accommodates two-deep contact block switches	Tighten 22 mm devices only as needed to provide proper sealing. Over-tightening will crack plastic body.	Gray	<--->

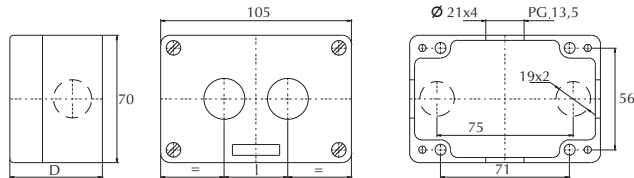

Three-hole models



51 mm deep:
SA107-40SL

Part Number	Dimensions (HxWxD)	Hole Size/Depth	Mounting Instructions	Color	Price
SA107-40SL	140x70x51 (40mm between hole centers)	Hole size fits 22 mm devices, 51mm depth accommodates single-deep contact block switches	Tighten 22 mm devices only as needed to provide proper sealing. Over-tightening will crack plastic body.	Gray	<--->
SA108-40SL	140x70x74 (40mm between hole centers)	Hole size fits 22 mm devices, 74 mm depth accommodates two-deep contact block switches	Tighten 22 mm devices only as needed to provide proper sealing. Over-tightening will crack plastic body.	Gray	<--->

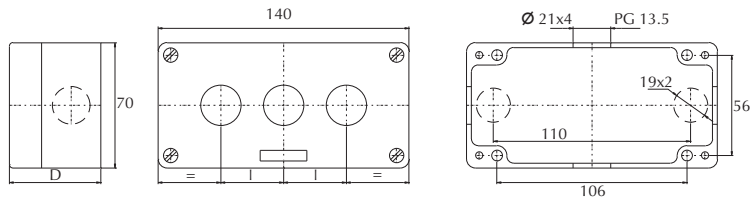

Four-hole models



51 mm deep:
SA109-40SL

Part Number	Dimensions (HxWxD)	Hole Size/Depth	Mounting Instructions	Color	Price
SA109-40SL	185x70x51 (40mm between hole centers)	Hole size fits 22 mm devices, 51 mm depth accommodates single-deep contact block switches	Tighten 22 mm devices only as needed to provide proper sealing. Over-tightening will crack plastic body.	Gray	<--->
SA110-40SL	185x70x74 (40mm between hole centers)	Hole size fits 22 mm devices, 74 mm depth accommodates two-deep contact block switches	Tighten 22 mm devices only as needed to provide proper sealing. Over-tightening will crack plastic body.	Gray	<--->

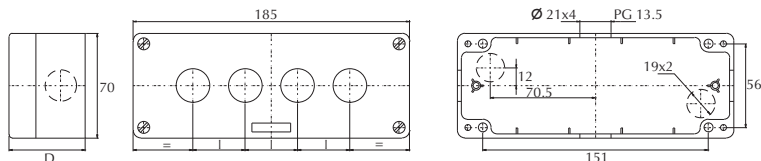

Five-hole and six-hole models



74 mm deep:
SA111



74 mm deep:
SA112

Part Number	Dimensions (HxWxD)	Hole Size/Depth	Mounting Instructions	Color	Price
SA111	225x70x74 (40mm between hole centers)	Hole size fits 22 mm devices, 74 mm depth accommodates two-deep contact block switches	Tighten 22 mm devices only as needed to provide proper sealing. Over-tightening will crack plastic body.	Gray	<--->
SA112	225x70x74 (30mm between hole centers, except 40mm for 6th hole)	Hole size fits 22 mm devices, 74 mm depth accommodates two-deep contact block switches	Tighten 22 mm devices only as needed to provide proper sealing. Over-tightening will crack plastic body.	Gray	<--->

Note: These enclosures work with most 22 mm pushbuttons, but may not work with Cutler-Hammer E22 series pushbuttons. Check your pushbutton dimensions before ordering.

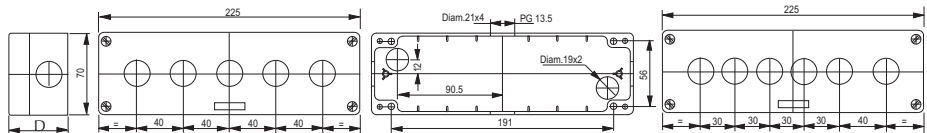

- Company Info.
- PLCs
- Field I/O
- Software
- C-more & other HMI
- AC Drives
- AC Motors
- Power Transmiss.
- Steppers/ Servos
- Motor Controls
- Proximity Sensors
- Photo Sensors
- Limit Switches
- Encoders
- Current Sensors
- Pressure Sensors
- Temp. Sensors
- Pushbuttons/ Lights
- Process
- Relays/ Timers
- Comm.
- Terminal Blocks & Wiring
- Power
- Circuit Protection
- Enclosures
- Tools
- Appendix
- Part Index