

# 22 mm Metal Pilot Device Accessories

## Replacement incandescent bulbs



ECX1902-5

Replacement Incandescent Bulbs				
Part Number	Quantity	Price	Rating	Description
ECX1900-5	Pkg of 5 bulbs	<--->	6V@ 200mA , 1.2 watts	6V replacement bulb for 22 mm switches and indicators. Miniature bayonet base T31/4
ECX1902-5	Pkg of 5 bulbs	<--->	24V@ 80mA 2 watts	24V replacement bulb for 22 mm switches and indicators. Miniature bayonet base T31/4
ECX1904-5	Pkg of 5 bulbs	<--->	130V@20mA 2.6 watts	120V replacement bulb for 22 mm switches and indicators. Miniature bayonet base T31/4

Note: Bulb removal tool available. Order part number HT8LAMPTOOL.

## Replacement LED lamps



ECX1915-2

Replacement LED Lamps					
Part Number	Color	Quantity	Price	Rating	Description
ECX1911-2	Red	Pkg of 2 LED lamps	<--->	24V@26mA 0.6 watts	LED replacement lamp for miniature bayonet bases Works with 22 mm switches and indicators, but illumination will not be as even when used with the ECX 22 mm indicators Note: <b>Will not replace</b> sealed Cutler-Hammer monoblock LED indicators.
ECX1912-2	Green		<--->		
ECX1913-2	Yellow		<--->		
ECX1914-2	Blue		<--->		
ECX1915-2	White		<--->		
ECX1921-2	Red		<--->	120V@5mA 0.6 watts	
ECX1922-2	Green		<--->		
ECX1923-2	Yellow		<--->		
ECX1924-2	Blue		<--->		
ECX1925-2	White		<--->		

## Hole plug



ECX1490

Hole Plug			
Part Number	Color	Price	Description
ECX1490	Black	<--->	Plastic hole plug for 22.5 mm openings in panels and enclosures; supplied with O-ring and mounting screw. Two plugs per package.

## Pilot Light replacement lens



PL1170PR-5

Pilot Light Replacement Lens				
Part Number	Lamp Color	Price	Description	Use with
PL1170PR-5	Red	<--->	22 mm metallic series pilot light replacement lens, 5/pk	Part numbers starting with GCX123
PL1170PV-5	Green	<--->	22 mm metallic series pilot light replacement lens, 5/pk	
PL1170PG-5	Yellow	<--->	22 mm metallic series pilot light replacement lens, 5/pk	
PL1170PB-5	Blue	<--->	22 mm metallic series pilot light replacement lens, 5/pk	
PL1170PN-5	Clear	<--->	22 mm metallic series pilot light replacement lens, 5/pk	
PL1170PW-5	White	<--->	22 mm metallic series pilot light replacement lens, 5/pk	

# 22 mm Metal Pilot Device Accessories

## Protective covers for pushbuttons



ECX1703-5

Protective Covers for Pushbuttons				
Part Number	Color	Quantity	Price	Description
ECX1700-5	Black	Pkg of 5 Protective caps	<-->	Silicone protective covers for use with 22 mm standard-size flush pushbuttons. <b>Will not work</b> with Cutler-Hammer pushbuttons, 22 mm plastic illuminated or extended pushbuttons, or 22 mm plastic pushbuttons with 40 mm actuator face.
ECX1701-5	Red		<-->	
ECX1702-5	Green		<-->	
ECX1703-5	Yellow		<-->	
ECX1704-5	Blue		<-->	
ECX1705-5	Clear		<-->	
ECX1706-5	Clear		<-->	Clear silicone protective covers for use with 22 mm illuminated and <b>extended pushbuttons only</b> . <b>Will not work</b> with Cutler-Hammer pushbuttons or 22 mm mushroom pushbuttons.

## Replacement 22 mm support base



ECX1029-2

Replacement 22 mm Support Base			
Part Number	Quantity	Price	Description
ECX1029-2	Pkg of 1	<-->	22 mm metal support base Note: This item is supplied as a replacement part and is not required with any switch assembly. <b>Will not work</b> with Cutler-Hammer 22 mm switches sold by AUTOMATIONDIRECT

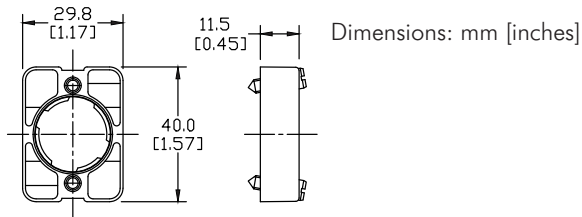

## Replacement contact blocks



ECX1030-2

Replacement Contact Blocks				
Part Number	Quantity	Price	Contacts	Description
ECX1030-2	Pkg of 2	<-->	Red, normally-closed (N.C.)	Replacement contact block for 22 mm pushbuttons and selector switches.
ECX1030-5	Pkg of 5	<-->	Green, normally-open (N.O.)	Tightening Torque, terminal screw: 0.8Nm max mounting screw: 0.5Nm max
ECX1040-2	Pkg of 2	<-->		Brown, normally-open (N.O.), push-push
ECX1040-5	Pkg of 5	<-->		
ECX1042-2	Pkg of 2	<-->		Replacement normally open push-push contact blocks for 22mm pushbutton and selector switches, pack of 2. Note: Will not work with Cutler-Hammer 22mm switches.

Note: See electrical specifications on ECX Series 22 mm Metal Pilot Devices Specifications page at beginning of this section.

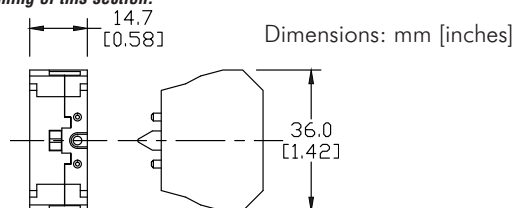

## Replacement keys



ECX1067-2

Replacement Keys			
Part Number	Quantity	Price	Description
ECX1067-2	Pkg of 2 sets (2 keys per set)	<-->	Replacement key for GCX series key-actuated selector switches, pack of 2 sets (2 keys each). NOTE: Will not work with Cutler-Hammer 22mm switches.

Note: All key-actuated 22mm metal selector switches are keyed alike.

# 22 mm Metal Pilot Device Accessories

## EMERGENCY STOP legend plate



ECX1651

EMERGENCY STOP Legend Plate			
Part Number	Quantity	Price	Description
ECX1651	Pkg of 1	<--->	Oversize yellow circular EMERGENCY STOP legend plate for 22 mm E-stop type mushroom pushbuttons, 60 mm outside diameter.

## Knockout Punches



109225

Ruko's knockout punch hole-cutting tool includes punch, die and draw bolt (without ball bearing). Use for sheet steel, stainless-steel sheets, non-ferrous and light metals, and plastics up to 0.16" (8 ga.) thick.

Replacement bolts are offered in three of the most popular sizes.

**Note: Part number 109225 is recommended when punching holes for 22mm pilot devices.**

## Two-position short lever operator



GR1172PR-5

Short Lever Replacement Operator				
Part Number	Lamp Color	Price	2-Position	Use with
GR1172PR-5	Red	<--->	22 mm 2-position selector switch illuminated short lever replacement operator, 5/pk	Part numbers starting with GCX124, GCX125 GCX324, GCX325
GR1172PV-5	Green	<--->	22 mm 2-position selector switch illuminated short lever replacement operator, 5/pk	
GR1172PG-5	Yellow	<--->	22 mm 2-position selector switch illuminated short lever replacement operator, 5/pk	
GR1172PB-5	Blue	<--->	22 mm 2-position selector switch illuminated short lever replacement operator, 5/pk	
GR1172PN-5	Clear	<--->	22 mm 2-position selector switch illuminated short lever replacement operator, 5/pk	

## Three-position short lever operator



GR1288PR-5

Short Lever Replacement Operator				
Part Number	Lamp Color	Price	3-Position	Use with
GR1288PR-5	Red	<--->	22 mm 3-position selector switch illuminated short lever replacement operator, 5/pk	Part numbers starting with GCX126, GCX128 GCX326, GCX328
GR1288PV-5	Green	<--->	22 mm 3-position selector switch illuminated short lever replacement operator, 5/pk	
GR1288PG-5	Yellow	<--->	22 mm 3-position selector switch illuminated short lever replacement operator, 5/pk	
GR1288PB-5	Blue	<--->	22 mm 3-position selector switch illuminated short lever replacement operator, 5/pk	
GR1288PN-5	Clear	<--->	22 mm 3-position selector switch illuminated short lever replacement operator, 5/pk	

# 22 mm Metal Pilot Device Accessories

## Mushroom switch replacement operator



PL1298P-5

Mushroom Switch Replacement Operator				
Part Number	Lamp Color	Price	Description	Use with
PL1171PR-5	Red	<--->	22 mm, illuminated <b>momentary</b> Mushroom switch replacement operator, red, 5/pk	Part numbers starting with GCX1221, GCX3221 mushroom-style illuminated pushbuttons
PL1298P-5	Red	<--->	22 mm illuminated <b>twist-to-release</b> mushroom switch replacement operator, red, 5/pk	Part numbers starting with GCX1226, GCX3226 mushroom-style illuminated pushbuttons

## Flush pushbutton replacement operator



GR1168PR-5

Flush Pushbutton Replacement Operator				
Part Number	Lamp Color	Price	Description	Use with
GR1168PR-5	Red	<--->	22 mm illuminated flush pushbutton replacement operator, 5/pk	Part numbers starting with GCX119, GCX120 GCX319, GCX320
GR1168PV-5	Green	<--->	22 mm illuminated flush pushbutton replacement operator, 5/pk	
GR1168PG-5	Yellow	<--->	22 mm illuminated flush pushbutton replacement operator, 5/pk	
GR1168PB-5	Blue	<--->	22 mm illuminated flush pushbutton replacement operator, 5/pk	
GR1168PN-5	Clear	<--->	22 mm illuminated flush pushbutton replacement operator, 5/pk	
GR1168PW-5	White	<--->	22 mm illuminated flush pushbutton replacement operator, 5/pk	

## Extended pushbutton replacement operator



PL1308PR-5

Extended Pushbutton Replacement Operator				
Part Number	Lamp Color	Price	Description	Use with
PL1308PR-5	Red	<--->	22 mm illuminated extended pushbutton, replacement operator, 5/pk	Part numbers starting with GCX121, GCX321
PL1308PV-5	Green	<--->	22 mm illuminated extended pushbutton, replacement operator, 5/pk	
PL1308PG-5	Yellow	<--->	22 mm illuminated extended pushbutton, replacement operator, 5/pk	
PL1308PB-5	Blue	<--->	22 mm illuminated extended pushbutton, replacement operator, 5/pk	
PL1308PN-5	Clear	<--->	22 mm illuminated extended pushbutton, replacement operator, 5/pk	
PL1308PW-5	White	<--->	22 mm illuminated extended pushbutton, replacement operator, 5/pk	