

Stacklight Accessories and Replacement Parts

Audible alarms

Three different audible alarms are available for E26 stacklights in 24 and 120 VAC/DC. One alarm per stacklight may be included in the assembly and is mounted atop the stacklight. No tools are required for attaching or wiring the alarm. The alarm draws very little current and units used in 120 VAC applications should be switched with dry contact type output devices. Leakage from triac modules will activate the alarm in the "OFF" condition. Alarms are available in mono-tonal, bi-tonal, and intermittent tones. The sound levels can be adjusted from 64 to 90 dB. Typical current draw is 11 to 13 mA for 24V and 120V versions. Check out our Web site for .wav samples of the alarm tones.

Alarm Units Specifications								
Volts AC/DC	Adjustment Range	Typical Current Draw (mA)	Mono-tonal Part Number	Price	Bi-tonal Part Number	Price	Intermittent Part Number	Price
24V	64 dB to 90 dB	12.6	E26BQV2	<--->	E26BNV2	<--->	E26BPV2	<--->
120V	64 dB to 90 dB	11.5	E26BQV4	<--->	E26BNV4	<--->	E26BPV4	<--->



Audible alarm

Alarm Unit Dimensions

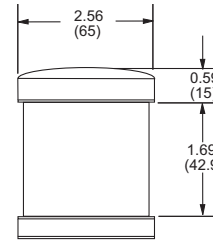

Dimensions in inches (millimeters)

Extension tubes and mounting bases

The E26 stacklight base may be mounted directly to the machine or control cabinet. For greater height, extension tubes and mounting bases are available. The mounting base is anodized alloy and threaded to 3/4" NPT for compatibility with standard pipe and conduit threads. The extension tubes are also anodized alloy and threaded to 3/4" NPT. Extension tubes are available in four straight lengths from 3/4" to 30", and a 2" x 2.5" right-angle extension model.

Extension Tube Specifications				
Description	Length	Height A* with Mounting Base	Part Number	Price
For use with standard mounting base or 3/4" NPT threaded hub --black anodized aluminum.	0.79" (20mm)	1.77" (45mm)	E26BHU	<--->
	6.30" (160mm)	7.28" (185mm)	E26BJU	<--->
	14.17" (360mm)	15.16" (385mm)	E26BKU	<--->
	29.92" (760mm)	30.91" (785mm)	E26BMU	<--->
Description	Dimensions		Part Number	Price
Right angle extension tube for E26 stacklights	2.00"(50.8mm) x 2.50"(63.5mm)		E26BRU	<--->

Mounting Base Specifications			
Description	Notes	Part Number	Price
Mounting base for optional elevated mounting using extension tube. Black anodized cast zinc.	Standard 4-hole mounting base.	E26S109	<--->

Extension tube with mounting base *Height dimension "A"



Mounting base



Extension tube

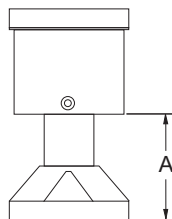

Right angle extension tube

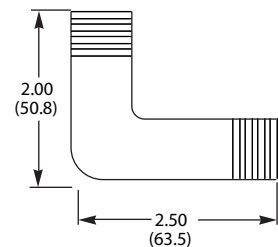

Stacklight Replacement Parts

Gasket



Gasket Specifications			
Description	Notes	Part Number	Price
Replacement mounting gasket	Included with stacklight base.	E26S105	<--->

O-ring



O-ring Specifications			
Description	Notes	Part Number	Price
Replacement lens O-ring	Included with light modules.	E26S106	<--->

Replacement lamps



Incandescent Replacement Lamps			
Description	Volts AC/DC	Part Number	Price
Incandescent replacement lamps	24V	E26S9 (marked on base 28-6019-2)	<--->
	110/120V	E26S11 (marked on base 28-6019-4)	<--->

LEDs

These LEDs can be used as replacement bulbs to convert a standard incandescent lamp to an LED type.

Note: Use with dry contact outputs when operating with AC. Triac leakage current will illuminate the LED module.



Replacement LEDs							
Volts AC/DC	Color	Part Number	Price	Volts AC/DC	Color	Part Number	Price
24V	Red	E26S117	<--->	120V	Red	E26S138	<--->
24V	Amber	E26S118	<--->	120V	Amber	E26S139	<--->
24V	Green	E26S121	<--->	120V	Green	E26S142	<--->
24V	Blue	E26S122	<--->	120V	Blue	E26S143	<--->
24V	White	E26S123	<--->	*			

***Note:** 120V White LED Modules are not available.