

# PB Series Edison Open-Style Terminal Blocks

## Open-style terminal blocks for cable termination

Edison Open-style terminal blocks are a convenient way to manage your power distribution needs. They are engineered to maintain an SCCR rating of 200kA with copper conductors and an SCCR of 10 kA for aluminum conductors, making these distribution blocks the ideal solution to today's power circuit wiring needs.

## Features

- Used in UL508A panels for branch circuit applications
- Standard aluminum box connectors accommodate copper wire. PB401x, PB512x and PB712x series accommodate copper or aluminum wire.
- Tin-plated aluminum connectors suitable for copper conductors
- Available safety covers for greater protection (purchase separately)
- Suitable for both factory and field wiring

## Ratings

- Ampere ratings up to 760 Amps
- 600 VAC or VDC
- Short Circuit Current Rating (SCCR) 200kA with proper fusing
- Flammability: UL 94V0

## Agency Approvals

- UL 1059 recognized - File E221592 Guide XCFR2
- CSA Certified: Class 6228-01, File 700489
- CE

Open Type Power Distribution Blocks Selection Table							
Series	Part Number	Amps	Description	SCCR Rtg	Pcs/Pkg	Wt.	Price
PB Series	PB1011	175 max	1 pole distribution block, 1 in/1 out	200 kA	1	2.8 oz.	<--->
	PB1012	175 max	2 pole distribution block, 1 in/1 out	200 kA	1	4.6 oz.	<--->
	PB1013	175 max	3 pole distribution block, 1 in/1 out	200 kA	1	6.8 oz.	<--->
	PB1041	175 max	1 pole distribution block, 1 in/4 out	200 kA	1	3.1 oz.	<--->
	PB1042	175 max	2 pole distribution block, 1 in/4 out	200 kA	1	5.2 oz.	<--->
	PB1043	175 max	3 pole distribution block, 1 in/4 out	200 kA	1	7.3 oz.	<--->
	PB3061	310 max	1 pole distribution block, 1 in/6 out	200 kA	1	10.9 oz.	<--->
	PB3062	310 max	2 pole distribution block, 1 in/6 out	200 kA	1	19.1 oz.	<--->
	PB3063	310 max	3 pole distribution block, 1 in/6 out	200 kA	1	25.5 oz.	<--->
	PB3121	310 max	1 pole distribution block, 1 in/12 out	200 kA	1	12.7 oz.	<--->
	PB3122	310 max	2 pole distribution block, 1 in/12 out	200 kA	1	21.6 oz.	<--->
	PB3123	310 max	3 pole distribution block, 1 in/12 out	200 kA	1	31.1 oz.	<--->
	PB4011	380 max	1 pole distribution block, 1 in/Stud	10 kA	1	11.9 oz.	<--->
	PB4012	380 max	2 pole distribution block, 1 in/Stud	10 kA	1	20.7 oz.	<--->
	PB4013	380 max	3 pole distribution block, 1 in/Stud	10 kA	1	29.1 oz.	<--->
	PB5121	570 max	1 pole distribution block, 2 in/12 out	10 kA	1	13.8 oz.	<--->
	PB5122	570 max	2 pole distribution block, 2 in/12 out	10 kA	1	24.4 oz.	<--->
	PB5123	570 max	3 pole distribution block, 2 in/12 out	10 kA	1	34.7 oz.	<--->
	PB7121	760 max	1 pole distribution block, 2 in/12 out	10 kA	1	17.0 oz.	<--->
PB7123	760 max	3 pole distribution block, 2 in/12 out	10 kA	1	44.0 oz.	<--->	



Safety Covers for Open Power Distribution Blocks Selection Table				
Part Number	Description	Pcs/Pkg	Wt.	Price
PBC21	Power distribution block cover for all 175A open style 1-pole blocks	1	0.3 oz.	<--->
PBC22	Power distribution block cover for all 175A open style 2-pole blocks	1	0.4 oz.	<--->
PBC23	Power distribution block cover for all 175A open style 3-pole blocks	1	0.5 oz.	<--->
PBC31	Power distribution block cover for all 310A, 380A, and 570A open style 1-pole blocks	1	0.9 oz.	<--->
PBC32	Power distribution block cover for all 310A, 380A, and 570A open style 2-pole blocks	1	1.3 oz.	<--->
PBC33	Power distribution block cover for all 310A, 380A, and 570A open style 3-pole blocks	1	1.6 oz.	<--->
PBC71	Power distribution block cover for all 760A open style 1-pole and 3-pole blocks. 1 pole block requires 1 cover. 3-pole block requires 3 covers	1	0.9 oz.	<--->

Open Style Power Distribution Block General Specifications	
Wire type	75°C* Copper
Voltage	600 VAC or VDC maximum
Mounting	Surface mount
*Note: Amp Rating based on NEC table 310.16 for 75°C copper wire.	

Company Information

Systems Overview

Programmable Controllers

Field I/O

Software

C-more & other HMI

Drives

Soft Starters

Motors & Gearbox

Steppers/ Servos

Motor Controls

Proximity Sensors

Photo Sensors

Limit Switches

Encoders

Current Sensors

Pressure Sensors

Temperature Sensors

Pushbuttons/ Lights

Process

Relays/ Timers

Comm.

Terminal Blocks & Wiring

Power

Circuit Protection

Enclosures

Tools

Pneumatics

Safety

Appendix

Product Index

Part # Index

# PB Series Edison Open-Style Terminal Blocks Specifications

UL Series Wire and Torque Range Specifications								
Part Number	Line				Load			
	CU Wire Range	Torque Lb-in (Nm)	Trim Length in (mm)	Hex Key	CU Wire Range	Torque Lb-in (Nm)	Trim Length in (mm)	Hex Key, Slot, Stud
PB1011	2/0 to 8 AWG, 70 to 10 mm <sup>2</sup>	110 [12.4]	0.70 [17.8]	3/16"	2/0 to 8 AWG, 70 to 10 mm <sup>2</sup>	110 [12.4]	0.70 [17.8]	3/16" Hex
PB1012								
PB1013								
PB1041	2/0 to 8 AWG, 70 to 10 mm <sup>2</sup>	120 [13.6]	0.670 [17.0]	3/16"	4 to 6 AWG, 25 to 16 mm <sup>2</sup>	35 (4.0)	0.470 [11.9] top row, 0.780 [19.8] bottom row	Slot
PB1042					8 AWG, 10 mm <sup>2</sup>	25 (2.8)		
PB1043					10 to 14 AWG, 6 to 2.5 mm <sup>2</sup>	20 (2.3)		
PB3061	350 kcmil to 4 AWG, 185 to 25 mm <sup>2</sup>	275 [31.1]	0.90 [22.9]	5/16"	4 to 6 AWG, 25 to 16 mm <sup>2</sup>	35 (4.0)	1.00 [25.4] top row 0.45 [11.43] bottom row	Slot
PB3062					8 AWG, 10 mm <sup>2</sup>	25 (2.8)		
PB3063					10 to 12 AWG, 6 to 4 mm <sup>2</sup>	20 (2.3)		
PB3121	350 kcmil to 4 AWG 185 to 25 mm <sup>2</sup>	275 [31.1]	0.90 [22.9]	5/16"	4 to 6 AWG, 25 to 16 mm <sup>2</sup>	35 (4.0)	0.450 [11.4] top row, 0.630 [16.0] middle row, 0.920 [23.4] bottom row	Slot
PB3122					8 AWG, 10 mm <sup>2</sup>	25 (2.8)		
PB3123					10 to 14 AWG, 6 to 2.5 mm <sup>2</sup>	20 (2.3)		

Short-Circuit Current Rating Data												
Part Number	Number of Poles	Capacity*	Line	Load	Configuration	Conductors		Maximum Fuse Class and Amp**				SCCR
			Wire Range	Wire Range	Openings per Pole	Line AWG or kcmil	Load AWG or kcmil	Class J (JDL)	Class T (A3T/ A6T)	Class RK1 (LENRK/ LESRK)	Class RK5 (ECNR/ ECSR)	
PB1011	1	175A	2/0 to 8 AWG 70 to 10 mm <sup>2</sup>	2/0 to 8 AWG 70 to 10 mm <sup>2</sup>	1/1	2/0 to 8	2/0 to 8	200	200	200	60	200 kA
PB1012	2											
PB1013	3											
PB1041	1	175A	2/0 to 8 AWG 70 to 10 mm <sup>2</sup>	4 to 14 AWG 25 to 2.5 mm <sup>2</sup>	1/4	2/0 to 8	4 to 12	200	200	200	60	200 kA
PB1042	2						4 to 14	175	175	100	60	100 kA
PB1043	3						200	200	100	60	50 kA	
PB3061	1	310A	350 kcmil to 4 AWG 185 to 25 mm <sup>2</sup>	4 to 12 AWG 25 to 4 mm <sup>2</sup>	1/6	350 to 4	4 to 8	400	400	200	100	200 kA
PB3062	2						4 to 8	400	400	400	100	100 kA
PB3063	3						4 to 12	175	175	100	60	100 kA
PB3121	1	310A	350 kcmil to 4 AWG 185 to 25 mm <sup>2</sup>	4 to 14 AWG 25 to 2.5 mm <sup>2</sup>	1/12	350 to 4	4 to 8	400	400	200	100	200 kA
PB3122	2						4 to 14	175	175	100	60	100 kA
PB3123	3						4 to 14	175	175	100	60	100 kA
PB4011	1	380A	500 kcmil to 6 AWG 240 to 16 mm <sup>2</sup>	One 3/8" - 16 x 1 stud	One 3/8" - 16 x 1 stud	500	One 3/8" - 16 x 1 stud	***	***	***	***	10 kA
PB4012	2					500 to 6	***	***	***	***		
PB4013	3					500 to 6	***	***	***	***		
PB5121	1	570A	300 kcmil to 4 AWG 150 to 25 mm <sup>2</sup>	4 AWG to 14 AWG 25 to 2.5 mm <sup>2</sup>	2/12	300	4 to 14	***	***	***	***	10 kA
PB5122	2					300 to 4	***	***	***	***		
PB5123	3					300 to 4	***	***	***	***		
PB7121	1	760A	500 kcmil to 6 AWG 240 to 16 mm <sup>2</sup>	4 AWG to 14 AWG 25 to 2.5 mm <sup>2</sup>	2/12	500 to 6	4 to 14	***	***	***	***	10 kA
PB7123	3						4 to 14	***	***	***	***	

\*Amp ratings are based on NEC® Table 310.16 for 75°C copper wire and UL508A Table 28.1

\*\*Class G 60A or less or Class CC 30A or less fuses are suitable for all SCCR in this table.

\*\*\*Not High SCCR rated. Refer to UL508A Table SB4.1.

# PB Series Edison Open-Style Terminal Blocks Dimensions

Edison Open-Style Power Distribution Blocks Dimensions (in[mm])													
Part Number	Width			Length	Height								
	A1	A2	A3	B	C	D	E	F	G	H	J	K	L
PB1011	1.06 [26.92]	1.88 [47.75]	2.60 [66.04]	2.85 [72.39]	1.75 [44.45]	0.81 [20.57]	2.25 [57.15]	0.53 [13.46]	0.31 [7.87]	0.84 [21.34]	0.31 [7.87]	0.20 [5.08]	0.42 [10.67]
PB1012													
PB1013													
PB1041													
PB1042													
PB1043													
PB3061	1.96 [49.78]	3.58 [90.93]	5.20 [132.08]	4.0 [101.60]	3.32 [84.33]	1.62 [41.15]	3.37 [85.60]	0.985 [25.02]	0.310 [7.87]	0.780 [19.81]	0.250 [6.35]	Slot 0.20 [5.08] (w) x 0.41 [10.41] (l)	Slot 0.42 [10.67] (w) x 0.62 [15.75] (l)
PB3062													
PB3063													
PB3121													
PB3122													
PB3123													
PB4011													
PB4012													
PB4013													
PB5121													
PB5122													
PB5123													

PB1011, PB1012, PB1013  
PB1041, PB1042, PB1043

PB3061, PB3062, PB3063  
PB3121, PB3122, PB3123  
PB4011, PB4012, PB4013  
PB5121, PB5122, PB5123

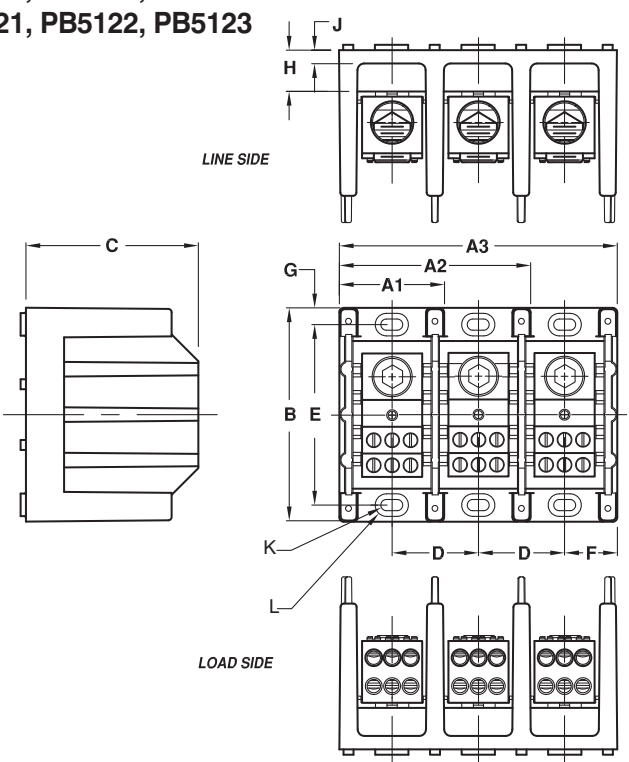
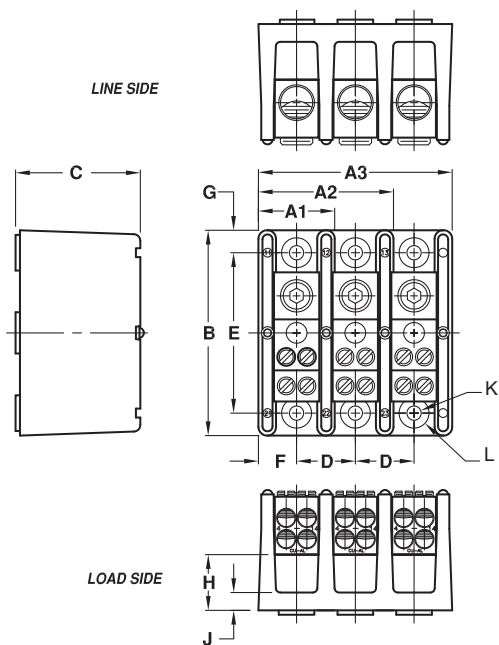

Part Number	Minimum Enclosure Size in[mm]*
PB1011, PB1012, PB1013	16 x 16 x 6.75 [406.4 x 406.4 x 171.45]
PB1041, PB1042, PB1043	16 x 16 x 6.75 [406.4 x 406.4 x 171.45]
PB3061, PB3062, PB3063	24 x 20 x 6.75 [609.6 x 508 x 171.45]
PB3121, PB3122, PB3123	24 x 20 x 6.75 [609.6 x 508 x 171.45]
PB4011, PB4012, PB4013	N/A
PB5121, PB5122, PB5123	N/A
PB7121, PB7123	N/A

\*Note: Terminal block SCCR determined based on testing in minimum-size enclosure

# PB Series Edison Open-Style Terminal Blocks Dimensions

Edison Open-Style Power Distribution Blocks Dimensions (in [mm])													
Part Number	Width	Length	Height										
	A	B	C1	C2	C3	D	E	F	G	H	J	K	L
PB7121	5.5	4.75	3.10	5.79	8.48	2.93	2.69	1.55	0.38	1.19	0.44	Slot: 0.20 [5.08] (w)	Slot: 0.41 [10.41] (w)
PB7123	[139.7]	[120.7]	[78.74]	[147.1]	[215.39]	[74.42]	[68.33]	[39.37]	[9.65]	[30.23]	[11.18]	X 0.33 [8.38] (l)	X 0.53 [13.46] (l)

## PB7121, PB7123

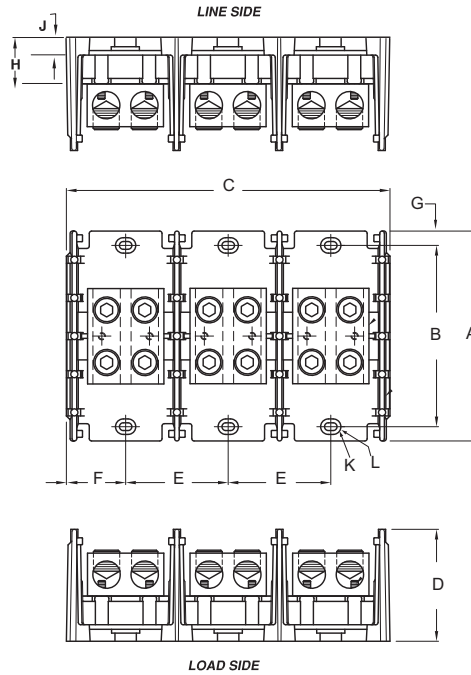

## Covers

Optional Cover for  
PB1011, PB1012, PB1013  
PB1041, PB1042, PB1043

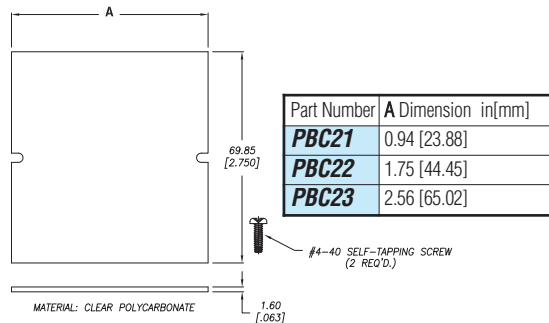

Optional Cover for  
PB3061, PB3062, PB3063  
PB3121, PB3122, PB3123

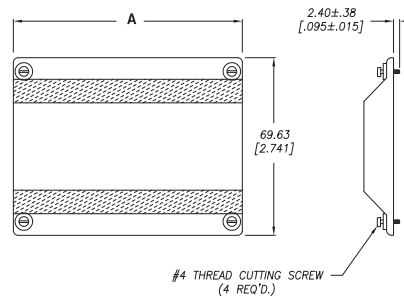

PB4011, PB4012, PB4013  
PB5121, PB5122, 5123

Optional Cover for PB7121 and PB7123

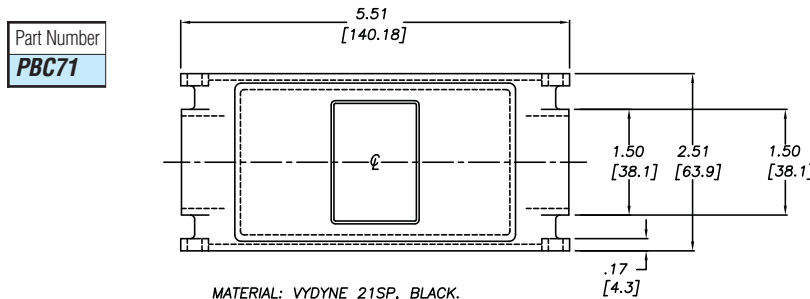

Note: Dimensions are in inches [millimeters]

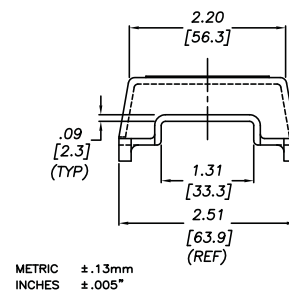



Company Information

Systems Overview

Programmable Controllers

Field I/O

Software

C-more & other HMI

Drives

Soft Starters

Motors & Gearbox

Steppers/ Servos

Motor Controls

Proximity Sensors

Photo Sensors

Limit Switches

Encoders

Current Sensors

Pressure Sensors

Temperature Sensors

Pushbuttons/ Lights

Process

Relays/ Timers

Comm.

Terminal Blocks & Wiring

Power

Circuit Protection

Enclosures

Tools

Pneumatics

Safety

Appendix

Product Index

Part # Index

# Edison Open-Style Power Distribution Blocks Quick Reference

Openings per pole	Type	175 amps	310 amps	380 amps	570 amps	760 amps
1 in 1 out	Open UL1059	<b>PB101x</b>	NO	NO	NO	NO
	Open UL1953 Listed	<b>HPB101-x</b>	<b>HPB101-x</b>	NO	NO	NO
	Finger Safe UL1953 Listed	<b>EPDB101</b>	<b>EPDB301</b>	NO	NO	NO
1 in 1 stud out	Open UL1059	NO	NO	<b>PB401x</b>	NO	NO
	Open UL1953 Listed	<b>HPB10S-x</b>	NO	NO	NO	NO
	Finger Safe UL1953 Listed	NO	NO	NO	NO	NO
2 in 2 out	Open UL1059	NO	NO	NO	NO	NO
	Open UL1953 Listed	NO	NO	NO	NO	NO
	Finger Safe UL1953 Listed	NO	NO	NO	NO	<b>EPDB702</b>
1 in 4 out	Open UL1059	<b>PB104x</b>	NO	NO	NO	NO
	Open UL1953 Listed	<b>HPB104-x</b>	<b>HPB104-x</b>	NO	NO	NO
	Finger Safe UL1953 Listed	<b>EPDB104</b>	NO	NO	NO	NO
1 in 6 out	Open UL1059	NO	<b>PB306x</b>	NO	NO	NO
	Open UL1953 Listed	<b>HPB106-x</b>	<b>HPB306-x</b>	NO	NO	NO
	Finger Safe UL1953 Listed	NO	NO	<b>EPDB306</b>	NO	NO
1 in 9 out	Open UL1059	NO	NO	NO	NO	NO
	Open UL1953 Listed	NO	<b>HPB309-x</b>	NO	NO	NO
	Finger Safe UL1953 Listed	NO	NO	NO	NO	NO
1 in 12 out	Open UL1059	NO	<b>PB312x</b>	NO	NO	NO
	Open UL1953 Listed	NO	<b>HPB312-x</b>	NO	NO	NO
	Finger Safe UL1953 Listed	NO	NO	NO	NO	NO
2 in 12 out	Open UL1059	NO	NO	NO	<b>PB512x</b>	<b>PB712x</b>
	Open UL1953 Listed	NO	NO	NO	NO	NO
	Finger Safe UL1953 Listed	NO	NO	NO	<b>EPDB512</b>	NO