

IronHorse® MTCP Premium Efficiency Cast-Iron Three-Phase AC Motors

T-Frame TEFC Motors – Three-Phase Industrial Duty – 1 to 200 hp⁽⁴⁾

TC-Frame (C-Face) TEFC Motors – Three-Phase Industrial Duty – 1 to 100 hp



**Premium Efficiency
Three-Phase Cast Iron T-Frame**



**Premium Efficiency
Three-Phase Cast Iron TC-Frame**

Features

- Available in 1200, 1800, & 3600 rpm
- Totally Enclosed Fan Cooled (TEFC) enclosure
- NEMA TC-frame (C-face) and T-frame motors
- Cast iron frame with ribbed design for maximum cooling
- Solid full frame length cast iron mounting feet
- Steel fan cover
- Cast iron junction box with rubber gasket and rubber dust cover
- NSK/NTN/SKF brand premium quality ball or roller bearings
- Maintenance free bearings (10 hp and below)
- V-ring shaft seals on drive end and on opposite drive end
- Electrically reversible
- Class F winding insulation
- Service Factor: 1.15 (1.0 with AC drive)
- Meets or exceeds Premium Efficiency standards
- Class I, Div 2 hazardous locations
- Inverter ratings: 10:1 (variable torque); 4:1 (constant torque)
- Two year warranty
- cCSA_{US} certified, ISO9001, CE

Accessories & Spare Parts Available

- STABLE motor slide bases for adjustable mounting
- C-flange kits (for converting T-frame motors to TC-frame)
- Replacement junction boxes
- Replacement fans
- Replacement fan shrouds

Applications

- Fans
- Conveyors
- Pumps
- Material Handling
- Metal Processing
- Textile Processing
- Test Stands



Company Information

Systems Overview

Programmable Controllers

Field I/O

Software

C-more & other HMI

Drives

Soft Starters

Motors & Gearbox

Steppers/ Servos

Motor Controls

Proximity Sensors

Photo Sensors

Limit Switches

Encoders

Current Sensors

Pressure Sensors

Temperature Sensors

Pushbuttons/ Lights

Process

Relays/ Timers

Comm.

Terminal Blocks & Wiring

Power

Circuit Protection

Enclosures

Tools

Pneumatics

Safety

Appendix

Product Index

Part # Index

IronHorse® MTCP Premium Efficiency Cast-Iron Three-Phase AC Motors

T-Frame TEFC Motors – Three-Phase Industrial Duty – 1–200 hp⁽⁴⁾ – 1800 rpm

TC-Frame (C-Face) TEFC Motors – 3-Phase Industrial Duty – 1–100 hp – 1800 rpm

| Motor Specifications – Premium Efficiency T & TC Frame Three-Phase Motors – 1800 rpm | | | | | | | | | | | | | | |
|--|-------|--------------------|----------|-------|---------------|----------|------------|-------------------------|--------------|----------------|----------------------|----------------------------|---------------|---------|
| Part Number | Price | HP | Base RPM | Phase | Voltage | Housing | NEMA Frame | Mounting ⁽¹⁾ | Holes / Foot | Service Factor | F.L. Amps @230V/460V | Approx Product Weight (lb) | | |
| MTCP-001-3BD18 | <---> | 1 | 1800 | 3 | 208-230/460 | TEFC | | F1(F2) | 1.15 | | 3.22 / 1.61 | 41 | | |
| MTCP-001-3BD18C | <---> | | | | | | | | | | | 45 | | |
| MTCP-1P5-3BD18 | <---> | 1.5 | | | | | | | | | 145T | 4 | 4.64 / 2.32 | 47 |
| MTCP-1P5-3BD18C | <---> | | | | | | | | | | | | | 50 |
| MTCP-002-3BD18 | <---> | 2 | | | | | | | | | 145T | 4 | 6.0 / 3.0 | 56 |
| MTCP-002-3BD18C | <---> | | | | | | | | | | | | | 60 |
| MTCP-003-3BD18 | <---> | 3 | | | | | | | | | 182T | 2 | 8.05 / 4.02 | 84 (2) |
| MTCP-003-3BD18C | <---> | | | | | | | | | | | | | 92 (2) |
| MTCP-005-3BD18 | <---> | 5 | | | | | | | | | 184T | 4 | 13.41 / 6.71 | 99 (2) |
| MTCP-005-3BD18C | <---> | | | | | | | | | | | | | 107 (2) |
| MTCP-7P5-3BD18 | <---> | 7.5 | | | | | | | | | 213T | 2 | 18.68 / 9.34 | 150 (2) |
| MTCP-7P5-3BD18C | <---> | | | | | | | | | | | | | 154 (2) |
| MTCP-010-3BD18 | <---> | 10 | | | | | | | | | 215T | 4 | 24.9 / 12.45 | 186 (2) |
| MTCP-010-3BD18C | <---> | | | | | | | | | | | | | 190 (2) |
| MTCP-015-3BD18 | <---> | 15 | | | | | | | | | 254T | 2 | 35.8 / 17.9 | 329 (2) |
| MTCP-015-3BD18C | <---> | | | | | | | | | | | | | 325 (2) |
| MTCP-020-3BD18 | <---> | 20 | | | | | | | | | 256T | 4 | 47.94 / 23.97 | 390 (2) |
| MTCP-020-3BD18C | <---> | | | | | | | | | | | | | 370 (2) |
| MTCP-025-3BD18 ⁽²⁾ | <---> | 25 | | | | | | | | | 284T | 2 | 59.6 / 29.8 | 455 (2) |
| MTCP-025-3BD18C ⁽²⁾ | <---> | | | | | | | | | | | | | 467 (2) |
| MTCP-030-3BD18 ⁽²⁾ | <---> | 30 | 286T | 4 | 69.96 / 34.98 | 488 (2) | | | | | | | | |
| MTCP-030-3BD18C ⁽²⁾ | <---> | | | | | 497 (2) | | | | | | | | |
| MTCP-040-3BD18 ⁽²⁾ | <---> | 40 | 324T | 2 | 94.76 / 47.38 | 611 (2) | | | | | | | | |
| MTCP-040-3BD18C ⁽²⁾ | <---> | | | | | 626 (2) | | | | | | | | |
| MTCP-050-3BD18 ⁽²⁾⁽³⁾ | <---> | 50 ⁽³⁾ | 326T | 4 | 116.8 / 58.4 | 690 (2) | | | | | | | | |
| MTCP-050-3BD18C ⁽²⁾⁽³⁾ | <---> | | | | | 706 (2) | | | | | | | | |
| MTCP-060-3BD18 ⁽²⁾⁽³⁾ | <---> | 60 ⁽³⁾ | 364T | 2 | 139.3 / 69.6 | 851 (2) | | | | | | | | |
| MTCP-060-3BD18C ⁽²⁾⁽³⁾ | <---> | | | | | 864 (2) | | | | | | | | |
| MTCP-075-3BD18 ⁽²⁾⁽³⁾ | <---> | 75 ⁽³⁾ | 365T | 4 | 173.4 / 86.7 | 948 (2) | | | | | | | | |
| MTCP-075-3BD18C ⁽²⁾⁽³⁾ | <---> | | | | | 961 (2) | | | | | | | | |
| MTCP-100-3BD18 ⁽²⁾⁽³⁾ | <---> | 100 ⁽³⁾ | 405T | 4 | 228.6 / 114.3 | 1199 (2) | | | | | | | | |
| MTCP-100-3BD18C ⁽²⁾⁽³⁾ | <---> | | | | | 1236 (2) | | | | | | | | |
| MTCP-125-3BD18 ⁽²⁾⁽³⁾ | <---> | 125 ⁽³⁾ | 444T | 2 | 285.2 / 142.6 | 1500 (2) | | | | | | | | |
| MTCP-150-3BD18 ⁽²⁾⁽³⁾ | <---> | 150 ⁽³⁾ | 445T | 4 | 342 / 171 | 1630 (2) | | | | | | | | |
| MTCP-200-3BD18 ⁽²⁾⁽³⁾ | <---> | 200 ⁽³⁾ | 445/7T | | | 2127 (2) | | | | | | | | |
| MTCP-250-3D18 ⁽²⁾⁽³⁾⁽⁴⁾ | <---> | 250 ⁽³⁾ | 1800 | 3 | 460 | TEFC | 449T | F1 | 1.15 | | - / 282 | 2508 (2) | | |
| MTCP-300-3D18 ⁽²⁾⁽³⁾⁽⁴⁾ | <---> | 300 ⁽³⁾ | | | | | | | | | - / 334 | 2728 (2) | | |

- 1) F1(F2) indicates F1 conduit box mounting location, field convertible to F2 (as shown on dimensional diagram).
- 2) For shipping weights over 100 lbs: A) LTL shipment required. B) Order before 5:00 p.m. EST for same day shipment. C) You must have a receiving loading dock. D) Not available in Hawaii or Puerto Rico. Please review AutomationDirect Terms & Conditions for shipping information on this product.
- 3) For warranty on motors 50 hp and above, motors must be inspected by an EASA motor repair or service center. Please review AutomationDirect Terms & Conditions for warranty and service on this product.
- 4) Premium Efficiency standards not applicable for MTC motors over 200 hp⁽⁴⁾.

IronHorse® MTCP Premium Efficiency Cast-Iron Three-Phase AC Motors

T-Frame TEFC Motors – Three-Phase Industrial Duty – 1–20 hp – 1200 & 3600 rpm

| Motor Specifications – Premium Efficiency T-Frame Three-Phase Motors – 1200 rpm | | | | | | | | | | | | |
|---|-------|-----|----------|-------|-------------|----------------|------------|-------------------------|--------------|----------------|----------------------|----------------------------|
| Part Number | Price | HP | Base RPM | Phase | Voltage | Housing | NEMA Frame | Mounting ⁽¹⁾ | Holes / Foot | Service Factor | F.L. Amps @230V/460V | Approx Product Weight (lb) |
| MTCP-001-3BD12 | <---> | 1 | 1200 | 3 | 208-230/460 | TEFC cast iron | 145T | F1(F2) | 4 | 1.15 | 3.2 / 1.6 | 60 |
| MTCP-1P5-3BD12 | <---> | 1.5 | | | | | 182T | | 2 | | 4.5 / 2.2 | 104 ⁽²⁾ |
| MTCP-002-3BD12 | <---> | 2 | | | | | 184T | | 4 | | 5.7 / 2.9 | 110 ⁽²⁾ |
| MTCP-003-3BD12 ⁽²⁾ | <---> | 3 | | | | | 213T | | 2 | | 8.5 / 4.2 | 160 ⁽²⁾ |
| MTCP-005-3BD12 ⁽²⁾ | <---> | 5 | | | | | 215T | | 4 | | 13.8 / 6.9 | 180 ⁽²⁾ |
| MTCP-7P5-3BD12 ⁽²⁾ | <---> | 7.5 | | | | | 254T | | 2 | | 20.9 / 10.4 | 325 ⁽²⁾ |
| MTCP-010-3BD12 ⁽²⁾ | <---> | 10 | | | | | 256T | | 4 | | 27.8 / 13.9 | 325 ⁽²⁾ |
| MTCP-015-3BD12 ⁽²⁾ | <---> | 15 | | | | | 284T | | 2 | | 40.3 / 20.2 | 420 ⁽²⁾ |
| MTCP-020-3BD12 ⁽²⁾ | <---> | 20 | | | | | 286T | | 4 | | 52.4 / 26.2 | 470 ⁽²⁾ |

1) F1(F2) indicates F1 conduit box mounting location, field convertible to F2 (as shown on dimensional diagram).
 Notes 2 & 3: Please review the AutomationDirect Terms & Conditions for warranty and service on this product.
 2) For shipping weights over 100 lbs: A) LTL shipment required. B) Order before 5:00 p.m. EST for same day shipment. C) You must have a receiving loading dock. D) Not available in Hawaii or Puerto Rico.
 3) For warranty on motors 50 hp and above, motors must be inspected by an EASA motor repair or service center.

| Motor Specifications – Premium Efficiency T-Frame Three-Phase Motors – 3600 rpm | | | | | | | | | | | | |
|---|-------|-----|----------|-------|-------------|----------------|------------|-------------------------|--------------|----------------|----------------------|----------------------------|
| Part Number | Price | HP | Base RPM | Phase | Voltage | Housing | NEMA Frame | Mounting ⁽¹⁾ | Holes / Foot | Service Factor | F.L. Amps @230V/460V | Approx Product Weight (lb) |
| MTCP-1P5-3BD36 | <---> | 1.5 | 3600 | 3 | 208-230/460 | TEFC cast iron | 143T | F1(F2) | 2 | 1.15 | 4.08 / 2.04 | 44 |
| MTCP-002-3BD36 | <---> | 2 | | | | | 145T | | 4 | | 5.4 / 2.7 | 53 |
| MTCP-003-3BD36 ⁽²⁾ | <---> | 3 | | | | | 182T | | 2 | | 7.74 / 3.87 | 79 ⁽²⁾ |
| MTCP-005-3BD36 ⁽²⁾ | <---> | 5 | | | | | 184T | | 4 | | 12.6 / 6.3 | 92 ⁽²⁾ |
| MTCP-7P5-3BD36 ⁽²⁾ | <---> | 7.5 | | | | | 213T | | 2 | | 18.46 / 9.23 | 140 ⁽²⁾ |
| MTCP-010-3BD36 ⁽²⁾ | <---> | 10 | | | | | 215T | | 4 | | 24.4 / 12.2 | 161 ⁽²⁾ |
| MTCP-015-3BD36 ⁽²⁾ | <---> | 15 | | | | | 254T | | 2 | | 35.0 / 17.5 | 278 ⁽²⁾ |
| MTCP-020-3BD36 ⁽²⁾ | <---> | 20 | | | | | 256T | | 4 | | 46.4 / 23.2 | 306 ⁽²⁾ |

1) F1(F2) indicates F1 conduit box mounting location, field convertible to F2 (as shown on dimensional diagram).
 Notes 2 & 3: Please review the AutomationDirect Terms & Conditions for warranty and service on this product.
 2) For shipping weights over 100 lbs: A) LTL shipment required. B) Order before 5:00 p.m. EST for same day shipment. C) You must have a receiving loading dock. D) Not available in Hawaii or Puerto Rico.
 3) For warranty on motors 50 hp and above, motors must be inspected by an EASA motor repair or service center.

IronHorse® MTCP Premium Efficiency Cast-Iron Three-Phase AC Motors

T-Frame TEFC Motors – Three-Phase Industrial Duty – 1–200 hp⁽²⁾

TC-Frame (C-Face) TEFC Motors – Three-Phase Industrial Duty – 1–100 hp

| Performance Data – T & TC Frame Three-Phase MTCP Motors (460 Volt except as indicated) – 1200, 1800, 3600 rpm | | | | | | | | | | | | | | | | | |
|---|-----|-------------|----------------|---------------------|-----|---------------|----------------------------|-------------|--------------|----------------|--------------|------------|---------------------|-------|-------------------|-------------------|--------------------------------------|
| Part Number | HP | NEMA Design | FL RPM | Minimum Speed (rpm) | | | Current @ 230V/460V (Amps) | | | Torque (lb-ft) | | | Maximum Speed (rpm) | | FL Efficiency (%) | F.L. Power Factor | Rotor Inertia (lb.-ft ²) |
| | | | | CT | VT | | No Load | Full Load | Locked Rotor | Full Load | Locked Rotor | Break-down | CHP(1) | Safe | | | |
| MTCP-001-3BD12 | 1 | B | 1162 | 300 | 120 | 2.5 / 1.25 | 3.2 / 1.6 | 30 / 15 | 4.5 | 10.8 | 14.4 | 1800 | 3600 | 82.5 | 0.72 | 0.33 | |
| MTCP-001-3BD18(C) | | | 1750 | 450 | 180 | 2.28 / 1.14 | 3.22 / 1.61 | 30.0 / 15.0 | 3.00 | 9.00 | 11.4 | 2700 | 5400 | 86.3 | 0.690 | 0.089 | |
| MTCP-1P5-3BD12 | 1.5 | B | 1180 | 300 | 120 | 3.2 / 1.6 | 4.5 / 2.2 | 40 / 20 | 6.68 | 15.36 | 21.38 | 1800 | 3600 | 87.5 | 0.72 | 0.36 | |
| MTCP-1P5-3BD18(C) | | | 1750 | 450 | 180 | 3.12 / 1.56 | 4.64 / 2.32 | 40.0 / 20.0 | 4.5 | 9.0 | 14.0 | 2700 | 5400 | 87.3 | 0.726 | 0.11 | |
| MTCP-1P5-3BD36 | 1.5 | B | 3570 | 900 | 360 | 2.0 / 1.0 | 4.08 / 2.04 | 40.0 / 20.0 | 2.2 | 6.4 | 7.9 | 5400 | 5400 | 85.5 | 0.828 | 0.078 | |
| MTCP-002-3BD12 | | | 1180 | 300 | 120 | 4.2 / 2.1 | 5.7 / 2.9 | 50.0 / 25.0 | 8.61 | 20.66 | 29.88 | 1800 | 3600 | 88.5 | 0.74 | 0.47 | |
| MTCP-002-3BD18(C) | 2 | B | 1750 | 450 | 180 | 3.6 / 1.8 | 6.0 / 3.0 | 50.0 / 25.0 | 6.0 | 17.4 | 19.2 | 2700 | 5400 | 87.3 | 0.725 | 0.13 | |
| MTCP-002-3BD36 | | | 3520 | 900 | 360 | 3.14 / 1.57 | 5.4 / 2.7 | 50.0 / 25.0 | 3.0 | 9.0 | 12.0 | 5400 | 5400 | 86.6 | 0.821 | 0.098 | |
| MTCP-003-3BD12 | 3 | B | 1180 | 300 | 120 | 6.4 / 3.2 | 8.5 / 4.2 | 68.0 / 34.0 | 13.36 | 29.39 | 40.08 | 1800 | 3600 | 89.5 | 0.74 | 0.50 | |
| MTCP-003-3BD18(C) | | | 1750 | 450 | 180 | 4.1 / 2.05 | 8.05 / 4.02 | 64.0 / 32.0 | 9.0 | 20.7 | 25.2 | 2700 | 5400 | 90.3 | 0.786 | 0.28 | |
| MTCP-003-3BD36 | 3 | B | 3520 | 900 | 360 | 3.9 / 1.95 | 7.74 / 3.87 | 64.0 / 32.0 | 4.48 | 12.54 | 17.02 | 5400 | 5400 | 87.0 | 0.845 | 0.195 | |
| MTCP-005-3BD12 | | | 1180 | 300 | 120 | 9.2 / 4.6 | 13.8 / 6.9 | 92 / 46 | 22.2 | 48.8 | 66.6 | 1800 | 3600 | 89.5 | 0.76 | 1.97 | |
| MTCP-005-3BD18(C) | 5 | B | 1750 | 450 | 180 | 6.2 / 3.1 | 13.41 / 6.71 | 92.0 / 46.0 | 15.0 | 34.5 | 43.5 | 2700 | 5400 | 90.3 | 0.786 | 0.33 | |
| MTCP-005-3BD36 | | | 3570 | 900 | 360 | 5.2 / 2.6 | 12.6 / 6.3 | 92.0 / 46.0 | 7.36 | 16.19 | 22.82 | 5400 | 5400 | 89.0 | 0.841 | 0.22 | |
| MTCP-7P5-3BD12 | 7.5 | B | 1180 | 300 | 120 | 12.0 / 6.0 | 20.9 / 10.4 | 127 / 63.5 | 33.4 | 76.8 | 116.9 | 1800 | 3600 | 91.1 | 0.74 | 2.74 | |
| MTCP-7P5-3BD18(C) | | | 1760 | 450 | 180 | 8.44 / 4.22 | 18.68 / 9.34 | 127 / 63.5 | 22.4 | 44.8 | 69.4 | 2700 | 5400 | 91.8 | 0.825 | 1.814 | |
| MTCP-7P5-3BD36 | 7.5 | B | 3520 | 900 | 360 | 6.66 / 3.33 | 18.46 / 9.23 | 127 / 63.5 | 11.2 | 28.0 | 34.7 | 5400 | 5400 | 89.7 | 0.851 | 0.501 | |
| MTCP-010-3BD12 | | | 1180 | 300 | 120 | 10.8 / 5.4 | 27.8 / 13.9 | 162 / 81 | 44.5 | 97.9 | 106.8 | 1800 | 3600 | 91.0 | 0.74 | 2.98 | |
| MTCP-010-3BD18(C) | 10 | B | 1750 | 450 | 180 | 10.54 / 5.27 | 24.9 / 12.45 | 163 / 81.5 | 30.0 | 61.5 | 93.0 | 2700 | 4200 | 92.5 | 0.826 | 1.97 | |
| MTCP-010-3BD36 | | | 3550 | 900 | 360 | 8.76 / 4.38 | 24.4 / 12.2 | 163 / 81.5 | 14.8 | 37.0 | 50.3 | 5400 | 5400 | 90.3 | 0.851 | 1.2 | |
| MTCP-015-3BD12 | 15 | B | 1180 | 300 | 120 | 18.0 / 9.0 | 40.3 / 20.2 | 232 / 116 | 60.23 | 132.51 | 174.67 | 1800 | 3600 | 91.7 | 0.76 | 5.49 | |
| MTCP-015-3BD18(C) | | | 1750 | 450 | 180 | 15.4 / 7.7 | 35.8 / 17.9 | 232 / 116 | 45 | 92 | 126 | 2700 | 4200 | 92.5 | 0.890 | 3.33 | |
| MTCP-015-3BD36 | 15 | B | 3550 | 900 | 360 | 12 / 6 | 35.0 / 17.5 | 232 / 116 | 22.2 | 46.6 | 64.4 | 5400 | 5400 | 91.2 | 0.852 | 1.86 | |
| MTCP-020-3BD12 | | | 1180 | 300 | 120 | 17.8 / 8.9 | 52.4 / 26.2 | 290 / 145 | 89.1 | 196.0 | 258.4 | 1800 | 3600 | 91.7 | 0.78 | 12.9 | |
| MTCP-020-3BD18(C) | 20 | B | 1770 | 450 | 180 | 17.11 / 8.56 | 47.94 / 23.97 | 290 / 145 | 59.4 | 118.8 | 166.3 | 2700 | 4200 | 93.8 | 0.846 | 4.09 | |
| MTCP-020-3BD36 | | | 3570 | 900 | 360 | 15 / 7.5 | 46.4 / 23.2 | 290 / 145 | 29.4 | 61.7 | 85.3 | 5400 | 5400 | 91.2 | 0.851 | 2.01 | |
| MTCP-025-3BD18(C) | 25 | B | 1770 | 450 | 180 | 24 / 12 | 59.6 / 29.8 | 365 / 182.5 | 74.2 | 155.8 | 185.5 | 2700 | 4200 | 93.6 | 0.860 | 7.01 | |
| MTCP-030-3BD18(C) | 30 | | 27 / 13.5 | | | 69.96 / 34.98 | 435 / 217.5 | 88.6 | 203.8 | 248.1 | 93.7 | | | 0.846 | 8.3 | | |
| MTCP-040-3BD18(C) | 40 | | 29.6 / 14.8 | | | 94.76 / 47.38 | 580 / 290 | 118.1 | 248.0 | 271.6 | 94.4 | | | 0.850 | 9 | | |
| MTCP-050-3BD18(C) | 50 | | 36.2 / 18.1 | | | 116.8 / 58.4 | 725 / 362.5 | 148 | 326 | 414 | 94.5 | | | 0.855 | 14.1 | | |
| MTCP-060-3BD18(C) | 60 | | 45.6 / 22.8 | | | 139.3 / 69.6 | 870 / 435 | 179 | 376 | 519 | 95.0 | | | 0.850 | 16.27 | | |
| MTCP-075-3BD18(C) | 75 | | 58.4 / 29.2 | | | 173.4 / 86.7 | 1085 / 542.5 | 221 | 464 | 619 | 95.4 | | | 0.850 | 18.8 | | |
| MTCP-100-3BD18(C) | 100 | | 75 / 37.5 | | | 228.6 / 114.3 | 1450 / 725 | 293.2 | 645.0 | 703.7 | 95.4 | | | 0.860 | 45.5 | | |
| MTCP-125-3BD18 | 125 | | 94.54 / 47.27 | | | 285.2 / 142.6 | 1816 / 908 | 367 | 624 | 918 | 95.4 | | | 0.860 | 65.1 | | |
| MTCP-150-3BD18 | 150 | | 104.4 / 52.2 | | | 342 / 171 | 2170 / 1085 | 443 | 797 | 1108 | 95.8 | | | 0.860 | 69.26 | | |
| MTCP-200-3BD18 | 200 | | 133.26 / 66.63 | | | 453.2 / 226.6 | 2900 / 1450 | 587 | 1174 | 1644 | 96.3 | | | 0.860 | 84.0 | | |
| MTC-250-3D18 (2) | 250 | B | 1790 | 900 | 360 | - / 85.6 | - / 282 | - / 1980 | 728 | 1660 | 2402 | 2700 | 4200 | 95.9 | 0.87 | 86.000 | |
| MTC-300-3D18 (2) | 300 | | | | | - / 96.6 | - / 334 | - / 2351 | 864 | 1953 | 2817 | | | 95.7 | 0.88 | 105.000 | |

1) Maximum Constant HP RPM is for direct coupled loads.

2) Premium Efficiency standards not applicable for MTC motors over 200 hp⁽²⁾.

IronHorse® MTCP Premium Efficiency Cast-Iron Three-Phase AC Motors

T-Frame TEFC Motors – Three-Phase Industrial Duty – 1 to 200 hp⁽¹⁾

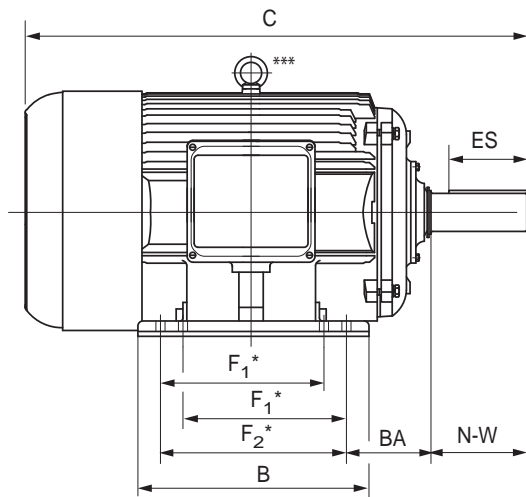

* Various frame sizes have 2 or 4 mounting holes per mounting foot (one mounting foot per side).

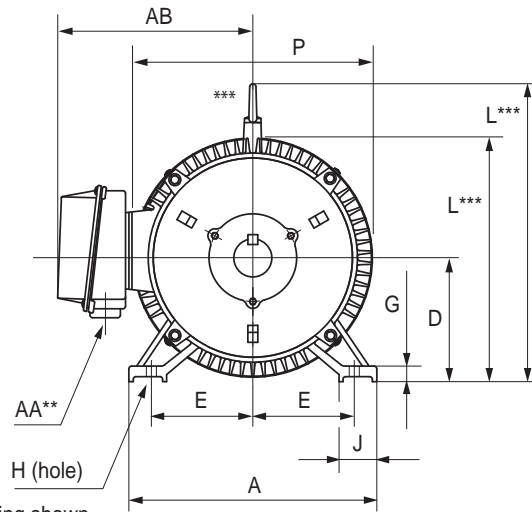
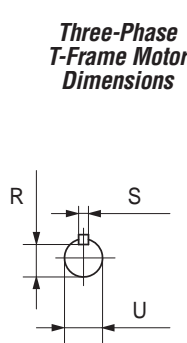

** F1 mounting shown.
** Some frame sizes are F1/F2 convertible.
*** Frames 143T & 145T have no lifting eyelet.

Dimensions [inches, except as noted] – Premium Efficiency T-Frame Three-Phase Motors – 1800 rpm

| Part Number | HP | NEMA Frame | A | AA** | AB | B | BA | C | D | E | ES | F ₁ * | F ₂ * | G | H | J | N-W | L | P | R | S | U |
|------------------------|-----|------------|------|----------|------|------|------|-------|------|------|------|------------------|------------------|-------|------|------|------|-------|------|-------|-------|-------|
| 1800 rpm Motors | | | | | | | | | | | | | | | | | | | | | | |
| MTCP-001-3BD18 | 1 | 143T | 7 | 3/4"NPT | 6.89 | 5.1 | 2.25 | 12.47 | 3.5 | 2.75 | 1.41 | n/a | 4 | 0.47 | 0.34 | 1.45 | 2.25 | 6.90 | 7.2 | 0.771 | 0.188 | 0.875 |
| MTCP-1P5-3BD18 | 1.5 | 145T | 7 | 3/4"NPT | 6.89 | 6.1 | 2.25 | 13.47 | 3.5 | 2.75 | 1.41 | 4 | 5 | 0.47 | 0.34 | 1.45 | 2.25 | 6.90 | 7.2 | 0.771 | 0.188 | 0.875 |
| MTCP-002-3BD18 | 2 | | 7 | 3/4"NPT | 6.89 | 6.1 | 2.25 | 13.47 | 3.5 | 2.75 | 1.41 | 4 | 5 | 0.47 | 0.34 | 1.45 | 2.25 | 6.90 | 7.2 | 0.771 | 0.188 | 0.875 |
| MTCP-003-3BD18 | 3 | 182T | 8.9 | 1" NPT | 7.45 | 6.3 | 2.75 | 15.11 | 4.5 | 3.75 | 1.78 | n/a | 4.5 | 0.52 | 0.41 | 1.97 | 2.75 | 10.39 | 9.0 | 0.986 | 0.25 | 1.125 |
| MTCP-005-3BD18 | 5 | 184T | 8.9 | 1" NPT | 7.45 | 7.1 | 2.75 | 16.12 | 4.5 | 3.75 | 1.78 | 4.5 | 5.5 | 0.52 | 0.41 | 1.97 | 2.75 | 10.39 | 9.0 | 0.986 | 0.25 | 1.125 |
| MTCP-7P5-3BD18 | 7.5 | 213T | 10.5 | 1" NPT | 8.63 | 7.5 | 3.5 | 18.89 | 5.25 | 4.25 | 2.41 | n/a | 5.5 | 0.78 | 0.41 | 2.36 | 3.38 | 12.26 | 10.8 | 1.201 | 0.312 | 1.375 |
| MTCP-010-3BD18 | 10 | 215T | 10.5 | 1" NPT | 8.63 | 9 | 3.5 | 20.49 | 5.25 | 4.25 | 2.41 | 5.5 | 7 | 0.78 | 0.41 | 2.36 | 3.38 | 12.26 | 10.8 | 1.201 | 0.312 | 1.375 |
| MTCP-015-3BD18 | 15 | 254T | 12.3 | 1.5" NPT | 12.0 | 10.3 | 4.25 | 23.29 | 6.25 | 5 | 2.91 | n/a | 8.25 | 0.87 | 0.53 | 2.40 | 4 | 15.10 | 14.4 | 1.416 | 0.375 | 1.625 |
| MTCP-020-3BD18 | 20 | 256T | 12.3 | 1.5" NPT | 12.0 | 12.4 | 4.25 | 25.06 | 6.25 | 5 | 2.91 | 8.25 | 10 | 0.87 | 0.53 | 2.40 | 4 | 15.10 | 14.4 | 1.416 | 0.375 | 1.625 |
| MTCP-025-3BD18 | 25 | 284T | 13.7 | 1.5" NPT | 13.7 | 12.2 | 4.75 | 26.63 | 7 | 5.5 | 3.28 | n/a | 9.5 | 0.98 | 0.53 | 2.68 | 4.62 | 16.50 | 16.0 | 1.591 | 0.5 | 1.875 |
| MTCP-030-3BD18 | 30 | 286T | 13.7 | 1.5" NPT | 13.7 | 13.7 | 4.75 | 28.18 | 7 | 5.5 | 3.28 | 9.5 | 11 | 0.98 | 0.53 | 2.68 | 4.62 | 16.50 | 16.0 | 1.591 | 0.5 | 1.875 |
| MTCP-040-3BD18 | 40 | 324T | 15.3 | 2"NPT | 14.6 | 12.6 | 5.25 | 29.95 | 8 | 6.25 | 3.91 | n/a | 10.5 | 0.98 | 0.66 | 2.76 | 5.25 | 18.25 | 17.8 | 1.845 | 0.5 | 2.125 |
| MTCP-050-3BD18 | 50 | 326T | 15.3 | 2"NPT | 14.6 | 14.0 | 5.25 | 31.24 | 8 | 6.25 | 3.91 | 10.5 | 12 | 0.98 | 0.66 | 2.76 | 5.25 | 18.25 | 17.8 | 1.845 | 0.5 | 2.125 |
| MTCP-060-3BD18 | 60 | 364T | 17.0 | 3"NPT | 17.6 | 14.6 | 5.88 | 32.58 | 9 | 7 | 4.28 | n/a | 11.25 | 1.10 | 0.66 | 3.15 | 5.88 | 21.0 | 19.4 | 2.021 | 0.625 | 2.375 |
| MTCP-075-3BD18 | 75 | 365T | 17.0 | 3"NPT | 17.6 | 15.6 | 5.88 | 34.11 | 9 | 7 | 4.28 | 11.25 | 12.25 | 1.10 | 0.66 | 3.15 | 5.88 | 21.0 | 19.4 | 2.021 | 0.625 | 2.375 |
| MTCP-100-3BD18 | 100 | 405T | 20 | 3"NPT | 18.1 | 17.8 | 6.62 | 38.35 | 10 | 8 | 5.65 | 12.25 | 13.75 | 1.18 | 0.81 | 3.15 | 7.25 | 23.46 | 21.4 | 2.45 | 0.75 | 2.875 |
| MTCP-125-3BD18 | 125 | 444T | 22 | 2x3"NPT | 19.1 | 18.5 | 7.5 | 42.52 | 11 | 9 | 6.91 | n/a | 14.5 | 1.38 | 0.81 | 3.35 | 8.5 | 26.43 | 23.4 | 2.88 | 0.875 | 3.375 |
| MTCP-150-3BD18 | 150 | 445T | 22 | 2x3"NPT | 19.1 | 20.5 | 7.5 | 44.5 | 11 | 9 | 6.91 | 14.5 | 16.5 | 1.38 | 0.81 | 3.35 | 8.5 | 26.43 | 23.4 | 2.88 | 0.875 | 3.375 |
| MTCP-200-3BD18 | 200 | 445/7T | 22 | 2x3"NPT | 19.1 | 24 | 7.5 | 48.03 | 11 | 9 | 6.91 | 16.5 | 20 | 1.38 | 0.81 | 3.35 | 8.5 | 26.43 | 23.4 | 2.88 | 0.875 | 3.375 |
| MTCP-250-3D18 (1) | 250 | 449T | 22 | 2x3"NPT | 19.1 | 31 | 7.5 | 55.51 | 11 | 9 | 7.01 | n/a | 25 | 1.575 | 0.81 | 3.35 | 8.5 | 27.25 | 24 | 2.88 | 0.875 | 3.375 |
| MTCP-300-3D18 (1) | 300 | | | | | | | | | | | | | | | | | | | | | |

* Various frame sizes have 2 or 4 mounting holes per mounting foot.
** AA dimension is conduit fitting size.
F1 mounting shown; some frame sizes are F1/F2 convertible; refer to T Frame "Motor Specifications" table.
(F2 mounting = conduit entrance on right side facing shaft.)
*** Frame sizes 143T(C) and 145T(C) have no lifting eyelet.
1) Premium Efficiency standards not applicable for MTC motors over 200 hp⁽¹⁾.

IronHorse® MTCP Premium Efficiency Cast-Iron Three-Phase AC Motors

T-Frame TEFC Motors – Three-Phase Industrial Duty – Dimensions

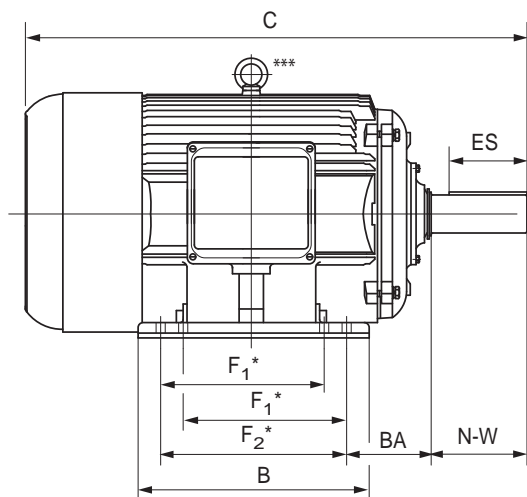

* Various frame sizes have 2 or 4 mounting holes per mounting foot (one mounting foot per side).

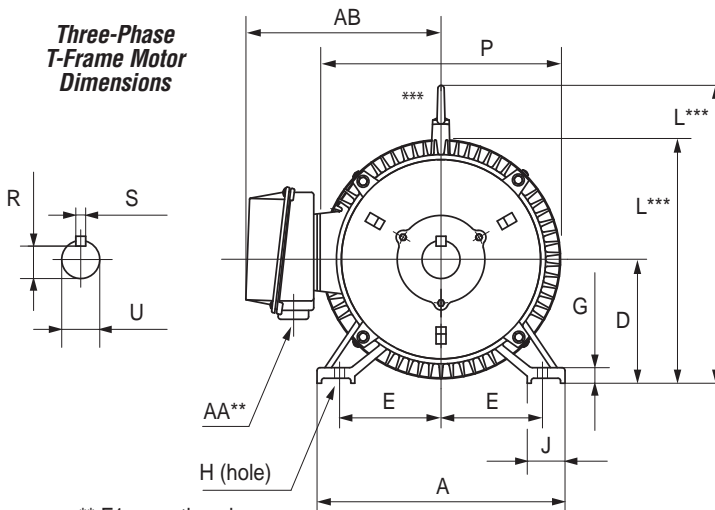

** F1 mounting shown.
** Some frame sizes are F1/F2 convertible.
*** Frames 143T & 145T have no lifting eyelet.

Dimensions [inches, except as noted] – Premium Efficiency T-Frame Three-Phase Motors – 1200 & 3600 rpm

| Part Number | HP | NEMA Frame | A | AA** | AB | B | BA | C | D | E | ES | F1* | F2* | G | H | J | N-W | L | P | R | S | U |
|------------------------|-------|------------|------|---------|------|------|------|-------|------|------|------|------|------|------|------|------|------|-------|------|-------|-------|-------|
| 1200 rpm Motors | | | | | | | | | | | | | | | | | | | | | | |
| MTCP-001-3BD12 | 1 | 145T | 7 | 3/4"NPT | 6.89 | 6.1 | 2.25 | 13.47 | 3.5 | 2.75 | 1.41 | 4 | 5 | 0.47 | 0.34 | 1.45 | 2.25 | 6.90 | 7.2 | 0.771 | 0.188 | 0.875 |
| MTCP-1P5-3BD12 | 1-1/2 | 182T | 8.9 | 1"NPT | 7.45 | 6.3 | 2.75 | 15.11 | 4.5 | 3.75 | 1.78 | n/a | 4.5 | 0.52 | 0.41 | 1.97 | 2.75 | 10.39 | 9.0 | 0.986 | 0.25 | 1.125 |
| MTCP-002-3BD12 | 2 | 184T | 8.9 | 1"NPT | 7.45 | 7.1 | 2.75 | 16.12 | 4.5 | 3.75 | 1.78 | 4.5 | 5.5 | 0.52 | 0.41 | 1.97 | 2.75 | 10.39 | 9.0 | 0.986 | 0.25 | 1.125 |
| MTCP-003-3BD12 | 3 | 213T | 10.5 | 1"NPT | 8.63 | 7.5 | 3.5 | 18.89 | 5.25 | 4.25 | 2.41 | n/a | 5.5 | 0.78 | 0.41 | 2.36 | 3.38 | 12.26 | 10.8 | 1.201 | 0.312 | 1.375 |
| MTCP-005-3BD12 | 5 | 215T | 10.5 | 1"NPT | 8.63 | 9 | 3.5 | 20.49 | 5.25 | 4.25 | 2.41 | 5.5 | 7 | 0.78 | 0.41 | 2.36 | 3.38 | 12.26 | 10.8 | 1.201 | 0.312 | 1.375 |
| MTCP-7P5-3BD12 | 7-1/2 | 254T | 12.3 | 1.5"NPT | 12.0 | 10.3 | 4.25 | 23.29 | 6.25 | 5 | 2.91 | n/a | 8.25 | 0.87 | 0.53 | 2.40 | 4 | 15.10 | 14.4 | 1.416 | 0.375 | 1.625 |
| MTCP-010-3BD12 | 10 | 256T | 12.3 | 1.5"NPT | 12.0 | 12.4 | 4.25 | 25.06 | 6.25 | 5 | 2.91 | 8.25 | 10 | 0.87 | 0.53 | 2.40 | 4 | 15.10 | 14.4 | 1.416 | 0.375 | 1.625 |
| MTCP-015-3BD12 | 15 | 284T | 13.7 | 1.5"NPT | 13.7 | 12.2 | 4.75 | 26.63 | 7 | 5.5 | 3.28 | n/a | 9.5 | 0.98 | 0.53 | 2.68 | 4.62 | 16.50 | 16.0 | 1.591 | 0.5 | 1.875 |
| MTCP-020-3BD12 | 20 | 286T | 13.7 | 1.5"NPT | 13.7 | 13.7 | 4.75 | 28.18 | 7 | 5.5 | 3.28 | 9.5 | 11 | 0.98 | 0.53 | 2.68 | 4.62 | 16.50 | 16.0 | 1.591 | 0.5 | 1.875 |
| 3600 rpm Motors | | | | | | | | | | | | | | | | | | | | | | |
| MTCP-1P5-3BD36 | 1-1/2 | 143T | 7 | 3/4"NPT | 6.89 | 5.1 | 2.25 | 12.47 | 3.5 | 2.75 | 1.41 | n/a | 4 | 0.47 | 0.34 | 1.45 | 2.25 | 6.90 | 7.2 | 0.771 | 0.188 | 0.875 |
| MTCP-002-3BD36 | 2 | 145T | 7 | 3/4"NPT | 6.89 | 6.1 | 2.25 | 13.47 | 3.5 | 2.75 | 1.41 | 4 | 5 | 0.47 | 0.34 | 1.45 | 2.25 | 6.90 | 7.2 | 0.771 | 0.188 | 0.875 |
| MTCP-003-3BD36 | 3 | 182T | 8.9 | 1"NPT | 7.45 | 6.3 | 2.75 | 15.11 | 4.5 | 3.75 | 1.78 | n/a | 4.5 | 0.52 | 0.41 | 1.97 | 2.75 | 10.39 | 9.0 | 0.986 | 0.25 | 1.125 |
| MTCP-005-3BD36 | 5 | 184T | 8.9 | 1"NPT | 7.45 | 7.1 | 2.75 | 16.12 | 4.5 | 3.75 | 1.78 | 4.5 | 5.5 | 0.52 | 0.41 | 1.97 | 2.75 | 10.39 | 9.0 | 0.986 | 0.25 | 1.125 |
| MTCP-7P5-3BD36 | 7-1/2 | 213T | 10.5 | 1"NPT | 8.63 | 7.5 | 3.5 | 18.89 | 5.25 | 4.25 | 2.41 | n/a | 5.5 | 0.78 | 0.41 | 2.36 | 3.38 | 12.26 | 10.8 | 1.201 | 0.312 | 1.375 |
| MTCP-010-3BD36 | 10 | 215T | 10.5 | 1"NPT | 8.63 | 9 | 3.5 | 20.49 | 5.25 | 4.25 | 2.41 | 5.5 | 7 | 0.78 | 0.41 | 2.36 | 3.38 | 12.26 | 10.8 | 1.201 | 0.312 | 1.375 |
| MTCP-015-3BD36 | 15 | 254T | 12.3 | 1.5"NPT | 12.0 | 10.3 | 4.25 | 23.29 | 6.25 | 5 | 2.91 | n/a | 8.25 | 0.87 | 0.53 | 2.40 | 4 | 15.10 | 14.4 | 1.416 | 0.375 | 1.625 |
| MTCP-020-3BD36 | 20 | 256T | 12.3 | 1.5"NPT | 12.0 | 12.4 | 4.25 | 25.06 | 6.25 | 5 | 2.91 | 8.25 | 10 | 0.87 | 0.53 | 2.40 | 4 | 15.10 | 14.4 | 1.416 | 0.375 | 1.625 |

* Various frame sizes have 2 or 4 mounting holes per mounting foot.
** AA dimension is conduit fitting size.
F1 mounting shown; some frame sizes are F1/F2 convertible; refer to T Frame "Motor Specifications" table.
(F2 mounting = conduit entrance on right side facing shaft.)
*** Frame sizes 143T(C) and 145T(C) have no lifting eyelet.

IronHorse® MTCP Premium Efficiency Cast-Iron Three-Phase AC Motors

TC-Frame TEFC Motors – Three-Phase Industrial Duty – Dimensions

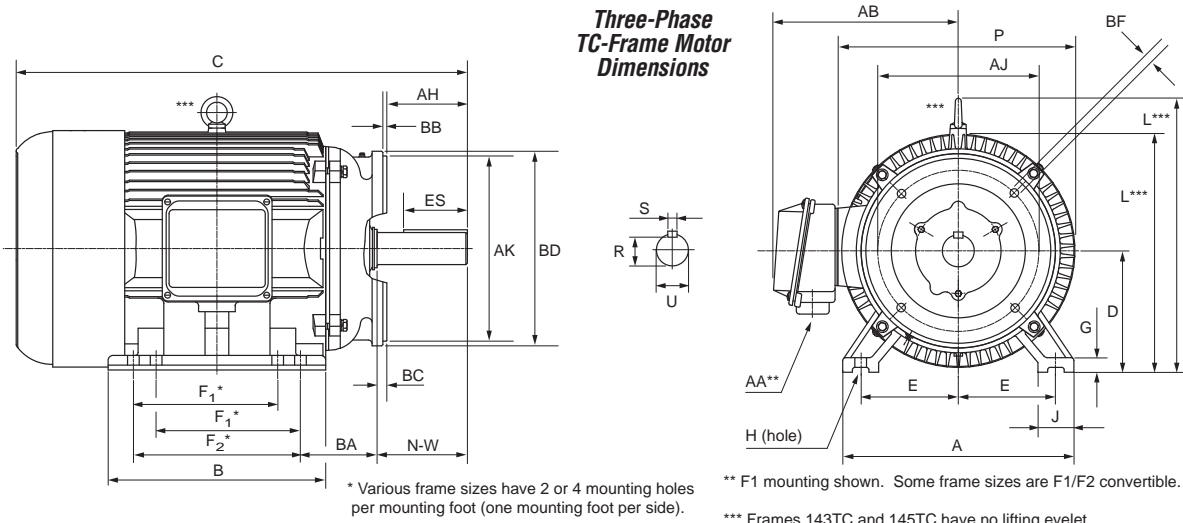

Dimensions [inches, except as noted] – Premium Efficiency TC-Frame Three-Phase Motors – 1800 rpm

| Part # MTCP- xxx 3BD18C | HP | NEMA Frame | A | AA** | AB | AH | AJ | AK | B | BA | BB | BC | BD | BF | C | D | E | ES | F ₁ * | F ₂ * | G | H | J | N-W | L | P | R | S | U |
|----------------------------------|-----|---------------|------|---------|------|------|-------|------|------|------|------|------|-------|--------|------|------|------|------|------------------|------------------|------|------|------|------|------|------|-------|-------|-------|
| -001- | 1 | 143TC | 7 | 3/4"NPT | 6.89 | 1.96 | 5.875 | 4.5 | 5.1 | 2.25 | 0.16 | 0.29 | 6.5 | 3/8-16 | 12.5 | 3.5 | 2.75 | 1.41 | n/a | 4 | 0.47 | 0.34 | 1.45 | 2.25 | 6.9 | 7.2 | 0.771 | 0.188 | 0.875 |
| -1P5- | 1.5 | 145TC | 7 | 3/4"NPT | 6.89 | 1.96 | 5.875 | 4.5 | 6 | 2.25 | 0.16 | 0.29 | 6.5 | 3/8-16 | 13.5 | 3.5 | 2.75 | 1.41 | 4 | 5 | 0.47 | 0.34 | 1.45 | 2.25 | 6.9 | 7.2 | 0.771 | 0.188 | 0.875 |
| -002- | 2 | | | | | | | | | | | | | | | | | | | | | | | | | | | | |
| -003- | 3 | 182TC | 8.9 | 1" NPT | 7.45 | 2.37 | 7.25 | 8.5 | 6.3 | 2.75 | 0.25 | 0.38 | 9 | 1/2-13 | 15.1 | 4.5 | 3.75 | 1.78 | n/a | 4.5 | 0.52 | 0.41 | 1.97 | 2.75 | 10.4 | 9.0 | 0.986 | 0.25 | 1.125 |
| -005- | 5 | 184TC | 8.9 | 1" NPT | 7.45 | 2.37 | 7.25 | 8.5 | 7.1 | 2.75 | 0.25 | 0.38 | 9 | 1/2-13 | 16.1 | 4.5 | 3.75 | 1.78 | 4.5 | 5.5 | 0.52 | 0.41 | 1.97 | 2.75 | 10.4 | 9.0 | 0.986 | 0.25 | 1.125 |
| -7P5- | 7.5 | 213TC | 10.5 | 1" NPT | 8.63 | 2.87 | 7.25 | 8.5 | 7.5 | 3.5 | 0.25 | 0.51 | 9 | 1/2-13 | 18.9 | 5.25 | 4.25 | 2.41 | n/a | 5.5 | 0.78 | 0.41 | 2.36 | 3.38 | 12.3 | 10.8 | 1.201 | 0.312 | 1.375 |
| -010- | 10 | 215TC | 10.5 | 1" NPT | 8.63 | 2.87 | 7.25 | 8.5 | 9 | 3.5 | 0.25 | 0.51 | 9 | 1/2-13 | 20.5 | 5.25 | 4.25 | 2.41 | 5.5 | 7 | 0.78 | 0.41 | 2.36 | 3.38 | 12.3 | 10.8 | 1.201 | 0.312 | 1.375 |
| -015- | 15 | 254TC | 12.3 | 1.5"NPT | 12.0 | 3.75 | 7.25 | 8.5 | 10.3 | 4.25 | 0.25 | 0.25 | 10 | 1/2-13 | 23.3 | 6.25 | 5 | 2.91 | n/a | 8.25 | 0.87 | 0.53 | 2.40 | 4 | 15.1 | 14.4 | 1.416 | 0.375 | 1.625 |
| -020- | 20 | 256TC | 12.3 | 1.5"NPT | 12.0 | 3.75 | 7.25 | 8.5 | 12.4 | 4.25 | 0.25 | 0.25 | 10 | 1/2-13 | 25.1 | 6.25 | 5 | 2.91 | 8.25 | 10 | 0.87 | 0.53 | 2.40 | 4 | 15.1 | 14.4 | 1.416 | 0.375 | 1.625 |
| -025- | 25 | 284TC | 13.7 | 1.5"NPT | 13.7 | 4.38 | 9 | 10.5 | 12.2 | 4.75 | 0.25 | 0.25 | 11.25 | 1/2-13 | 26.6 | 7 | 5.5 | 3.28 | n/a | 9.5 | 0.98 | 0.53 | 2.68 | 4.62 | 16.5 | 16.0 | 1.591 | 0.5 | 1.875 |
| -030- | 30 | 286TC | 13.7 | 1.5"NPT | 13.7 | 4.38 | 9 | 10.5 | 13.7 | 4.75 | 0.24 | 0.24 | 11.25 | 1/2-13 | 28.2 | 7 | 5.5 | 3.28 | 9.5 | 11 | 0.98 | 0.53 | 2.68 | 4.62 | 16.5 | 16.0 | 1.591 | 0.5 | 1.875 |
| -040- | 40 | 324TC | 15.3 | 2" NPT | 14.6 | 5 | 11 | 12.5 | 12.6 | 5.25 | 0.24 | 0.24 | 14 | 5/8-11 | 30.0 | 8 | 6.25 | 3.91 | n/a | 10.5 | 0.98 | 0.66 | 2.76 | 5.25 | 18.3 | 17.8 | 1.845 | 0.5 | 2.125 |
| -050- | 50 | 326TC | 15.3 | 2" NPT | 14.6 | 5 | 11 | 12.5 | 14.0 | 5.25 | 0.25 | 0.25 | 14 | 5/8-11 | 31.2 | 8 | 6.25 | 3.91 | 10.5 | 12 | 0.98 | 0.66 | 2.76 | 5.25 | 18.3 | 17.8 | 1.845 | 0.5 | 2.125 |
| -060- | 60 | 364TC | 17.0 | 3" NPT | 17.5 | 5.62 | 11 | 12.5 | 14.6 | 5.88 | 0.25 | 0.25 | 14 | 5/8-11 | 32.6 | 9 | 7 | 4.28 | n/a | 11.25 | 1.10 | 0.66 | 3.15 | 5.88 | 21.0 | 19.4 | 2.021 | 0.625 | 2.375 |
| -075- | 75 | 365TC | 17.0 | 3" NPT | 17.5 | 5.62 | 11 | 12.5 | 15.6 | 5.88 | 0.25 | 0.25 | 14 | 5/8-11 | 34.1 | 9 | 7 | 4.28 | 11.25 | 12.25 | 1.10 | 0.66 | 3.15 | 5.88 | 21.0 | 19.4 | 2.021 | 0.625 | 2.375 |
| -100- | 100 | 405TC | 20 | 3" NPT | 18.1 | 7 | 11 | 12.5 | 17.8 | 6.62 | 0.25 | 0.25 | 15.5 | 5/8-11 | 38.4 | 10 | 8 | 5.65 | 12.25 | 13.75 | 1.18 | 0.81 | 3.15 | 7.25 | 23.5 | 21.4 | 2.45 | 0.75 | 2.875 |

* Various frame sizes have 2 or 4 mounting holes per mounting foot.
 ** AA dimension is conduit fitting size.
 F1 mounting shown; some frame sizes are F1/F2 convertible; refer to T Frame "Motor Specifications" table.
 (F2 mounting = conduit entrance on right side facing shaft.)
 *** Frame sizes 143T(C) and 145T(C) have no lifting eyelet.

Dimensions [inches] - E-Act 449T-Frame Three-Phase Motor with C-Flange Kit Installed

| C-Flange Part Number | Motor Part Number | Frame Type | AH* | AJ | AK | BB | BC* | BD | BF | CC | N-W* |
|----------------------|-------------------|------------|-------|----|----|------|------|-------|--------|------|------|
| MTA-CFACE-449TC | MTC-250-3D18 | 449T | 8.248 | 14 | 16 | 0.26 | 0.26 | 17.72 | 5/8-11 | 4.35 | 8.5 |
| | MTC-300-3D18 | | | | | | | | | | |

* Motor dependent dimensions apply only to IronHorse MTC-xxx-3D18 motors. Refer to appropriate T-frame diagram for motor dimensions.

IronHorse® MTCP Premium Efficiency Cast-Iron 3-Phase AC Motor Accessories

Premium Efficiency TEFC T-Frame Three-Phase Motor C-Flange Kits – 1 to 200 hp

We stock Premium Efficiency NEMA cast iron T-frame motors from 1–200 hp, and TC-frame motors from 1–100 hp.

We also offer IronHorse cast iron C-flange kits which can be used for C-face mounting of our 1–200 hp IronHorse MTCP Premium Efficiency cast iron T-frame motors.

The kits are field installable and include the C-faces and bolts.



| MTCP Premium Efficiency T-frame Three-Phase Motor C-Flange Kits | | | | | |
|---|-------|-------------|--|--------------------------------------|----------------------|
| Part Number | Price | Fits Frame | Fits Motor Number ⁽²⁾ | Motor HP | Product Weight (lb) |
| MTAP-CFACE-140TC | <---> | 143T & 145T | MTCP-001-3BD12 MTCP-001-3BD18 MTCP-1P5-3BD18 MTCP-1P5-3BD36 MTCP-002-3BD18 MTCP-002-3BD36 | 1 1 1-1/2 1-1/2 2 2 | 6.8 |
| MTAP-CFACE-180TC | <---> | 182T & 184T | MTCP-1P5-3BD12 MTCP-002-3BD12 MTCP-003-3BD18 MTCP-003-3BD36 MTCP-005-3BD18 MTCP-005-3BD36 | 1-1/2 2 3 3 5 5 | 14.3 |
| MTAP-CFACE-210TC | <---> | 213T & 215T | MTCP-003-3BD12 MTCP-005-3BD12 MTCP-7P5-3BD18 MTCP-7P5-3BD36 MTCP-010-3BD18 MTCP-010-3BD36 | 3 5 7-1/2 7-1/2 10 10 | 13.8 |
| MTAP-CFACE-250TC | <---> | 254T & 256T | MTCP-7P5-3BD12 MTCP-010-3BD12 MTCP-015-3BD18 MTCP-015-3BD36 MTCP-020-3BD18 MTCP-020-3BD36 | 7-1/2 10 15 15 20 20 | 40.1 |
| MTAP-CFACE-280TC | <---> | 284T & 286T | MTCP-015-3BD12 MTCP-020-3BD12 MTCP-025-3BD18 MTCP-030-3BD18 | 15 20 25 30 | 44.0 |
| MTAP-CFACE-320TC | <---> | 324T & 326T | MTCP-040-3BD18 MTCP-050-3BD18 | 40 50 | 61.7 |
| MTAP-CFACE-360TC | <---> | 364T & 365T | MTCP-060-3BD18 MTCP-075-3BD18 | 60 75 | 70.5 |
| MTAP-CFACE-400TC⁽¹⁾ | <---> | 405T | MTCP-100-3BD18 | 100 | 136.6 ⁽¹⁾ |
| MTAP-CFACE-444TC⁽¹⁾ | <---> | 444T & 445T | MTCP-125-3BD18 MTCP-150-3BD18 | 125 150 | 143.2 ⁽¹⁾ |
| MTAP-CFACE-447TC⁽¹⁾ | <---> | 445/7T | MTCP-200-3BD18 | 200 | 144.4 ⁽¹⁾ |

1) For shipping weights over 100 lbs: A) LTL shipment required. B) Order before 5:00 p.m. EST for same day shipment. C) You must have a receiving loading dock. D) Not available in Hawaii or Puerto Rico.
2) MTA-CFACE C-flange kits will NOT fit MTC EPAct motors.

EPAct TEFC T-Frame Three-Phase Motor C-Flange Kits – 250 to 300 hp

We offer IronHorse cast iron C-flange kits which can be used for C-face mounting of our IronHorse cast iron 250–300 hp T-frame EPAct motors. The kits are field installable and include the C-faces and bolts.

(Premium Efficiency standards are not applicable for MTC motors over 200 hp.)

| EPAct T-frame Three-Phase Motor C-Flange Kits | | | | | |
|---|-------|------------|----------------------------------|------------|---------------------|
| Part Number | Price | Fits Frame | Fits Motor Number ⁽²⁾ | Motor HP | Product Weight (lb) |
| MTA-CFACE-449TC⁽¹⁾ | <---> | 449T | MTC-250-3D18 MTC-300-3D18 | 250 300 | 147 ⁽¹⁾ |

1) For shipping weights over 100 lbs: A) LTL shipment required. B) Order before 5:00 p.m. EST for same day shipment. C) You must have a receiving loading dock. D) Not available in Hawaii or Puerto Rico.
2) MTA-CFACE C-flange kits will NOT fit MTCP Premium Efficiency motors.

IronHorse® MTCP Premium Efficiency Cast-Iron AC Motor Replacement Parts

Premium Efficiency TEFC Three-Phase Motor Replacement Parts – 1 to 200 hp

We stock MTCP Premium Efficiency NEMA cast iron T-frame motors from 1–200 hp, and TC-frame motors from 1–100 hp.

We also offer IronHorse junction boxes, TEFC fans, and TEFC fan shrouds as direct replacement parts for these MTCP motors.

These replacement parts are field installable. Instructions included.



| MTCP Premium Efficiency Three-Phase Motor Replacement Parts | | | | | | |
|---|-------|-------------------------------------|------------|--|-------------------------|---------------------|
| Part Number ⁽¹⁾ | Price | Description ⁽²⁾⁽³⁾⁽⁴⁾ | Fits Frame | Fits PE Motor Number ⁽¹⁾ | Motor HP | Product Weight (lb) |
| MTAP-FAN-140 | <---> | Replacement Fan | 143 | MTCP-001-3BD12 MTCP-001-3BD18(C) | 1 | 0.3 |
| MTAP-SHROUD-140 | <---> | Replacement Fan Shroud | 145 | MTCP-1P5-3BD18(C) MTCP-1P5-3BD36 | 1-1/2 | 1.1 |
| MTAP-JBOX-140 | <---> | Replacement Junction Box | | MTCP-002-3BD18(C) MTCP-002-3BD36 | 2 | 2.6 |
| MTAP-FAN-180 | <---> | Replacement Fan | 182 & 184 | MTCP-1P5-3BD12 MTCP-002-3BD12 MTCP-003-3BD18(C) MTCP-003-3BD36 | 1-1/2 2 3 3 | 0.3 1.5 |
| MTAP-SHROUD-180 | <---> | Replacement Fan Shroud | | MTCP-005-3BD18(C) MTCP-005-3BD36 | 5 5 | 3.1 |
| MTAP-JBOX-180 | <---> | Replacement Junction Box | | | | |
| MTAP-FAN-210-2 | <---> | Replacement Fan (for 2-pole motors) | | MTCP-7P5-3BD36 MTCP-010-3BD36 | 7-1/2 10 | 0.3 |
| MTAP-FAN-210 | <---> | Replacement Fan (4&6-pole) | 213 & 215 | | 3 | 0.3 |
| MTAP-SHROUD-210 | <---> | Replacement Fan Shroud | | MTCP-003-3BD12 MTCP-005-3BD12 MTCP-7P5-3BD18(C) MTCP-010-3BD18(C) | 5 7-1/2 10 | 2.3 |
| MTAP-JBOX-210 | <---> | Replacement Junction Box | | | | 3.4 |
| MTAP-FAN-250-2 | <---> | Replacement Fan (for 2-pole motors) | | MTCP-015-3BD36 MTCP-020-3BD36 | 15 20 | 0.3 |
| MTAP-FAN-250 | <---> | Replacement Fan (4&6-pole) | 254 & 256 | | 7-1/2 10 15 20 | 0.3 4.5 |
| MTAP-SHROUD-250 | <---> | Replacement Fan Shroud | | | | 7.0 |
| MTAP-JBOX-250 | <---> | Replacement Junction Box | | | | |
| MTAP-FAN-280 | <---> | Replacement Fan | 284 & 286 | MTCP-015-3BD12 MTCP-020-3BD12 MTCP-025-3BD18(C) MTCP-030-3BD18(C) | 15 20 25 30 | 0.5 6.5 7.0 |
| MTAP-SHROUD-280 | <---> | Replacement Fan Shroud | | | | |
| MTAP-JBOX-280 | <---> | Replacement Junction Box | | | | |
| MTAP-FAN-320 | <---> | Replacement Fan | 324 & 326 | | 40 | 0.6 |
| MTAP-SHROUD-320 | <---> | Replacement Fan Shroud | | MTCP-040-3BD18(C) MTCP-050-3BD18(C) | 50 | 8.3 |
| MTAP-JBOX-320 | <---> | Replacement Junction Box | | | | 22.3 |
| MTAP-FAN-360 | <---> | Replacement Fan | 364 & 365 | | 60 | 0.6 |
| MTAP-SHROUD-360 | <---> | Replacement Fan Shroud | | MTCP-060-3BD18(C) MTCP-075-3BD18(C) | 75 | 9.0 |
| MTAP-JBOX-360 | <---> | Replacement Junction Box | | | | 22.3 |
| MTAP-FAN-400 | <---> | Replacement Fan | | | | 1.1 |
| MTAP-SHROUD-400 | <---> | Replacement Fan Shroud | 405 | MTCP-100-3BD18(C) | 100 | 15.8 |
| MTAP-JBOX-400 | <---> | Replacement Junction Box | | | | 30.0 |
| MTAP-FAN-440 | <---> | Replacement Fan | 444 & 445 | | 125 | 2.0 |
| MTAP-SHROUD-440 | <---> | Replacement Fan Shroud | | MTCP-125-3BD18 MTCP-150-3BD18 MTCP-200-3BD18 | 150 200 | 17.5 |
| MTAP-JBOX-440 | <---> | Replacement Junction Box | 447 | | | 40.0 |

1) These MTAP replacement components fit only MTCP Premium Efficiency motors; they will NOT fit MTC EAct motors.
 2) Replacement Fans include fan and snap ring.
 3) Replacement Fan Shrouds include shroud, bolts w/washers, and rubber plug.
 4) Replacement Junction Boxes include gasketed base & cover assembly, base gasket, and base bolts.



AutomationDirect AC Motors Selection Overview

EPAct, High and Premium Efficiency - What does it all mean?

EPAct (1992)

In 1992, the U.S. Congress passed legislation requiring that general purpose Design A & B motors meet minimum efficiency requirements, and this legislation was called the Energy Policy Act of 1992. Previously, there had been no U.S. standards set forth for motor energy efficiency. Since 1997 (when EPAct '92 was first enforced), two-, four-, and six-pole general purpose Design A & B motors had to meet EPAct guidelines. Since then, most general purpose motors manufactured and/or sold in the U.S. have met these requirements.

Premium Efficiency (EISA 2007)

In December 2010, a new level of energy efficiency mandate went into effect. The Energy Independence and Security Act of 2007 mandated that all AC industrial motors as described below must meet Premium Efficiency standards. The NEMA trade group was instrumental in getting this legislation passed, so many people refer to the high efficiency motors by their nickname – NEMA Premium®. All applicable motors manufactured or imported into the U.S. after December 2010 must meet the Premium Efficiency guidelines.

Motors Covered Under EISA 2007 (Premium Efficiency Mandate)

Included – must meet the new Premium Efficiency standards – Industrial AC electric squirrel-cage general-purpose motors as follows:

Single speed; Polyphase; 1–200 hp with 3-digit frame sizes; 2, 4, & 6 pole (3600, 1800, & 1200 rpm); NEMA design A & B (including IEC equivalent); Continuous rated

Not Included in Premium Efficiency standards, but must now meet EPAct standards:

JM; JP; Round body (footless); 201–500 hp; Fire pump; U-frame; Design C; 8-pole

Certain motors (Inverter/Vector Duty, NEMA design D, etc.) are not covered by EISA 2007.

For full text, visit www.energy.senate.gov and click "ENERGY INDEPENDENCE & SECURITY ACT OF 2007".

| Nominal Full-Load Efficiency Standards Comparisons (%) | | | | | | |
|---|-------------------|--------------------|-------------------|--------------------|-------------------|--------------------|
| Enclosed Electric Motors, Random Wound, 60 Hz, 600V or Less | | | | | | |
| Motor HP | 1200 rpm [6-pole] | | 1800 rpm [4-pole] | | 3600 rpm [2-pole] | |
| | EPAct | Premium Efficiency | EPAct | Premium Efficiency | EPAct | Premium Efficiency |
| 1 | 80.0 | 82.5 | 82.5 | 85.5 | 75.5 | 77.0 |
| 1.5 | 85.5 | 87.5 | 84.0 | 86.5 | 82.5 | 84.0 |
| 2 | 86.5 | 88.5 | 84.0 | 86.5 | 84.0 | 85.5 |
| 3 | 87.5 | 89.5 | 87.5 | 89.5 | 85.5 | 86.5 |
| 5 | 87.5 | 89.5 | 87.5 | 89.5 | 87.5 | 88.5 |
| 7.5 | 89.5 | 91.0 | 89.5 | 91.7 | 88.5 | 89.5 |
| 10 | 89.5 | 91.0 | 89.5 | 91.7 | 89.5 | 90.2 |
| 15 | 90.2 | 91.7 | 91.0 | 92.4 | 90.2 | 91.0 |
| 20 | 90.2 | 91.7 | 91.0 | 93.0 | 90.2 | 91.0 |
| 25 | 91.7 | 93.0 | 92.4 | 93.6 | 91.0 | 91.7 |
| 30 | 91.7 | 93.0 | 92.4 | 93.6 | 91.0 | 91.7 |
| 40 | 93.0 | 94.1 | 93.0 | 94.1 | 91.7 | 92.4 |
| 50 | 93.0 | 94.1 | 93.0 | 94.5 | 92.4 | 93.0 |
| 60 | 93.6 | 94.5 | 93.6 | 95.0 | 93.0 | 93.6 |
| 75 | 93.6 | 94.5 | 94.1 | 95.4 | 93.0 | 93.6 |
| 100 | 94.1 | 95.0 | 94.5 | 95.4 | 93.6 | 94.1 |
| 125 | 94.1 | 95.0 | 94.5 | 95.4 | 94.5 | 95.0 |
| 150 | 95.0 | 95.8 | 95.0 | 95.8 | 94.5 | 95.0 |
| 200 | 95.0 | 95.8 | 95.0 | 96.2 | 95.0 | 95.4 |

AC Motor Selection – Three-phase Motors

(Single-phase motors are shown on page 15-15)

| 3-Phase Characteristic | IronHorse® 56C Frame 3-Phase | IronHorse® T & TC Frames EPAct & PE | Marathon microMAX™ | Marathon Black Max® | Marathon Blue Max® | Marathon NEMA Premium® XRI® | Marathon Blue Chip XRI® |
|--|--|--|---|--|----------------------------|-----------------------------------|--|
| Electrical Characteristics | | | | | | | |
| Horsepower range | 1/3 - 2 | PE: 1-200(T); 1-100(TC) EPAct: 250-300(T) | 1/4 - 10 | 1/4 - 30 | 40 - 100 | 1 - 10 | 15 - 100 |
| Base speed (# Poles) | 1800 (4), 3600 (2) | 1200(6), 1800 (4), 3600(2) | 1800 (4) | 1800 (4) and 1200 (6) | 1800 (4) | 1200(6),1800(4),3600(2) | 1800 (4) |
| Standard Voltage | 208-230/460 | 208-230/460 (250 & 300 hp 460V only) | 230/460 (1/4 hp is 230V only) | 230/460 and 575 | 230/460 | 208-230/460 | 230/460 and 575 |
| Insulation Class | F | F | H | F | H | F | F |
| Insulation System | dip & bake | EPAct: double dip & bake PE: VPI | CR ²⁰⁰ magnet wire | MAX GUARD® | | CR ²⁰⁰ magnet wire | |
| Service Factor | 1.15 (line) 1.0 (drive) | 1.15 (line) 1.0 (drive) | 1.0 | 1.0 | 1.0 | 1.15 (line) 1.0 (drive) | |
| Phase/Base Frequency | 3/60 | | | | | | |
| Design Code (NEMA) | B | B | B for 1/4 - 2 hp A for 3 - 10 hp | A | A | B | B |
| Duty Cycle | Continuous | | | | | | |
| Thermal protection | None | | | Class F thermostats | | None | |
| Mechanical Characteristics | | | | | | | |
| Frame size (mounting) | 56C | 143T/TC - 405TC/449T | 56C - 215TC | 56C - 286TC | 324T(C)-405T(C) | 56C - 215TC | 254T - 405T |
| Enclosure | TEFC | TEFC | TENV and TEFC | TENV | TEFC and TEBC | TEFC | TEFC |
| Frame material | Rolled Steel frame; Aluminum end bell | Cast Iron | Rolled Steel | Rolled Steel w Al face; Cast Iron | Cast Iron | Rolled Steel | Cast Iron |
| End bracket material | Aluminum | Cast Iron | Aluminum | Aluminum, Cast Iron | Cast Iron | Aluminum | Cast Iron |
| Conduit box material | Steel | Cast Iron | Steel | Steel | Cast Iron | Steel | Steel (<326T) Cast Iron (>364T) |
| Fan guard material | Steel | Steel | Polypropylene | None (all ratings TENV) | Cast Iron | Plastic | Polyprop. (<286T) Cast Iron (>324T) |
| Fan material | Plastic | Plastic (143T/TC - 445/7T) Aluminum (449T) | Polypropylene | None (all ratings TENV) | Polypropylene | Polypropylene | Polypropylene |
| Lead termination | Conduit box | Conduit box | Conduit box except Terminal block - 1/4 hp | Conduit box | Conduit box | Conduit box | Conduit box |
| Standard mounting | C-Face with Removable Rigid Base | Rigid Base (C-Flange kit available EPAct) C-Face with Rigid Base (1-100 hp) | C-Face with Rigid Base & C-Face Round Body | C-Face with Rigid Base | C-Face with Rigid Base | C-Face with Rigid Base | Rigid Base |
| Drive end shaft slinger | Yes | Yes | No | No | Yes | Yes | Yes |
| Paint | Black | EPAct: Epoxy primer / Synthetic alkyd enamel PE: Polyurethane enamel | Black powder-coat; Black enamel | Black enamel | Blue enamel | Blue enamel | epoxy paint |
| Bearings | Ball | 1-75 hp: Ball 100-300 hp: Roller | Ball (C3 fit) | Ball (C3 fit) | Ball (C3 fit) | Ball (C3 fit) | Ball (C3 fit) |
| Grease | Exxon Polyrex EM | | | | | | |
| Standard conduit box assembly position | F1 | F1 some sizes reversible to F2 | F3 | F1, reversible to F2 | F1, reversible to F2 | F3 | F1 |
| Performance Characteristics | | | | | | | |
| Constant Torque speed range | 2:1 | 2:1 (EPAct) 4:1 (Premium Efficiency) | 20:1 (TEFC) 1000:1 (TENV) | 1000:1 (TENV) | 2000:1 (all enclosures) | 10:1 | 20:1 |
| Variable Torque speed range | 5:1 | 5:1 (EPAct) 10:1 (Premium Efficiency) | - | - | - | 10:1 | - |
| Constant Horsepower speed range | 1.5:1 | 1.5:1 | 2:1 | 2:1 (90-120Hz intermit- tent @50% duty cycle) | 2:1 | 2:1 | 2:1 |
| Temperature rise | B | B | B | F | F (TEFC) and B (TEBC) | F | B |
| Encoder provisions | No | No | No | Yes | Yes | No | No |
| Other Characteristics | | | | | | | |
| Agency listings | cCSA _{US} | CE, cCSA _{US} , EPAct | UL Recognized, CSA Certified, and CE Mark | | | | |
| Warranty* | 2 years | | 3 years (through Marathon Electric) | | | | |
| <p>*See Terms and Conditions for motor warranty explanation.</p> <p>1) For warranty on IronHorse motors below 50 hp, warranty service can be arranged through AutomationDirect.</p> <p>2) For warranty on IronHorse motors 50 hp and above, motors must be inspected by a local EASA motor repair or service center; see AutomationDirect Terms & Conditions.</p> <p>3) Marathon warranty service can be arranged through Marathon Electric service centers. See list of service centers on our web site at www.automationdirect.com.</p> | | | | | | | |

IronHorse® General Purpose AC Motors

Model Overview – MTC & MTCP



**Single-Phase
Rolled Steel 56C-Frame**



**Three-Phase
Rolled Steel 56C-Frame**



**Premium Efficiency Three-Phase
Cast Iron T-Frame**



**Premium Efficiency Three-Phase
Cast Iron TC-Frame**

IronHorse motors are manufactured by a leading motor supplier with over 20 years experience delivering high-quality motors to the demanding U.S. market. Our supplier produces motors in an ISO9001 facility which tests the motors during production and after final assembly. This is how we can stand behind our IronHorse motors with a **two-year warranty**.

The IronHorse line of motors includes:

- TEFC 56C-frame single-phase AC motors with rolled steel frames; flange mount and removable mounting bases; 0.33–1.5 hp
- TEFC 56C-frame three-phase AC motors with rolled steel frames; flange mount and removable mounting bases; 0.33–2 hp
- TEFC T-frame three-phase Premium Efficiency AC motors with cast iron frames and mounting feet; 1–200 hp
- TEFC T-frame three-phase EPC AC motors with cast iron frames and mounting feet; 250–300 hp
- TEFC TC-frame three-phase C-face Premium Efficiency AC motors with cast iron frames and mounting feet; 1–100 hp
- Replacement start and run capacitors available for IronHorse single-phase motors
- Accessory C-flange kits available for flange mounting of IronHorse three-phase cast iron T-frame Premium Efficiency and EPC motors
- STABLE motor slide bases for adjustable mounting of NEMA motors from 56 - 449T

IronHorse Part Number Explanation

MT CP - 7P5 - 3 BD 18 C

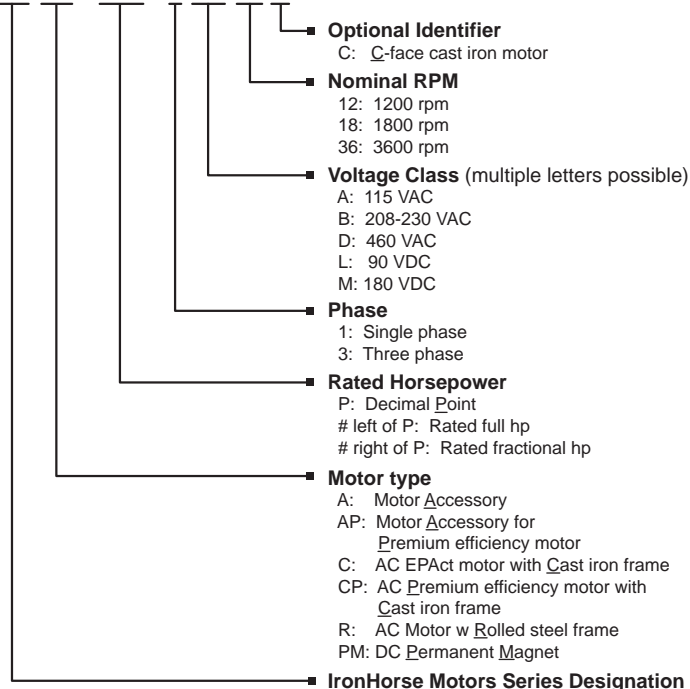

NOTE THAT SOME POSSIBLE PART NUMBER COMBINATIONS MAY NOT EXIST AS ACTUAL PARTS. PLEASE CHECK ACTUAL AVAILABLE PART NUMBERS BEFORE ORDERING.

STABLE™ Motor Slide Bases

Mounting Slide Bases for 56 to 449T NEMA Motors

Features

- Allows adjustment of motor mounting position
- Double adjusting screws for frames 182T - 449T
- Manufactured to precise dimensional standards
- Dimensionally interchangeable with existing major makes
- Heavy-duty steel construction
- Painted with oven-baked primer for better adhesion of customer's paint
- All "D" bolts (motor mounting bolts) are fixed to the exact motor foot pattern
- All "D" bolts are welded into position to prevent spinning and dropping from slots
- Bases are provided with washers



| Motor Slide Bases | | | | | | | | | | | |
|-----------------------|-------|-----------------|---------------------|--|----------------------|---|----------------------------|----------------------------|----------------------------------|---------------------------------|-----------------------------|
| Part Number | Price | Fits Frame Type | Product Weight (lb) | Fits Motor | | | | | | | |
| | | | | IronHorse | Marathon micro -MAX | Marathon Black Max 230/460V | Marathon Black Max 575V | Marathon Blue Max | Marathon NEMA Premium XRI | Marathon Blue Chip XRI 230/460V | Marathon Blue Chip XRI 575V |
| MTA-BASE-W56 | <---> | 56 | 2.8 | MTR-xxx-xxxx MTPM-xxx-xxxx | Y500 Y360 Y364 | Y592(-A772) Y534(-A772) Y535(-A772) | Y555(-A772) Y556(-A772) | - | E2000 | - | - |
| MTA-BASE-W143T | <---> | 143T/TC | 4.6 | MTCP-001-3BD18(C) MTCP-1P5-3BD36 | - | Y536(-A772) | - | - | E2001 E2003 | - | - |
| MTA-BASE-W145T | <---> | 145T/TC | 5.1 | MTCP-001-3BD12 MTCP-1P5-3BD18(C) MTCP-002-3BD18(C) MTCP-002-3BD36 | Y368 | Y537(-A772) Y538(-A772) Y551(-A772) | Y557(-A772) | - | E2002 E2004 E2006 E2007 | - | - |
| MTA-BASE-W182T | <---> | 182T/TC | 9.2 | MTCP-1P5-3BD12 MTCP-003-3BD18(C) MTCP-003-3BD36 | Y1999 | Y541(-A772) | Y558(-A772) | - | E2005 E2009 E2010 | - | - |
| MTA-BASE-W184T | <---> | 184T/TC | 10 | MTCP-002-3BD12 MTCP-005-3BD18(C) MTCP-005-3BD36 | Y1372 | Y540(-A772) Y543(-A772) | Y559(-A772) | - | E2008 E2012 E2013 | - | - |
| MTA-BASE-W213T | <---> | 213T/TC | 13 | MTCP-003-3BD12 MTCP-7P5-3BD18(C) MTCP-7P5-3BD36 | Y994 | Y542(-A772) Y545(-A772) | Y560(-A772) | - | E2011 E2015 E2016 | - | - |
| MTA-BASE-W215T | <---> | 215T/TC | 15 | MTCP-005-3BD12 MTCP-010-3BD18(C) MTCP-010-3BD36 | Y996 | Y544(-A772) Y547(-A772) | Y561(-A772) | - | E2014 E2018 E2019 | - | - |
| MTA-BASE-W254T | <---> | 254T/TC | 18 | MTCP-7P5-3BD12 MTCP-015-3BD18(C) MTCP-015-3BD36 | - | Y546(-A772) Y549(-A772) | Y562(-A772) | - | - | E205 | E307 |
| MTA-BASE-W256T | <---> | 256T/TC | 19 | MTCP-010-3BD12 MTCP-020-3BD18(C) MTCP-020-3BD36 | - | Y548(-A772) Y552(-A772) | Y563(-A772) | - | - | E206 | E308 |
| MTA-BASE-W284T | <---> | 284T/TC | 20 | MTCP-015-3BD12 MTCP-025-3BD18(C) | - | Y553(-A772) | - | - | - | E207 | E309 |
| MTA-BASE-W286T | <---> | 286T/TC | 21 | MTCP-020-3BD12 MTCP-030-3BD18(C) | - | Y393(-A772) | - | - | - | E208 | E310 |
| MTA-BASE-W324T | <---> | 324T/TC | 30 | MTCP-040-3BD18(C) | - | - | - | Y571(-A774) Y513(-A775) | - | E209 | E311 |
| MTA-BASE-W326T | <---> | 326T/TC | 31 | MTCP-050-3BD18(C) | - | - | - | Y572(-A774) Y514(-A775) | - | E210 | E312 |
| MTA-BASE-W364T | <---> | 364T/TC | 43 | MTCP-060-3BD18(C) | - | - | - | Y573(-A774) Y515(-A775) | - | E211 | E313 |
| MTA-BASE-W365T | <---> | 365T/TC | 43 | MTCP-075-3BD18(C) | - | - | - | Y574(-A774) Y516(-A775) | - | E212 | E315 |
| MTA-BASE-W404T | <---> | 404T/TC | 58 | - | - | - | - | - | - | - | - |
| MTA-BASE-W405T | <---> | 405T/TC | 60 | MTCP-100-3BD18(C) | - | - | - | Y575(-A774) Y517(-A775) | - | E213 | E314 |
| MTA-BASE-W444T | <---> | 444T | 63 | MTCP-125-3BD18 | - | - | - | - | - | - | - |
| MTA-BASE-W445T | <---> | 445T | 65 | MTCP-150-3BD18 | - | - | - | - | - | - | - |
| MTA-BASE-W447T | <---> | 445/7T 447T | 89 | MTCP-200-3BD18 | - | - | - | - | - | - | - |
| MTA-BASE-W449T | <---> | 449T | 94 | MTC-250-3D18 MTC-300-3D18 | - | - | - | - | - | - | - |

STABLE Motor Slide Bases

Dimensions – Mounting Slide Bases for NEMA Motors

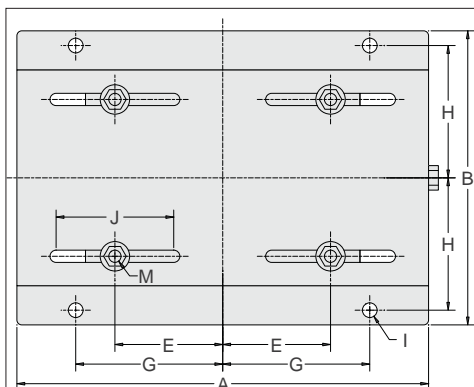

W56 - W145T Motor Slide Base Dimensions

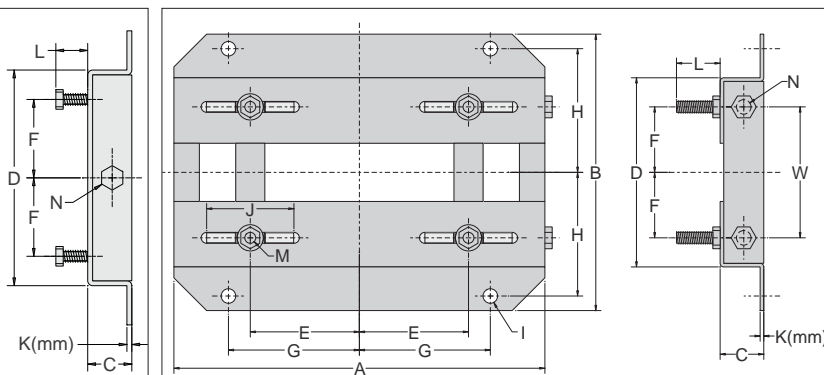
 W182T - W449T Motor Slide Base Dimensions
 (W182T-W215T bases have one-piece top plates, similar to W56-W145T)

Dimensions [inches, except as noted] - STABLE Motor Slide Bases

| MTA-BASE-Wxxxx | A | B | C | D | E | F | G | H | I | J | K(mm) | L | M | N | W |
|----------------|--------|--------|-------|--------|--------|--------|---------|--------|-----|-------|--------|---------|-------------|----------|--------|
| 56 | 10-5/8 | 6-1/2 | 1-1/8 | 4-1/2 | 2-7/16 | 1-1/2 | 3-13/16 | 2-7/8 | 3/8 | 3 | 2 mm | 7/8 | 5/16 x 1 | 3/8 x 4 | n/a |
| 143T | 10-1/2 | 7-1/2 | 1-1/8 | 5-1/2 | 2-3/4 | 2 | 3-3/4 | 3-3/8 | 3/8 | 3 | 3 mm | 13/16 | 5/16 x 1 | 3/8 x 4 | n/a |
| 145T | 10-1/2 | 8-1/2 | 1-1/8 | 6-1/2 | 2-3/4 | 2-1/2 | 3-3/4 | 3-7/8 | 3/8 | 3 | 3 mm | 13/16 | 5/16 x 1 | 3/8 x 4 | n/a |
| 182T | 12-3/4 | 9-1/2 | 1-1/2 | 6-1/2 | 3-3/4 | 2-1/4 | 4-1/2 | 4-1/4 | 1/2 | 3 | 3.5 mm | 1-1/2 | 3/8 x 1-3/4 | 1/2 x 6 | 4-1/2 |
| 184T | 12-3/4 | 10-1/2 | 1-1/2 | 7-1/2 | 3-3/4 | 2-3/4 | 4-1/2 | 4-3/4 | 1/2 | 3 | 3.5 mm | 1-1/2 | 3/8 x 1-3/4 | 1/2 x 6 | 5-1/2 |
| 213T | 15 | 11 | 1-3/4 | 7-1/2 | 4-1/4 | 2-3/4 | 5-1/4 | 4-3/4 | 1/2 | 3-1/2 | 3.8 mm | 1-1/2 | 3/8 x 1-3/4 | 1/2 x 6 | 5-1/2 |
| 215T | 15 | 12-1/2 | 1-3/4 | 9 | 4-1/4 | 3-1/2 | 5-1/4 | 5-1/2 | 1/2 | 3-1/2 | 3.8 mm | 1-1/2 | 3/8 x 1-3/4 | 1/2 x 6 | 7 |
| 254T | 17-3/4 | 15-1/8 | 2 | 10-3/4 | 5 | 4-1/8 | 6-1/4 | 6-5/8 | 5/8 | 4 | 4.6 mm | 1-7/16 | 1/2 x 1-3/4 | 5/8 x 6 | 5-5/16 |
| 256T | 17-3/4 | 16-7/8 | 2 | 12-1/2 | 5 | 5 | 6-1/4 | 7-1/2 | 5/8 | 4 | 4.6 mm | 1-7/16 | 1/2 x 1-3/4 | 5/8 x 6 | 7 |
| 284T | 19-3/4 | 16-7/8 | 2 | 12-1/2 | 5-1/2 | 4-3/4 | 7 | 7-1/2 | 5/8 | 4-1/2 | 4.6 mm | 1-11/16 | 1/2 x 2 | 5/8 x 6 | 7 |
| 286T | 19-3/4 | 18-3/8 | 2 | 14 | 5-1/2 | 5-1/2 | 7 | 8-1/4 | 5/8 | 4-1/2 | 4.6 mm | 1-11/16 | 1/2 x 2 | 5/8 x 6 | 8 |
| 324T | 22-3/4 | 19-1/4 | 2-1/2 | 14 | 6-1/4 | 5-1/4 | 8 | 8-1/2 | 3/4 | 5-1/4 | 4.6 mm | 2-3/16 | 5/8 x 2-1/2 | 3/4 x 9 | 7 |
| 326T | 22-3/4 | 20-3/4 | 2-1/2 | 15-1/2 | 6-1/4 | 6 | 8 | 9-1/4 | 3/4 | 5-1/4 | 4.6 mm | 2-3/16 | 5/8 x 2-1/2 | 3/4 x 9 | 8-1/2 |
| 364T | 25-1/2 | 20-1/2 | 2-1/2 | 15-1/2 | 7 | 5-5/8 | 9 | 9-1/8 | 3/4 | 6 | 5.8 mm | 2-1/16 | 5/8 x 2-1/2 | 3/4 x 9 | 7-3/4 |
| 365T | 25-1/2 | 21-1/2 | 2-1/2 | 16-1/2 | 7 | 6-1/8 | 9 | 9-5/8 | 3/4 | 6 | 5.8 mm | 2-1/16 | 5/8 x 2-1/2 | 3/4 x 9 | 8-3/4 |
| 404T | 28-3/4 | 22-3/8 | 3 | 16-1/2 | 8 | 6-1/8 | 10 | 9-7/8 | 7/8 | 7 | 5.8 mm | 2-1/2 | 3/4 x 3 | 3/4 x 11 | 8-3/4 |
| 405T | 28-3/4 | 23-7/8 | 3 | 18 | 8 | 6-7/8 | 10 | 10-5/8 | 7/8 | 7 | 5.8 mm | 2-1/2 | 3/4 x 3 | 3/4 x 11 | 10-1/4 |
| 444T | 31-1/4 | 24-5/8 | 3 | 19-1/4 | 9 | 7-1/4 | 11 | 11 | 7/8 | 7-1/2 | 5.8 mm | 2-1/2 | 3/4 x 3 | 3/4 x 11 | 11 |
| 445T | 31-1/4 | 26-5/8 | 3 | 21-1/4 | 9 | 8-1/4 | 11 | 12 | 7/8 | 7-1/2 | 5.8 mm | 2-1/2 | 3/4 x 3 | 3/4 x 11 | 13 |
| 447T | 31-1/4 | 30-1/8 | 3 | 24-3/4 | 9 | 10 | 11 | 13-3/4 | 7/8 | 7-1/2 | 8 mm | 3 | 3/4 x 3-1/2 | 3/4 x 11 | 16-1/2 |
| 449T | 31-1/4 | 35-1/8 | 3 | 29-3/4 | 9 | 12-1/2 | 11 | 16-1/4 | 7/8 | 7-1/2 | 8 mm | 3 | 3/4 x 3-1/2 | 3/4 x 11 | 21-1/2 |