

NEMA 12 JIC Small Contin. Hinge Wall Mount



Applications

Intended for use as electrical junction boxes, terminal wiring boxes, and instrument housings. Hinged door provides convenient access. Provides protection from dust, dirt, oil, and water.

Construction

- Bodies and doors fabricated from 14 gauge steel
- Continuously welded seams ground smooth, less knockouts or holes
- Lids are sealed with closed cell oil resistant neoprene gasket
- External mounting feet, top and bottom of enclosure
- Weldnuts provided for mounting optional subpanels securely on models 6"x4" and larger
- External screw clamps are quick and easy to operate
- Standard continuous hinge
- Grounding provisions provided

Finish

- ANSI-61 gray polyester powder inside and out over phosphatized surfaces
- Optional subpanels are white polyester powder over phosphatized surfaces

Listings

- UL 50, Types 12 and 13
- UL Files E6924
- CSA Certified, Type 12
- CSA File LL66078
- NEMA/EEMAC Types 12 and 13
- JIC EL-1-71

Enclosure Shipping Schedule

Same day	1 - 7 days	1 -10 days
----------	------------	------------

Color indicates shipping lead time in business days.

Part Number	Price	Body/Door	Enclosure Size HxWxD	Subpanel P/N	Price	Subpane I Size Ax B	Mtg Cx E	Overall LxM	F	G	I	J	K	N	O	P	Q
B040403CH	<-->	14/14	4x4x3 (102x102x76)	NA	NA	NA	4.75x2 (121x51)	5.50x5 (140x127)	2.53 (76)	4.31 (109)	3 (76)	NA	1.38 (35)	1.78 (45)	2.53 (64)	0.63 (16)	4.31 (110)
B040404CH	<-->	14/14	4x4x4 (102x102x102)	NA	NA	NA	4.75x2 (121x51)	5.50x5 (140x127)	3.53 (101)	4.31 (109)	3 (76)	NA	1.38 (35)	2.78 (71)	3.53 (90)	0.63 (16)	4.31 (110)
B060403CH	<-->	14/14	6x4x3 (152x102x76)	P0604	<-->	4.88x2.88 (124x73)	6.75x2 (171x51)	7.50x5 (191x127)	2.53 (76)	4.31 (109)	3 (76)	0.56 (14)	2.38 (60)	1.78 (45)	2.53 (64)	0.63 (16)	6.31 (160)
B060404CH	<-->	14/14	6x4x4 (152x102x102)	P0604	<-->	4.88x2.88 (124x73)	6.75x2 (171x51)	7.50x5 (191x127)	3.53 (101)	4.31 (109)	3 (76)	0.56 (14)	2.38 (60)	2.78 (71)	3.53 (90)	0.63 (16)	6.31 (160)
B060604CH	<-->	14/14	6x6x4 (152x152x102)	P0606	<-->	4.88x4.88 (124x124)	6.75x4 (171x102)	7.50x5 (191x127)	3.53 (101)	6.31 (160)	5 (127)	0.56 (14)	2.38 (60)	2.78 (71)	3.53 (90)	0.63 (16)	6.31 (160)
B080603CH	<-->	14/14	8x6x3.50 (203x152x89)	P0806	<-->	6.88x4.88 (175x124)	8.75x4 (222x102)	9.50x7 (241x178)	3.03 (88)	6.31 (160)	5 (127)	0.56 (14)	1 (25)	2.28 (58)	3.03 (77)	0.63 (16)	8.31 (211)
B080606CH	<-->	14/14	8x6x6 (203x152x152)	P0806	<-->	6.88x4.88 (175x124)	8.75x4 (222x102)	9.50x7 (241x178)	5.53 (152)	6.31 (160)	5 (127)	0.56 (14)	1 (25)	4.78 (121)	5.53 (141)	0.63 (16)	8.31 (211)
B080804CH	<-->	14/14	8x8x4 (203x203x102)	P0808	<-->	6.88x6.88 (175x175)	8.75x6 (222x152)	9.50x9 (241x229)	3.53 (101)	8.31 (211)	7 (178)	0.56 (14)	1 (25)	2.78 (71)	3.53 (90)	0.63 (16)	8.31 (211)
B100804CH	<-->	14/14	10x8x4 (254x203x102)	P1008	<-->	8.88x6.88 (226x175)	10.75x6 (273x152)	11.50x9 (292x229)	3.53 (101)	8.31 (211)	7 (178)	0.56 (14)	1 (25)	2.78 (71)	3.53 (90)	0.63 (16)	10.31 (262)
B100804CHS	<-->	14/14	8x10x4 (203x254x102)	P1008	<-->	8.88x6.88 (226x175)	10.75x6 (273x152)	11.50x9 (292x229)	3.53 (101)	8.31 (211)	7 (178)	0.56 (14)	1 (25)	2.78 (71)	3.53 (90)	0.63 (16)	10.31 (262)
B100806CH	<-->	14/14	10x8x6 (254x203x152)	P1008	<-->	8.88x6.88 (226x175)	10.75x6 (273x152)	11.50x9 (292x229)	5.53 (152)	8.31 (211)	7 (178)	0.56 (14)	1 (25)	4.78 (121)	5.53 (141)	0.63 (16)	10.31 (262)
B101006CH	<-->	14/14	10x10x6 (254x254x152)	P1010	<-->	8.88x8.88 (226x226)	10.75x8 (273x203)	11.50x11 (292x279)	5.53 (152)	5.53 (152)	9 (229)	0.56 (14)	1 (25)	4.78 (121)	5.53 (141)	0.63 (16)	10.31 (262)

Note: Subpanels must be ordered separately. Dimensions in inches (millimeters); letters in table correspond to letters on dimensional drawings.

NEMA 12 JIC Small Contin. Hinge Wall Mount

Enclosure Shipping Schedule		
Same day	1 - 7 days	1 -10 days
Color indicates shipping lead time in business days.		

Part Number	Price	Body/Door	Enclosure Size HxWxD	Subpanel P/N	Price	Subpanel Size AxB	Mtg Cx E	Overall LxM	F	G	I	J	K	N	O	P	Q
B120604CH	<-->	14/14	12x6x4 (305x152x102)	P1206	<-->	10.88x4.88 (276x124)	12.75x4 (324x102)	13.50x7 (343x178)	3.53 (101)	6.31 (160)	5 (127)	0.56 (14)	1 (25)	2.78 (71)	3.53 (90)	0.63 (16)	12.31 (313)
B121005CH	<-->	14/14	12x10x5 (305x254x127)	P1210	<-->	10.88x8.88 (276x226)	12.75x8 (324x203)	13.50x11 (343x279)	4.53 (127)	10.31 (262)	9 (229)	0.56 (14)	1 (25)	3.78 (96)	4.53 (115)	0.63 (16)	12.31 (313)
B121005CHS	<-->	14/14	10x12x5 (254x305x127)	P1210	<-->	10.88x8.88 (276x226)	12.75x8 (324x203)	13.50x11 (343x279)	4.53 (127)	10.31 (262)	9 (229)	0.56 (14)	1 (25)	3.78 (96)	4.53 (115)	0.63 (16)	12.31 (313)
B121008CH	<-->	14/14	12x10x8 (305x254x203)	P1210	<-->	10.88x8.88 (276x226)	12.75x8 (324x203)	13.50x11 (343x279)	7.53 (203)	10.31 (262)	9 (229)	0.56 (14)	1 (25)	6.78 (172)	7.53 (191)	0.63 (16)	12.31 (313)
B121206CH	<-->	14/14	12x12x6 (305x305x152)	P1212	<-->	10.88x10.88 (276x276)	12.75x10 (324x254)	13.50x13 (343x330)	5.53 (152)	12.31 (313)	11 (279)	0.56 (14)	1 (25)	4.78 (121)	5.53 (141)	0.63 (16)	12.31 (313)
B140806CH	<-->	14/14	14x8x6 (356x203x152)	P1408	<-->	12.88x6.88 (327x175)	14.75x6 (375x152)	15.50x9 (394x229)	5.53 (152)	8.31 (211)	7 (178)	0.56 (14)	1 (25)	4.78 (121)	5.53 (141)	0.63 (16)	14.31 (364)
B141206CH	<-->	14/14	14x12x6 (356x305x152)	P1412	<-->	12.88x10.88 (327x276)	14.75x10 (375x254)	15.50x13 (394x330)	5.53 (152)	12.31 (313)	11 (279)	0.56 (14)	1 (25)	4.78 (121)	5.53 (141)	0.63 (16)	14.31 (364)
B141206CHS	<-->	14/14	12x14x6 (305x356x152)	P1412	<-->	12.88x10.88 (327x276)	14.75x10 (375x254)	15.50x13 (394x330)	5.53 (152)	12.31 (313)	11 (279)	0.56 (14)	1 (25)	4.78 (121)	5.53 (141)	0.63 (16)	14.31 (364)
B141208CH	<-->	14/14	14x12x8 (356x305x203)	P1412	<-->	12.88x10.88 (327x276)	14.75x10 (375x254)	15.50x13 (394x330)	7.53 (203)	12.31 (313)	11 (279)	0.56 (14)	1 (25)	6.78 (172)	7.53 (191)	0.63 (16)	14.31 (364)
B161006CH	<-->	14/14	16x10x6 (406x254x152)	P1610	<-->	14.88x8.88 (378x226)	16.75x8 (425x203)	17.50x11 (445x279)	5.53 (152)	10.31 (262)	9 (229)	0.56 (14)	1 (25)	4.78 (121)	5.53 (141)	0.63 (16)	16.31 (414)
B161406CH	<-->	14/14	16x14x6 (406x356x152)	P1614	<-->	14.88x12.88 (378x327)	16.75x12 (425x305)	17.50x15 (445x381)	5.53 (152)	14.31 (363)	13 (330)	0.56 (14)	1 (25)	4.78 (121)	5.53 (141)	0.63 (16)	16.31 (414)
B161406CHS	<-->	14/14	14x16x6 (356x406x152)	P1614	<-->	14.88x12.88 (378x327)	16.75x12 (425x305)	17.50x15 (445x381)	5.53 (152)	14.31 (363)	13 (330)	0.56 (14)	1 (25)	4.78 (121)	5.53 (141)	0.63 (16)	16.31 (414)
B161408CH	<-->	14/14	16x14x8 (406x356x203)	P1614	<-->	14.88x12.88 (378x327)	16.75x12 (425x305)	17.50x15 (445x381)	7.53 (203)	14.31 (363)	13 (330)	0.56 (14)	1 (25)	6.78 (172)	7.53 (191)	0.63 (16)	16.31 (414)
B161410CH	<-->	14/14	16x14x10 (406x356x254)	P1614	<-->	14.88x12.88 (378x327)	16.75x12 (425x305)	17.50x15 (445x381)	9.53 (254)	14.31 (363)	13 (330)	0.56 (14)	1 (25)	8.78 (223)	9.53 (242)	0.63 (16)	16.31 (414)

Note: Subpanels must be ordered separately.. Dimensions in inches (millimeters); letters in table correspond to letters on dimensional drawings.

NEMA 12 JIC Small Contin. Hinge Wall Mount

Dimensions

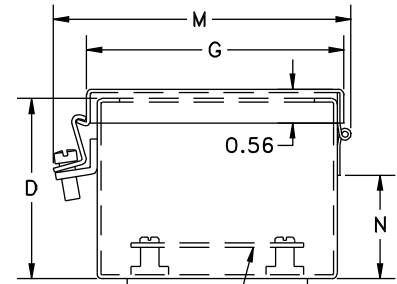
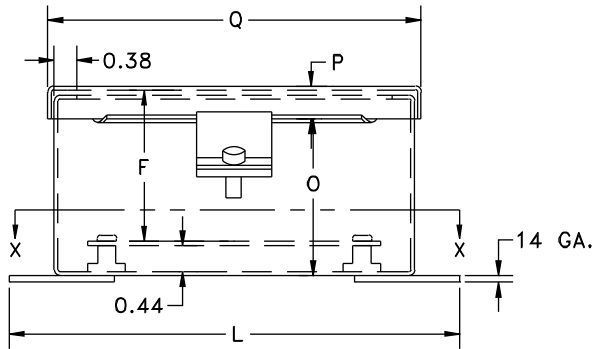

Panel (Order Separately)

Notes:

1. Panels are 14 Ga. steel.
2. Panel Screws are #10-32 Pan Head.
3. Two clamps are used if H = 8.00" or more.

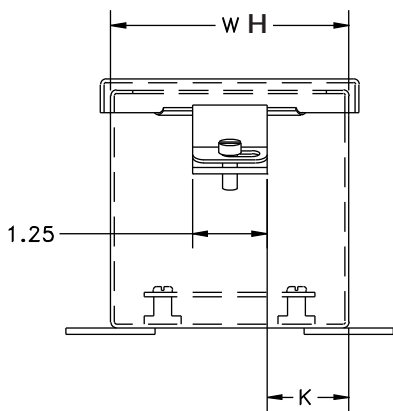
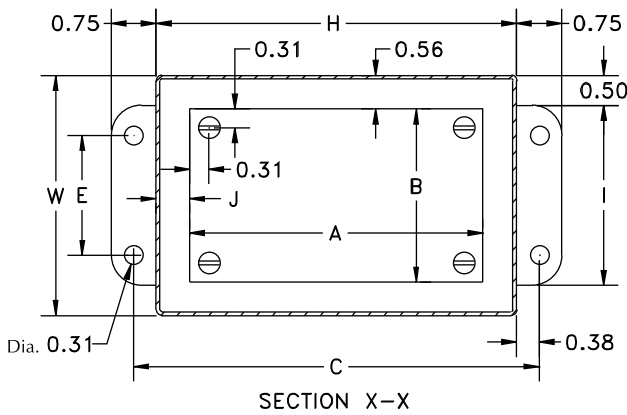

View showing clamp position when "H" is less than 8"

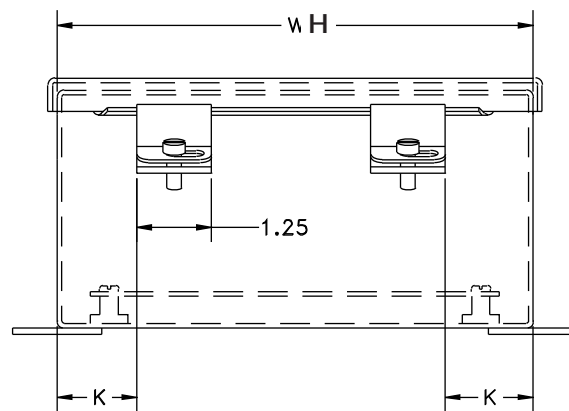

View showing clamp position when "H" equals 8" or more.