

NEMA 1 Small Hinged Wall Mount



Applications

Designed for use as control enclosures and instrument cases in areas not requiring oil-tight and dust-tight specifications.

Construction

- Bodies and doors fabricated from 16 or 14 gauge steel
- Continuous hinged covers
- Weldnuts provided for mounting optional subpanels
- Flush latch on lid can be operated by a coin or screwdriver
- Mounting holes on back of cabinet
- Grounding provisions provided

Finish

- ANSI-61 gray polyester powder inside and out over phosphatized surface
- Optional subpanels are white polyester powder over phosphatized surfaces

Listings

- UL 50, Type 1
- UL Files E6924
- CSA Certified, Type 1
- CSA Files LL66078
- NEMA/EEMAC Type 1

Enclosure Shipping Schedule		
Same day	1 - 7 days	1 - 10 days
Color indicates shipping lead time in business days.		

Part Number	Price	Body/Door	Enclosure Size HxWxD	Subpanel P/N	Price	Subpanel Size AxB	Subpanel Gauge
<i>N1C060604</i>	<-->	16/16	6x6x4 (152x152x102)	<i>N1P0606</i>	<-->	4.25x4.25 (108x108)	14
<i>N1C060804</i>	<-->	16/16	8x6x4 (203x152x102)	<i>N1P0608</i>	<-->	6.25x4.25 (159X108)	14
<i>N1C060806</i>	<-->	16/16	8x6x6 (203x152x152)	<i>N1P0608</i>	<-->	6.25x4.25 (159X108)	14
<i>N1C080804</i>	<-->	16/16	8x8x4 (203x203x102)	<i>N1P0808</i>	<-->	6.25x6.25 (159X159)	14
<i>N1C080806</i>	<-->	16/16	8x8x6 (203x203x152)	<i>N1P0808</i>	<-->	6.25x6.25 (159X159)	14
<i>N1C081004</i>	<-->	16/16	10x8x4 (254x203x102)	<i>N1P0810</i>	<-->	8.25x6.25 (210x159)	14
<i>N1C081006</i>	<-->	16/16	10x8x6 (254x203x152)	<i>N1P0810</i>	<-->	8.25x6.25 (210x159)	14
<i>N1C101004</i>	<-->	16/16	10x10x4 (254x254x102)	<i>N1P1010</i>	<-->	8.25x8.25 (210x210)	14
<i>N1C101006</i>	<-->	16/16	10x10x6 (254x254x152)	<i>N1P1010</i>	<-->	8.25x8.25 (210x210)	14
<i>N1C101204</i>	<-->	16/16	12x10x4 (305x254x102)	<i>N1P1012</i>	<-->	10.25x8.25 (260x210)	14
<i>N1C101206</i>	<-->	16/16	12x10x6 (305x254x152)	<i>N1P1012</i>	<-->	10.25x8.25 (260x210)	14
<i>N1C121204</i>	<-->	16/16	12x12x4 (305x305x102)	<i>N1P1212</i>	<-->	10.25x10.25 (260x260)	14
<i>N1C121206</i>	<-->	16/16	12x12x6 (305x305x152)	<i>N1P1212</i>	<-->	10.25x10.25 (260x260)	14
<i>N1C121208</i>	<-->	16/16	12x12x8 (305x305x203)	<i>N1P1212</i>	<-->	10.25x10.25 (260x260)	14
<i>N1C121404</i>	<-->	16/16	14x12x4 (356x305x102)	<i>N1P1214</i>	<-->	12.25x10.25 (311x260)	14
<i>N1C121406</i>	<-->	16/16	14x12x6 (356x305x152)	<i>N1P1214</i>	<-->	12.25x10.25 (311x260)	14
<i>N1C121408</i>	<-->	14/14	14x12x8 (356x305x203)	<i>N1P1214</i>	<-->	12.25x10.25 (311x260)	14
<i>N1C121606S</i>	<-->	16/16	16x12x6 (406x305x152)	<i>N1P1216</i>	<-->	14.25x10.25 (362x260)	14
<i>N1C122006</i>	<-->	14/14	20x12x6 (508x305x152)	<i>N1P1220</i>	<-->	18.25x10.25 (464x260)	14

Note: Subpanels must be ordered separately. Dimensions in inches (millimeters); letters in table correspond to letters on dimensional drawings.

NEMA 1 Small Hinged Wall Mount

Dimensions

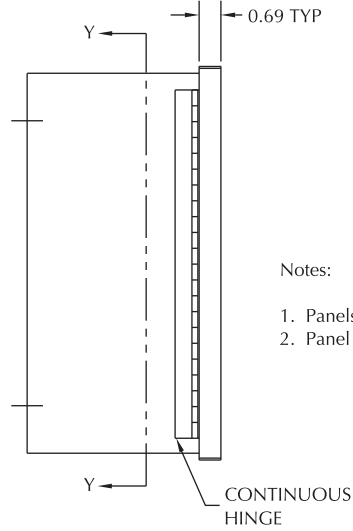
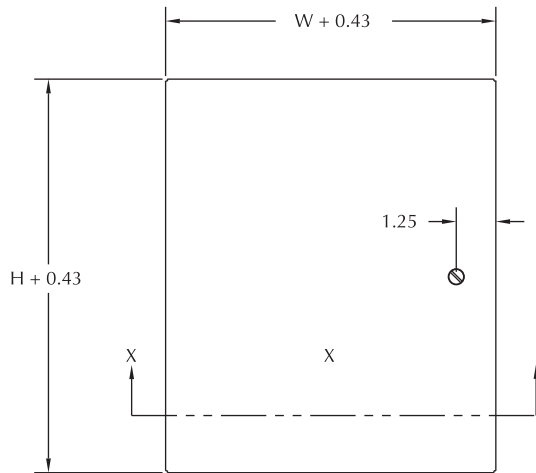

- Notes:
1. Panels are 14 Ga. steel.
 2. Panel screws are #10-32.

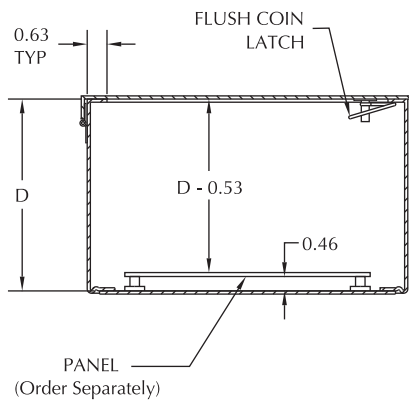

SECTION X-X

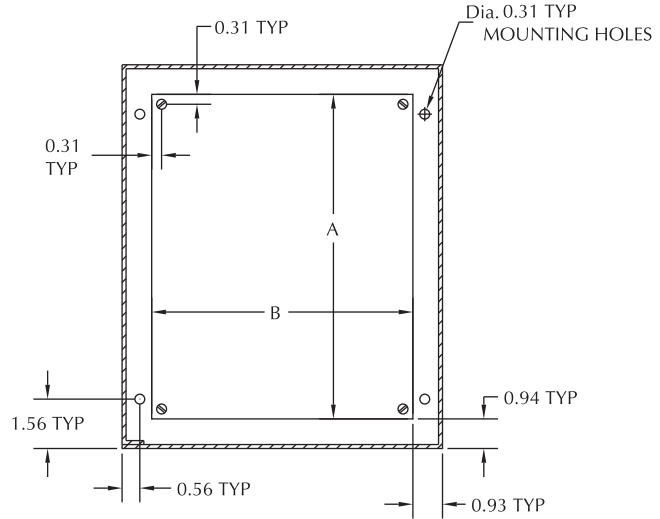

SECTION Y-Y

PLC Overview

DL05/06 PLC

DL105 PLC

DL205 PLC

DL305 PLC

DL405 PLC

Field I/O

Software

C-more HMIs

Other HMI

AC Drives

Motors

Steppers/ Servos

Motor Controls

Proximity Sensors

Photo Sensors

Limit Switches

Encoders

Current Sensors

Pushbuttons/ Lights

Process

Relays/ Timers

Comm.

TB's & Wiring

Power

Circuit Protection

Enclosures

Appendix

Part Index