

# NEMA 4 JIC Continuous-Hinge Wall Mount



## Application

Designed for use as instrument housings, electrical control enclosures, terminal wiring boxes or electrical junction boxes. Provides protection in areas that are hosed down, very wet, or in outdoor applications.

## Finish

- ANSI-61 gray polyester powder inside and out over phosphatized surfaces
- Optional subpanels are white polyester powder over phosphatized surfaces



## Construction

- Fabricated from 14 gauge carbon steel
- Continuously welded seams ground smooth, no holes or knockouts
- Closed cell oil-resistant neoprene gasket
- External mounting feet, top and bottom
- Weldnuts are provided on models 6 x 4 and larger to secure optional subpanel
- Continuous-hinge cover is secured on three sides with stainless steel screws and clamps to ensure a watertight seal
- Cover removable by pulling stainless steel hinge pin
- Grounding provisions provided
- Optional subpanels and terminal kits must be ordered separately

## Listings

- UL 50, Types 4, 12 and 13
- UL file E6924
- CSA Certified, Types 4 and 12
- CSA file LL66078
- Meets NEMA/EEMAC Types 4, 12 and 13 requirements
- JIC EL-1-71

Enclosure Shipping Schedule		
Same day	1 - 7 days	1 - 10 days
Color indicates shipping lead time in business days.		

Part Number	Price	Body/Door	Enclosure Size HxWxD	Subpanel P/N	Price	Subpanel Size AxB	Mtg CxE	Overall LxM	F	G	I	J	K	N	O	P	Q
<b>BN4040403CH</b>	<--->	14/14	4x4x3 (102x102x76)	<b>NA</b>	NA	NA	4.75x2 (121x51)	5.50x5 (140x127)	2.53 (64)	4.31 (109)	3 (76)	NA	1.38 (35)	1.38 (35)	2.53 (64)	4.31 (110)	1.78 (45)
<b>BN4060403CH</b>	<--->	14/14	6x4x3 (152x102x76)	<b>P0604</b>	<--->	4.88x2.88 (124x73)	6.75x2 (171x51)	7.50x5 (191x127)	2.53 (64)	4.31 (109)	3 (76)	0.56 (14)	1.38 (35)	2.38 (60)	2.53 (64)	6.31 (160)	1.78 (45)
<b>BN4060604CH</b>	<--->	14/14	6x6x4 (152x152x102)	<b>P0606</b>	<--->	4.88x4.88 (124x124)	6.75x4 (171x102)	7.50x7 (191x178)	3.53 (90)	6.31 (160)	5 (127)	0.56 (14)	2.38 (60)	2.38 (60)	3.53 (90)	6.31 (160)	2.78 (71)
<b>BN4080603CH</b>	<--->	14/14	8x6x3.50 (203x152x89)	<b>P0806</b>	<--->	6.88x4.88 (175x124)	8.75x4 (222x102)	9.50x7 (241x178)	3.03 (77)	6.31 (160)	5 (127)	0.56 (14)	2.38 (60)	3.38 (86)	3.03 (77)	8.31 (211)	2.28 (58)
<b>BN4100804CH</b>	<--->	14/14	10x8x4 (254x203x102)	<b>P1008</b>	<--->	8.88x6.88 (226x175)	10.75x6 (273x152)	11.50x9 (292x229)	3.53 (90)	8.31 (211)	7 (178)	0.56 (14)	3.38 (86)	1.50 (38)	3.53 (90)	10.31 (262)	2.78 (71)
<b>BN4100806CH</b>	<--->	14/14	10x8x6 (254x203x152)	<b>P1008</b>	<--->	8.88x6.88 (226x175)	10.75x6 (273x152)	11.50x9 (292x229)	5.53 (141)	8.31 (211)	7 (178)	0.56 (14)	3.38 (86)	1.50 (38)	5.53 (141)	10.31 (262)	4.78 (121)
<b>BN4121005CH</b>	<--->	14/14	12x10x5 (305x254x127)	<b>P1210</b>	<--->	10.88x8.88 (276x226)	12.75x8 (324x203)	13->11 (343x279)	4.53 (115)	10.31 (262)	9 (229)	0.56 (14)	2 (51)	3 (76)	4.53 (115)	12.31 (313)	3.78 (96)
<b>BN4121206CH</b>	<--->	14/14	12x12x6 (305x305x152)	<b>P1212</b>	<--->	10.88x10.88 (276x276)	12.75x10 (324x254)	13.50x13 (343x330)	5.53 (141)	12.31 (313)	11 (279)	0.56 (14)	2.50 (64)	2.50 (64)	5.53 (141)	12.31 (313)	4.78 (121)
<b>BN4141206CH</b>	<--->	14/14	14x12x6 (356x305x152)	<b>P1412</b>	<--->	12.88x10.88 (327x276)	14.75x10 (375x254)	15.50x13 (394x330)	5.53 (141)	12.31 (313)	11 (279)	0.56 (14)	2 (51)	3 (76)	5.53 (141)	14.31 (364)	4.78 (121)
<b>BN4161406CH</b>	<--->	14/14	16x14x6 (406x356x152)	<b>P1614</b>	<--->	14.88x12.88 (378x327)	16.75x12 (425x305)	17.50x15 (445x381)	5.53 (141)	14.31 (363)	13 (330)	0.56 (14)	3.50 (89)	1.50 (38)	5.53 (141)	16.31 (414)	4.78 (121)

Note: Subpanels must be ordered separately. Dimensions in inches (millimeters); letters in table correspond to letters on dimensional drawings.

# NEMA 4 JIC Continuous-Hinge Wall Mount

## Dimensions

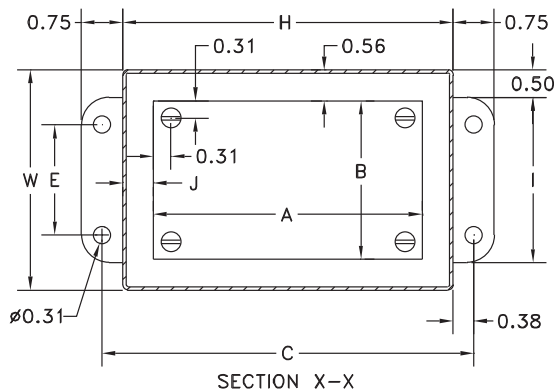
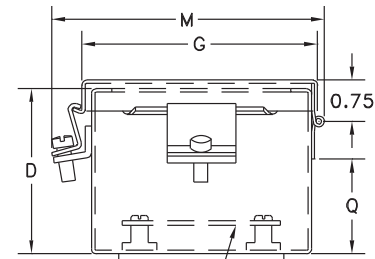
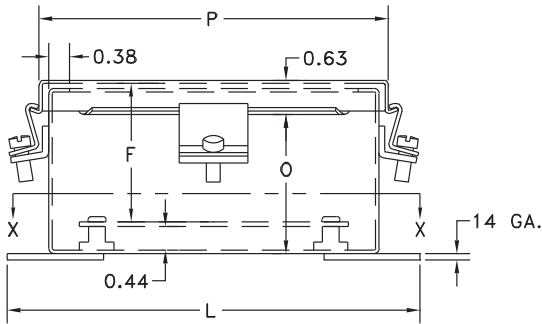

Subpanels (order separately)

### Notes:

1. Subpanels are 14 gauge steel.
2. Subpanel screws are #10-32 pan head.

### CLAMP BRACKET LOCATIONS

