

# NEMA 4X Stainless Steel JIC Continuous-Hinge Wall Mount



## Application

Provides unmatched protection for housing electrical components in highly corrosive environments. This enclosure is used for indoor and outdoor settings that are frequently wet or have constant exposure to water, other liquids, or contaminants.

- Stainless steel screws and clamps on three sides of cover assure watertight seal
- Door removed by pulling stainless steel continuous hinge pin
- Grounding provisions provided
- Optional subpanels and terminal kits must be ordered separately

## Construction

- Fabricated from 16 gauge type 304 stainless steel
- Continuously welded seams ground smooth, less knockouts or holes
- Closed cell oil-resistant neoprene gasket
- External mounting feet
- Weldnuts are provided for mounting optional subpanels securely on models 6 x 4 and larger

## Finish

- Cover and outside of enclosure have a smooth grained finish
- Optional subpanels are white polyester powder over phosphatized surfaces or grained finish stainless steel

## Listings

- UL 50 Listed, Types 4, 4X, 12 and 13
- UL file E6924
- CSA Certified, Types 4 and 12
- CSA file LL66078
- Meets NEMA/EEMAC Types 4, 4X, 12 and 13 requirements
- JIC EL-1-71

Enclosure Shipping Schedule		
Same day	1 - 7 days	1 - 10 days
Color indicates shipping lead time in business days.		

Part Number	Price	Body/Door	Enclosure Size HxWxD	Subpanel P/N	Price	Subpanel Size AxB	Mtg CxE	Overall LxM	F	G	I	J	K	N	O	P	Q
<b>BN4060404CHSS</b>	<--->	16/16	6x4x4 (152x102x102)	<b>P0604</b>	<--->	4.88x2.88 (124x73)	6.75x2 (171x51)	7.50x5 (191x127)	3.53 (90)	4.31 (109)	3 (76)	0.56 (14)	1.38 (35)	2.38 (60)	3.53 (90)	6.31 (160)	2.78 (71)
<b>BN4060604CHSS</b>	<--->	16/16	6x6x4 (152x152x102)	<b>P0606</b>	<--->	4.88x4.88 (124x124)	6.75x4 (171x102)	7.50x7 (191x178)	3.53 (90)	6.31 (160)	5 (127)	0.56 (14)	2.38 (60)	2.38 (60)	3.53 (90)	6.31 (160)	2.78 (71)
<b>BN4080604CHSS</b>	<--->	16/16	8x6x4 (203x152x102)	<b>P0806</b>	<--->	6.88x4.88 (175x124)	8.75x4 (222x102)	9.50x7 (241x178)	3.53 (90)	6.31 (160)	5 (127)	0.56 (14)	2.38 (60)	3.38 (86)	3.53 (90)	8.31 (211)	2.78 (71)
<b>BN4100804CHSS</b>	<--->	16/16	10x8x4 (254x203x102)	<b>P1008</b>	<--->	8.88x6.88 (226x175)	10.75x6 (273x152)	11.50x9 (292x229)	3.53 (90)	8.31 (211)	7 (178)	0.56 (14)	3.38 (86)	1.50 (38)	3.53 (90)	10.31 (262)	2.78 (71)
<b>BN4121006CHSS</b>	<--->	16/16	12x10x6 (305x254x152)	<b>P1210</b>	<--->	10.88x8.88 (276x226)	12.75x8 (324x203)	13.50x11 (343x279)	5.53 (141)	10.31 (262)	9 (229)	0.56 (14)	2 (51)	3 (76)	5.53 (141)	12.31 (313)	4.78 (121)
<b>BN4121206CHSS</b>	<--->	16/16	12x12x6 (305x305x152)	<b>P1212</b>	<--->	10.88x10.88 (276x276)	12.75x10 (324x254)	13.50x13 (343x330)	5.53 (141)	12.31 (313)	11 (279)	0.56 (14)	2.50 (64)	2.50 (64)	5.53 (141)	12.31 (313)	4.78 (121)
<b>BN4141206CHSS</b>	<--->	16/16	14x12x6 (356x305x152)	<b>P1412</b>	<--->	12.88x10.88 (327x276)	14.75x10 (375x254)	15.50x13 (394x330)	5.53 (141)	12.31 (313)	11 (279)	0.56 (14)	2 (51)	3 (76)	5.53 (141)	14.31 (364)	4.78 (121)
<b>BN4161406CHSS</b>	<--->	16/16	16x14x6 (406x356x152)	<b>P1614</b>	<--->	14.88x12.88 (378x327)	16.75x12 (425x305)	17.50x15 (445x381)	5.53 (141)	14.31 (363)	13 (330)	0.56 (14)	3.50 (89)	1.50 (38)	5.53 (141)	16.31 (414)	4.78 (121)

Note: Subpanels must be ordered separately. Dimensions in inches (millimeters); letters in table correspond to letters on dimensional drawings.

# NEMA 4X Stainless Steel JIC Continuous-Hinge Wall Mount

## Dimensions

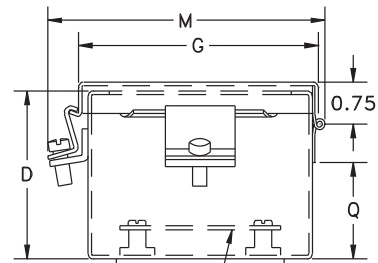
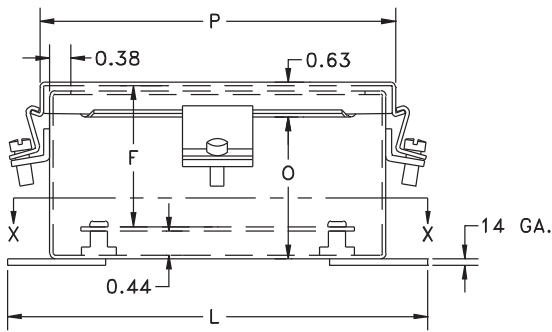

Subpanel (order separate)

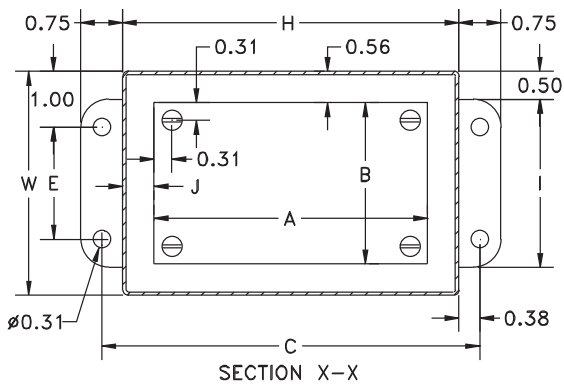

Notes:

1. Subpanels are 14 gauge steel.
2. Subpanel screws are #10-32 pan head.

### CLAMP BRACKET LOCATIONS

