

NITRA aluminum manifolds are available in two variations. Round manifolds have one 3/8" NPT input and either two or three 1/4" NPT outputs. Rectangular manifolds have 1/2" NPT inputs on either end and either three or five 1/4" NPT outputs.

- Maximum input pressure = Up to 500 psi



MYA-3



MLA-5

NITRA™ Pneumatic Manifolds				
Part No.	Price	Description	Parts Per Pkg	Weight
MYA-2	<-->	Pneumatic aluminum manifold, round, 3/8 inch female NPT inlet, two 1/4 inch female NPT outlets	1	0.2
MYA-3	<-->	Pneumatic aluminum manifold, round, 3/8 inch female NPT inlet, three 1/4 inch female NPT outlets	1	0.2
MLA-3	<-->	Pneumatic aluminum manifold, rectangular, 1/2 inch female NPT inlet, three 1/4 inch female NPT outlets	1	0.9
MLA-5	<-->	Pneumatic aluminum manifold, rectangular, 1/2 inch female NPT inlet, five 1/4 inch female NPT outlets	1	1.4

## Dimensions

Inches [mm]

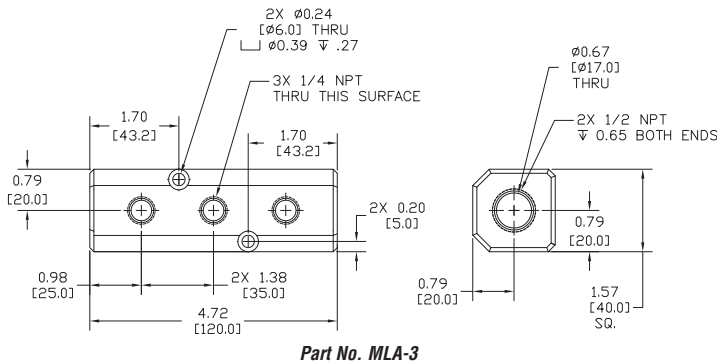

Part No. MLA-3

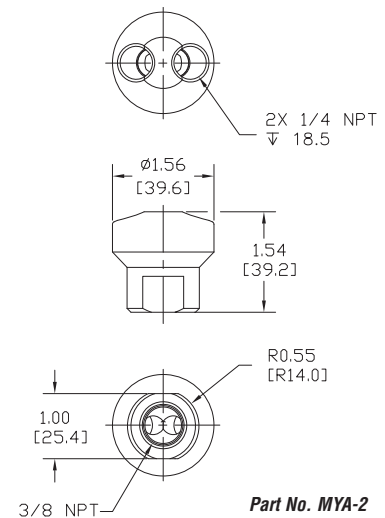

Part No. MYA-2

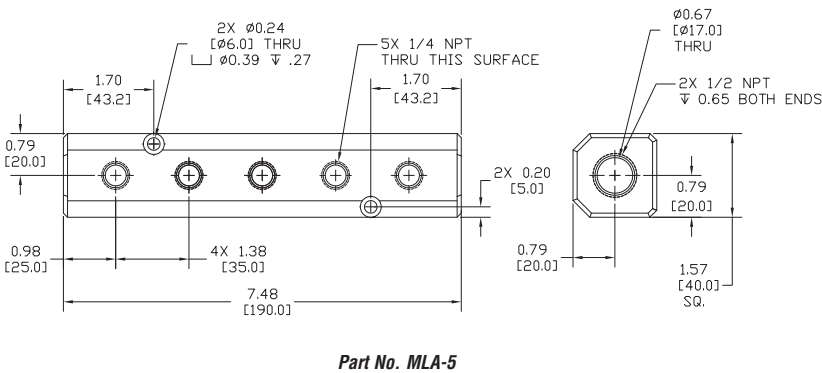

Part No. MLA-5

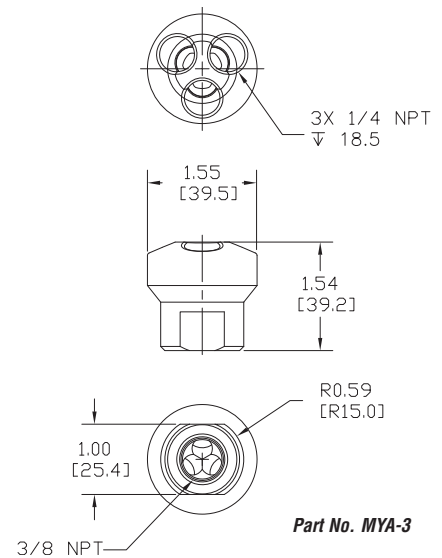

Part No. MYA-3