

Polyurethane Pneumatic Tubing

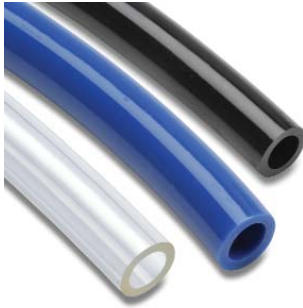

NITRA™ Polyurethane (PUR) tubing is made from the highest quality, 100% virgin raw materials available and has a hardness specification of Shore A 98. It is ether based to provide excellent hydrolysis, oil and cold resistance. NITRA Polyurethane tubing is strong, flexible, and offers superior kink resistance compared to other tubing. With its extremely tight outside diameter tolerance, NITRA Polyurethane tubing is ideal for use with NITRA push-to-connect fittings.

Features

- Inch and metric sizes available
- Three colors - black, blue and clear
- 100 foot and 500 foot package sizes
- Shore A 98 hardness
- Strong, flexible and kink resistant
- Made in USA

Polyurethane 5/32 in. (4mm) Tubing Specifications

Outside Diameter (in.)	0.156	Working Pressure (psi) @ 70° F	200	Temp. Range	-40°F to +160°F (-40°C to +71°C)
Inside Diameter (in.)	0.093	Burst Pressure (psi)	600	Hardness	Shore A 98
Wall Thickness (in.)	0.031	Vacuum Rating	To 28" Hg	Bend Radius (in.)	0.250
Part Number	Price	Size	Color	PKG/Reel Length (feet)	PKG WT (lbs)
PU532BLK100	<-->	5/32 in. (4 mm)	Black	100 ft. Package	1.0
PU532BLK500	<-->	5/32 in. (4 mm)	Black	500 ft. Reel	4.0
PU532BLU100	<-->	5/32 in. (4 mm)	Blue	100 ft. Package	1.0
PU532BLU500	<-->	5/32 in. (4 mm)	Blue	500 ft. Reel	4.0
PU532CLR100	<-->	5/32 in. (4 mm)	Clear	100 ft. Package	1.0
PU532CLR500	<-->	5/32 in. (4 mm)	Clear	500 ft. Reel	4.0

Polyurethane 1/4 in. Tubing Specifications

Outside Diameter (in.)	0.250	Working Pressure (psi) @ 70° F	180	Temp. Range	-40°F to +160°F (-40°C to +71°C)
Inside Diameter (in.)	0.156	Burst Pressure (psi)	540	Hardness	Shore A 98
Wall Thickness (in.)	0.047	Vacuum Rating	To 28" Hg	Bend Radius (in.)	0.476
Part Number	Price	Size	Color	PKG/Reel Length (feet)	PKG WT (lbs)
PU14BLK100	<-->	1/4 in.	Black	100 ft. Package	2.0
PU14BLK500	<-->	1/4 in.	Black	500 ft. Reel	8.0
PU14BLU100	<-->	1/4 in.	Blue	100 ft. Package	2.0
PU14BLU500	<-->	1/4 in.	Blue	500 ft. Reel	8.0
PU14CLR100	<-->	1/4 in.	Clear	100 ft. Package	2.0
PU14CLR500	<-->	1/4 in.	Clear	500 ft. Reel	8.0

Polyurethane 3/8 in. Tubing Specifications

Outside Diameter (in.)	0.375	Working Pressure (psi) @ 70° F	150	Temp. Range	-40°F to +160°F (-40°C to +71°C)
Inside Diameter (in.)	0.250	Burst Pressure (psi)	450	Hardness	Shore A 98
Wall Thickness (in.)	0.063	Vacuum Rating	To 28" Hg	Bend Radius (in.)	1.00
Part Number	Price	Size	Color	PKG/Reel Length (feet)	PKG WT (lbs)
PU38BLK100	<-->	3/8 in.	Black	100 ft. Package	3.0
PU38BLK500	<-->	3/8 in.	Black	500 ft. Reel	16.0
PU38BLU100	<-->	3/8 in.	Blue	100 ft. Package	3.0
PU38BLU500	<-->	3/8 in.	Blue	500 ft. Reel	16.0
PU38CLR100	<-->	3/8 in.	Clear	100 ft. Package	3.0
PU38CLR500	<-->	3/8 in.	Clear	500 ft. Reel	16.0

Polyurethane 1/2 in. Tubing Specifications					
Outside Diameter (in.)	0.500	Working Pressure (psi) @ 70° F	150	Temp. Range	-40°F to +160°F (-40°C to +71°C)
Inside Diameter (in.)	0.328	Burst Pressure (psi)	450	Hardness	Shore A 98
Wall Thickness (in.)	0.086	Vacuum Rating	To 28" Hg	Bend Radius (in.)	1.102
Part Number	Price	Size	Color	PKG/Reel Length (feet)	PKG WT (lbs)
PU12BLK100	<--->	1/2 in.	Black	100 ft. Package	6.0
PU12BLK500	<--->	1/2 in.	Black	500 ft. Reel	29.0
PU12BLU100	<--->	1/2 in.	Blue	100 ft. Package	6.0
PU12BLU500	<--->	1/2 in.	Blue	500 ft. Reel	29.0
PU12CLR100	<--->	1/2 in.	Clear	100 ft. Package	6.0
PU12CLR500	<--->	1/2 in.	Clear	500 ft. Reel	29.0

Polyurethane 6 mm Tubing Specifications					
Outside Diameter (mm)	6.0	Working Pressure (psi) @ 70° F	180	Temp. Range	-40°F to +160°F (-40°C to +71°C)
Inside Diameter (mm)	4.0	Burst Pressure (psi)	540	Hardness	Shore A 98
Wall Thickness (mm)	1.0	Vacuum Rating	To 28" Hg	Bend Radius (mm)	12
Part Number	Price	Size	Color	PKG/Reel Length (feet)	PKG WT (lbs)
PU6MBLK100	<--->	6 mm	Black	100 ft. Package	2.0
PU6MBLK500	<--->	6 mm	Black	500 ft. Reel	7.0
PU6MBLU100	<--->	6 mm	Blue	100 ft. Package	2.0
PU6MBLU500	<--->	6 mm	Blue	500 ft. Reel	7.0
PU6MCLR100	<--->	6 mm	Clear	100 ft. Package	2.0
PU6MCLR500	<--->	6 mm	Clear	500 ft. Reel	7.0

Polyurethane 8 mm Tubing Specifications					
Outside Diameter (mm)	8.0	Working Pressure (psi) @ 70° F	175	Temp. Range	-40°F to +160°F (-40°C to +71°C)
Inside Diameter (mm)	5.0	Burst Pressure (psi)	525	Hardness	Shore A 98
Wall Thickness (mm)	1.5	Vacuum Rating	To 28" Hg	Bend Radius (mm)	15
Part Number	Price	Size	Color	PKG/Reel Length (feet)	PKG WT (lbs)
PU8MBLK100	<--->	8 mm	Black	100 ft. Package	3.0
PU8MBLK500	<--->	8 mm	Black	500 ft. Reel	12.0
PU8MBLU100	<--->	8 mm	Blue	100 ft. Package	3.0
PU8MBLU500	<--->	8 mm	Blue	500 ft. Reel	12.0
PU8MCLR100	<--->	8 mm	Clear	100 ft. Package	3.0
PU8MCLR500	<--->	8 mm	Clear	500 ft. Reel	12.0

Polyurethane 10 mm Tubing Specifications					
Outside Diameter (mm)	10.0	Working Pressure (psi) @ 70° F	150	Temp. Range	-40°F to +160°F (-40°C to +71°C)
Inside Diameter (mm)	6.5	Burst Pressure (psi)	450	Hardness	Shore A 98
Wall Thickness (mm)	1.75	Vacuum Rating	To 28" Hg	Bend Radius (mm)	25
Part Number	Price	Size	Color	PKG/Reel Length (feet)	PKG WT (lbs)
PU10MBLK100	<--->	10 mm	Black	100 ft. Package	4.0
PU10MBLK500	<--->	10 mm	Black	500 ft. Reel	18.0
PU10MBLU100	<--->	10 mm	Blue	100 ft. Package	4.0
PU10MBLU500	<--->	10 mm	Blue	500 ft. Reel	18.0
PU10MCLR100	<--->	10 mm	Clear	100 ft. Package	4.0
PU10MCLR500	<--->	10 mm	Clear	500 ft. Reel	18.0

Polyurethane 12 mm Tubing Specifications					
Outside Diameter (mm)	12.0	Working Pressure (psi) @ 70° F	150	Temp. Range	-40°F to +160°F (-40°C to +71°C)
Inside Diameter (mm)	8.0	Burst Pressure (psi)	450	Hardness	Shore A 98
Wall Thickness (mm)	2.0	Vacuum Rating	To 28" Hg	Bend Radius (mm)	28
Part Number	Price	Size	Color	PKG/Reel Length (feet)	PKG WT (lbs)
PU12MBLK100	<--->	12 mm	Black	100 ft. Package	5.0
PU12MBLK500	<--->	12 mm	Black	500 ft. Reel	24.0
PU12MBLU100	<--->	12 mm	Blue	100 ft. Package	5.0
PU12MBLU500	<--->	12 mm	Blue	500 ft. Reel	24.0
PU12MCLR100	<--->	12 mm	Clear	100 ft. Package	5.0
PU12MCLR500	<--->	12 mm	Clear	500 ft. Reel	24.0

NITRA Pneumatic Tubing Accessories

Pneumatic Tubing Cutter				
Part Number	Description	Pcs/Pkg	Wt (lb)	Price
TC-12	NITRA pneumatic tubing cutter for use with 1/8 to 1/2 inch and 4 to 12 mm outside diameter flexible plastic tubing.	1	0.1	<--->



TC-12



Pneumatic Fitting Instructions and Caution Information

Assembly Instructions:



Prepare the NITRA™ tubing for cutting and make sure to have the proper tubing cutters like the NITRA TC-12.



Cut the NITRA tubing at a right angle with the axis using a standard tube cutter. After cutting the tubing, make sure to check the cut end for an even cut with no debris.

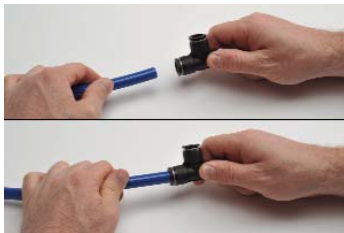

Insertion of the NITRA tubing into fittings

- Make sure the tube is inserted fully into the fitting.
- Pull the tube gently to make sure it does not release.
- If the tube end is damaged or deformed leakage or unexpected tube release may occur. Make sure to check tubing end thoroughly.



Removing the NITRA tubing from fittings

- Make sure the pressure in the tube is zero before releasing the tube from the fittings
- To release the tubing, press the release ring at the end of the fitting and pull the tube with one hand.
- Inspect the released tube end and make a clean cut if it is damaged or deformed.

Common Precautions for Tubing and Fitting Products

Warnings:

- Do not use fittings with media other than air.
- Avoid installing with tubing under tension or with excessive bends.
- Do not use the product where weld spatters occur as fire may occur.
- Product damage or air leakage may occur at places where there is excessive rotation or vibration of the fittings.
- Use caution in water as the product may be damaged by surge pressure.
- Do not use the product where it is directly exposed to fluids such as cutting oil, lubricating oil, and coolant oil.

Cautions:

- Assemble the tubing only after cleaning away impurities such as dust and excess debris.
- Fitting products are recommended for air systems only. Avoid using for other purposes.
- When using tubing other than NITRA brand with NITRA fittings, be sure the tubing OD conforms to the tolerances in Table 1 below.

Table 1 - Tolerance of the Outer Diameter of the Tube

Tube Specifications	ø5/32 [ø4]	ø1/4 [ø6]	ø5/16 [ø8]	ø3/8 [ø10]	ø1/2 [ø12]
Permissible tolerance	+ 0.15/-0.1 [+/- 0.1]	+/- 0.1 [+/- 0.1]	+ 0.2/- 0.1 [+/- 0.1]	+/- 0.15 [+/- 0.15]	+/- 0.15 [+/- 0.15]

Note: Dimensions shown inches [mm]

Pneumatic Tubing Cutter		
Part No.	Description	Price
TC-12	Tubing cutter, 1/8-1/2 in, 4-12mm	<--->