

# Sockets for QL/QM Series Relays

**SQL08D**



Din-rail mounting, DPDT, for use with QL2 series relays

<--->

**SQL14D**



Din-rail mounting, 4PDT, for use with QL4 series relays

<--->

**SQM08D**



Din-rail mounting, DPDT, for use with QM2 series relays

<--->

**SQM14D**



Din-rail mounting, 4PDT, for use with QM4 series relays

<--->

## Holding Clips

Holding clips for the QL2, QL4, QM2 and QM4 series relays can be removed by pushing the side of the inserting hole with a sharp object.

**Note:** Order sockets separately; holding clips are included with sockets.

### Holding Clip Dimensions mm [in]

Holding clip for QL4 series relays is included with SQL14D sockets.

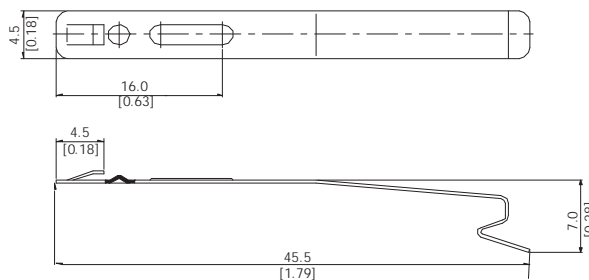

Insert holding clip into the slots provided on the socket.

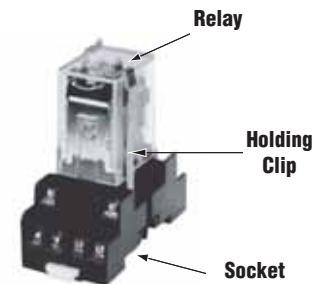

### Holding Clip Dimensions mm [in]

Holding clip for QL2, QM2 and QM4 series relays is included with SQL08D, SQM08D and SQM14D sockets.

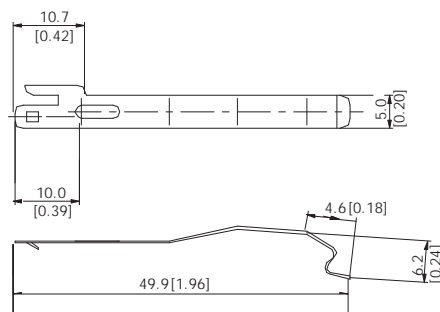

# Socket Dimensions for QL/QM Series Relays



- Company Information
- Systems Overview
- Programmable Controllers
- Field I/O
- Software
- C-more & other HMI
- Drives
- Soft Starters
- Motors & Gearbox
- Steppers/ Servos
- Motor Controls
- Proximity Sensors
- Photo Sensors
- Limit Switches
- Encoders
- Current Sensors
- Pressure Sensors
- Temperature Sensors
- Pushbuttons/ Lights
- Process
- Relays/ Timers**
- Comm.
- Terminal Blocks & Wiring
- Power
- Circuit Protection
- Enclosures
- Tools
- Pneumatics
- Safety
- Appendix
- Product Index
- Part # Index

## Dimensions

mm

**Figure 3**  
**SQL08D (for QL2 Series Relays)**

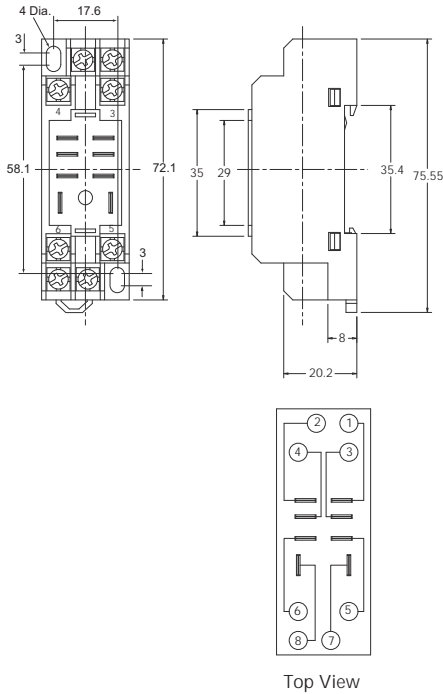

**Figure 4**  
**SQL14D (for QL4 Series Relays)**

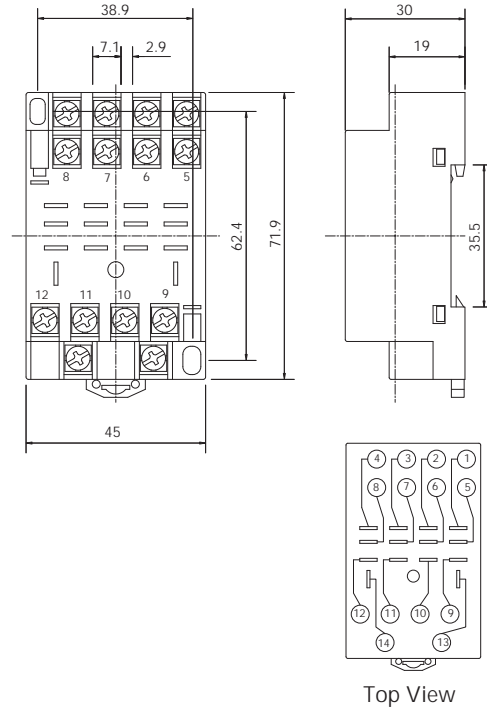

**Figure 5**  
**SQM08D (for QM2 Series Relays)**

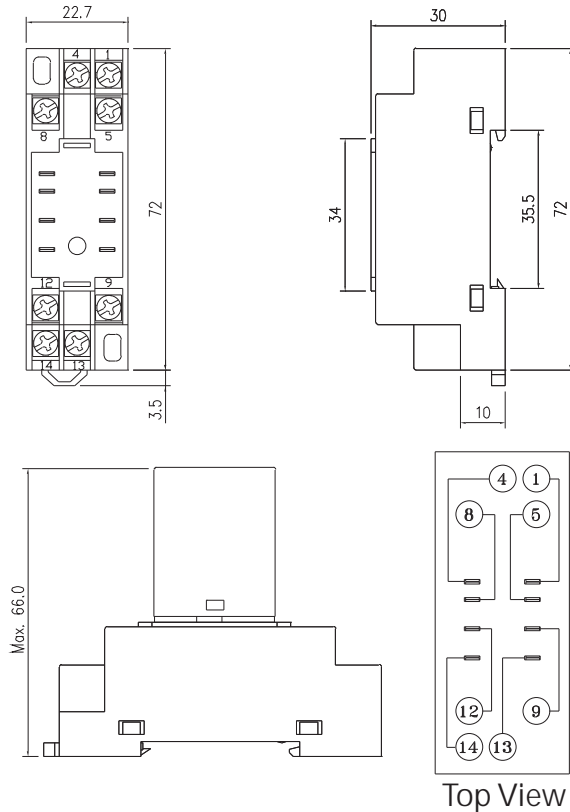

**Figure 6**  
**SQM14D (for QM4 Series Relays)**

